





LEGEND

-  WORK AREA
-  PAVEMENT CONSTRUCTED IN STAGE
-  PAVEMENT CONSTRUCTED IN PREVIOUS STAGE
-  TEMPORARY PAVEMENT
-  HMA DRIVEWAY PAVEMENT, 4"

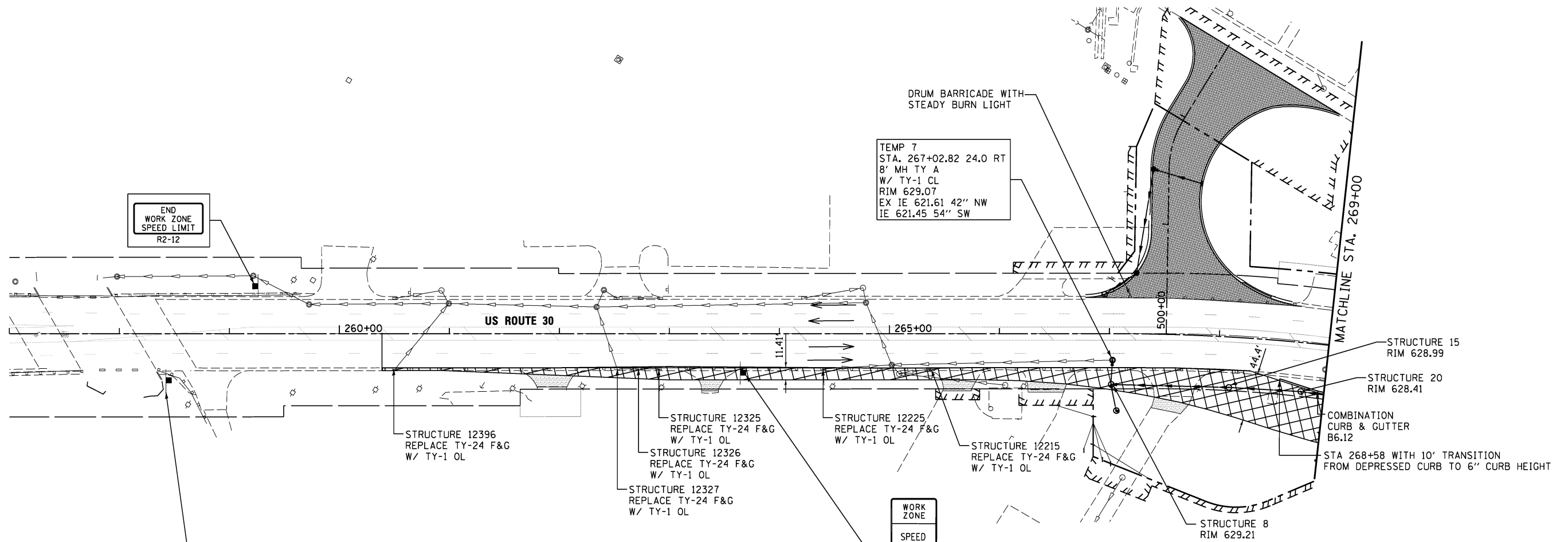
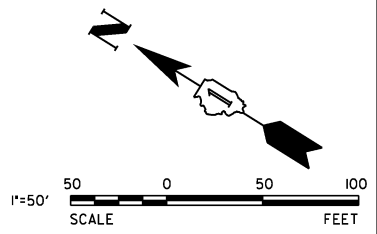

END
WORK ZONE
SPEED LIMIT
R2-12

TEMP 7
STA. 267+02.82 24.0 RT
8' MH TY A
W/ TY-1 CL
RIM 629.07
EX IE 621.61 42" NW
IE 621.45 54" SW

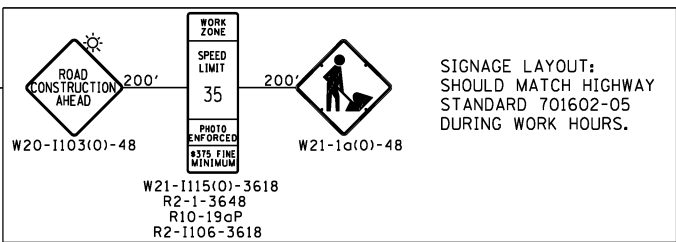

WORK ZONE
SPEED LIMIT
35
PHOTO ENFORCED
\$375 FINE MINIMUM

W21-1115(O)-3618
R2-1-3648
R10-19oP
R2-1106-3618

- NOTES:**
1. CONTRACTOR IS TO USE DAILY LANE CLOSURE TO CONSTRUCT TEMPORARY PAVEMENT AND MOST OF THE ADVANCED STORM SEWER. THE CONTRACTOR SHALL USE HIGHWAY STANDARD 701602
 2. CONTRACTOR TO REMOVE ALL CONFLICTING SIGNS BEFORE INSTALLING CONSTRUCTION SIGNS.
 3. DRUMS WITH STEADY BURN MONO-DIRECTIONAL LIGHT SHALL USE 50' C-C IN TYPICAL SECTIONS, 25' C-C IN CURVES AND RADII AND 20' C-C IN TAPERS.

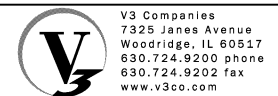

USER NAME = hshsh	DESIGNED - DTE	REVISED -
PLOT SCALE = 50.0000' / in.	DRAWN - DRP	REVISED -
PLOT DATE = 8/21/2013	CHECKED - VJD	REVISED -
	DATE - 08/14/2013	REVISED -

**STATE OF ILLINOIS
DEPARTMENT OF TRANSPORTATION**

**MAINTENANCE OF TRAFFIC - PRE STAGE 1A
STATION 257+00 TO STATION 269+00**

SCALE: 1" = 50' SHEET NO. 1 OF 6 SHEETS STA. 257+00 TO STA. 269+00

F.A.P. RTE.	SECTION	COUNTY	TOTAL SHEETS	SHEET NO.
353	11-Y-A	COOK	354	46
CONTRACT NO. 60R19				
ILLINOIS FED. AID PROJECT				