





LEGEND

-  WORK AREA
-  PAVEMENT CONSTRUCTED IN STAGE
-  PAVEMENT CONSTRUCTED IN PREVIOUS STAGE
-  TEMPORARY PAVEMENT

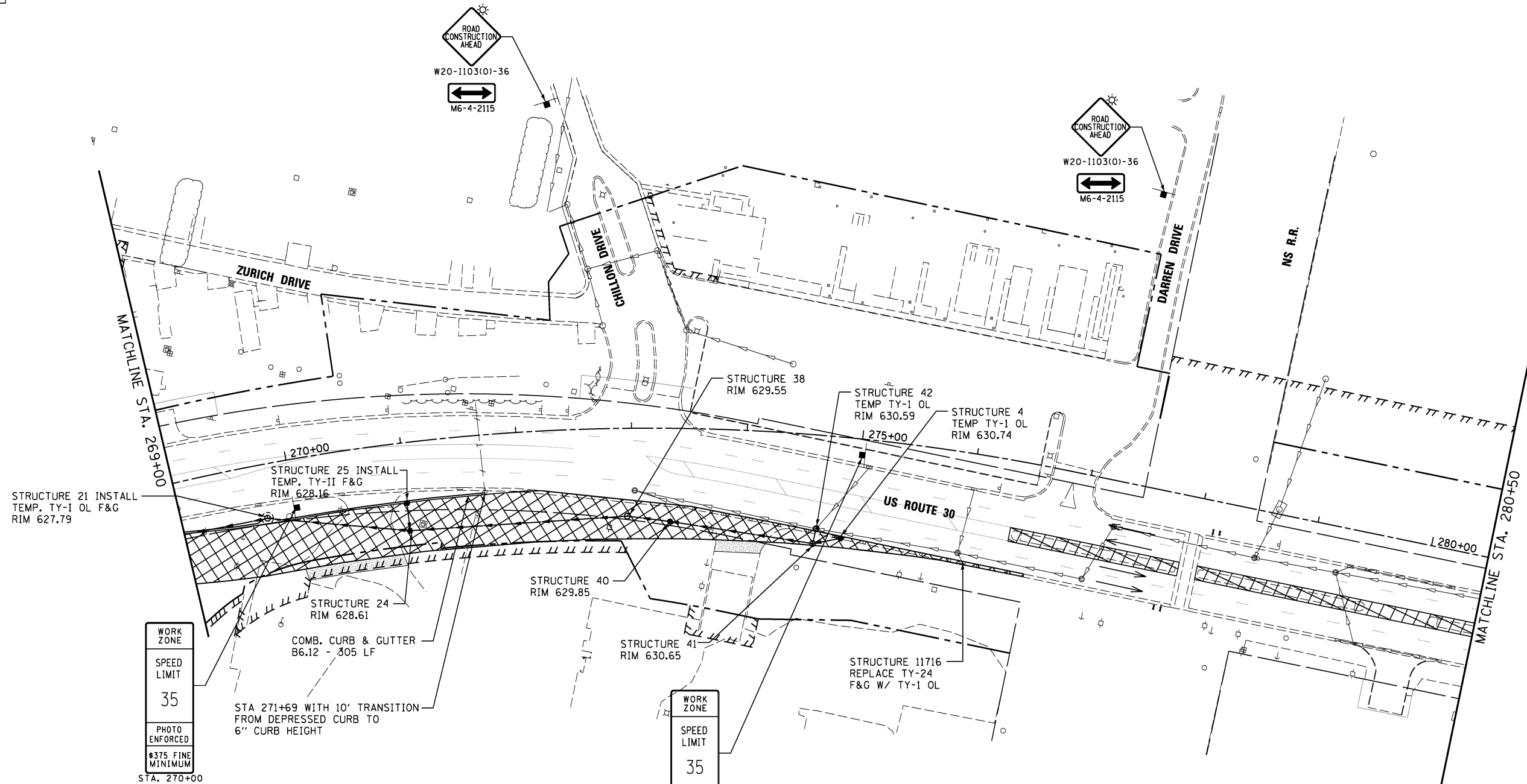
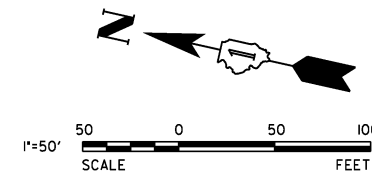

WORK ZONE
SPEED LIMIT
35
PHOTO ENFORCED
\$375 FINE MINIMUM
STA. 270+00
W21-1115(0)-3618
R2-1-3648
R10-19aP-3618
R2-1106-3618

WORK ZONE
SPEED LIMIT
35
PHOTO ENFORCED
\$375 FINE MINIMUM
STA. 275+00
W21-1115(0)-3618
R2-1-3648
R10-19aP-3618
R2-1106-3618

- NOTES:
- CONTRACTOR IS TO USE DAILY LANE CLOSURE TO CONSTRUCT TEMPORARY PAVEMENT AND MOST OF THE ADVANCED STORM SEWER. THE CONTRACTOR SHALL USE HIGHWAY STANDARD 701602
 - CONTRACTOR TO REMOVE ALL CONFLICTING SIGNS BEFORE INSTALLING CONSTRUCTION SIGNS.
 - DRUMS WITH STEADY BURN MONO-DIRECTIONAL LIGHT SHALL USE 50' C-C IN TYPICAL SECTIONS, 25' C-C IN CURVES AND RADII AND 20' C-C IN TAPERS.

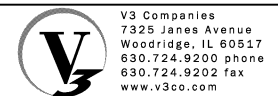

USER NAME = hshsh
DESIGNED - DTE
DRAWN - DRP
CHECKED - VJD
DATE - 08/14/2013
PLOT SCALE = 50.0000' / in.
PLOT DATE = 8/21/2013

REVISED -
REVISED -
REVISED -
REVISED -

STATE OF ILLINOIS
DEPARTMENT OF TRANSPORTATION

MAINTENANCE OF TRAFFIC - PRE STAGE 1A
STATION 269+00 TO STATION 280+50
SCALE: 1" = 50'
SHEET NO. 2 OF 6 SHEETS
STA. 269+00 TO STA. 280+50

F.A.P. RTE.	SECTION	COUNTY	TOTAL SHEETS	SHEET NO.
353	11-Y-A	COOK	354	47
CONTRACT NO. 60R19				
ILLINOIS FED. AID PROJECT				