





**LEGEND**

-  WORK AREA
-  PAVEMENT CONSTRUCTED IN STAGE
-  PAVEMENT CONSTRUCTED IN PREVIOUS STAGE
-  TEMPORARY PAVEMENT
-  DRUM OR TYPE II BARRICADE WITH STEADY BURN MONO-DIRECTIONAL LIGHTS

NOTE:  
FRONTAGE ROAD TO BE BUILT IN SECTIONS TO ALLOW ACCESS TO BUSINESSES. THE FRONTAGE ROAD SHOULD BE COMPLETED IN THIS STAGE.

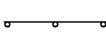
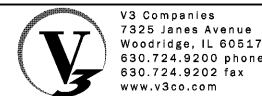
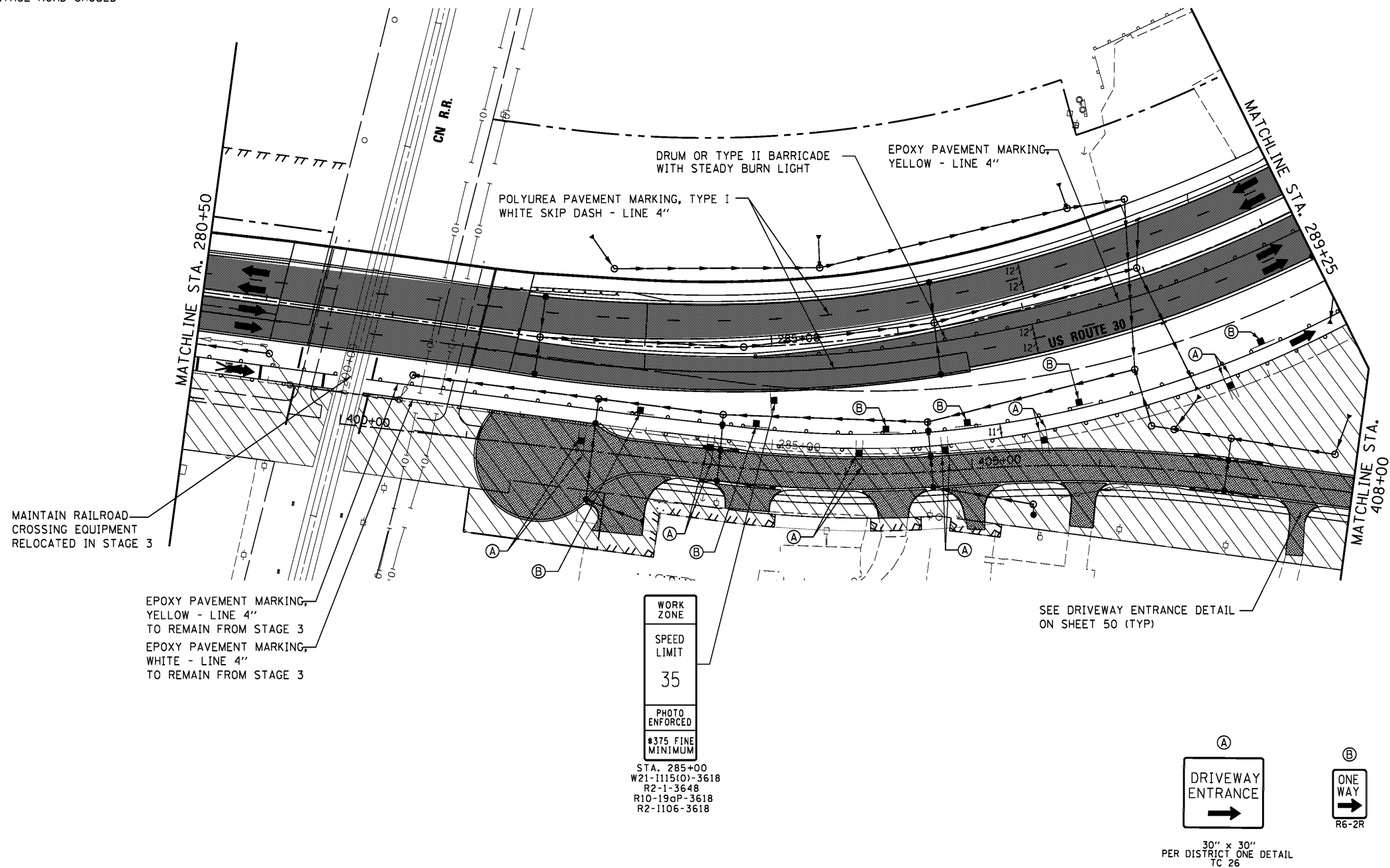
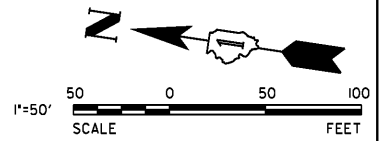

USER NAME = dsherman	DESIGNED - DTE	REVISED -
PLOT SCALE = 5/8"	DRAWN - DRP	REVISED -
PLOT DATE = 1/31/2014	CHECKED - VJD	REVISED -
	DATE - 01/31/2014	REVISED -

**STATE OF ILLINOIS  
DEPARTMENT OF TRANSPORTATION**

<b>MAINTENANCE OF TRAFFIC - STAGE 4a</b>		
<b>STATION 280+50 TO STATION 289+25</b>		
SCALE: 1" = 50'	SHEET NO. 3 OF 5 SHEETS	STA. 280+50 TO STA. 289+25

F.A.P. RTE.	SECTION	COUNTY	TOTAL SHEETS	SHEET NO.
353	11-Y-A	COOK	354	65
CONTRACT NO. 60R19				
ILLINOIS FED. AID PROJECT				