

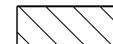



**LEGEND**

-  WORK AREA
-  PAVEMENT CONSTRUCTED IN STAGE
-  PAVEMENT CONSTRUCTED IN PREVIOUS STAGE
-  TEMPORARY PAVEMENT
-  DRUM OR TYPE II BARRICADE WITH STEADY BURN MONO-DIRECTIONAL LIGHTS

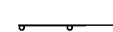
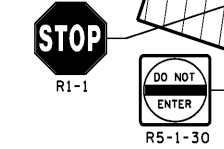
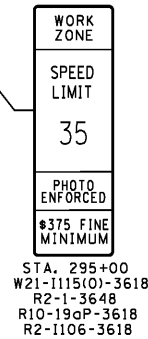
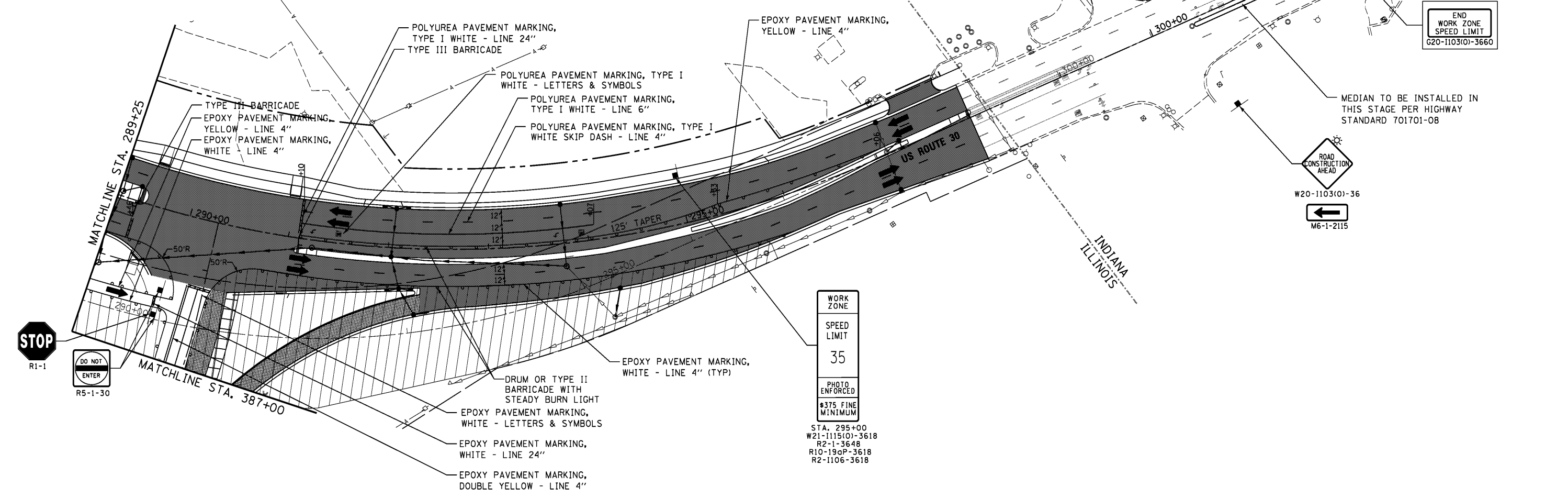
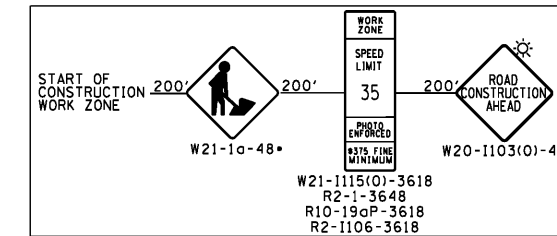

V3 Companies  
7325 Janes Avenue  
Woodridge, IL 60517  
630.724.9200 phone  
630.724.9202 fax  
www.v3co.com

USER NAME = dsherman	DESIGNED - DTE	REVISED -
PLOT SCALE = 50'	DRAWN - DRP	REVISED -
PLOT DATE = 1/31/2014	CHECKED - VJD	REVISED -
	DATE - 01/31/2014	REVISED -

**STATE OF ILLINOIS  
DEPARTMENT OF TRANSPORTATION**

**MAINTENANCE OF TRAFFIC - STAGE 4a  
STATION 289+25 TO STATION 304+00**

SCALE: 1" = 50' SHEET NO. 4 OF 5 SHEETS STA. 289+25 TO STA. 304+00

F.A.P. RTE. 353	SECTION 11-Y-A	COUNTY COOK	TOTAL SHEETS 354	SHEET NO. 66
CONTRACT NO. 60R19				
ILLINOIS FED. AID PROJECT				