

PLAN	SURVEYED	BY	DATE
	PLOTTED		
	CHECKED		
	ALIGNED		
	FILED		
	NO. _____		
	CARD FILE NAME		

PROFILE	SURVEYED	BY	DATE
	PLOTTED		
	CHECKED		
	GRADES		
	STRUCTURE		
	NOTATIONS		
	CHKD		
	NO. _____		

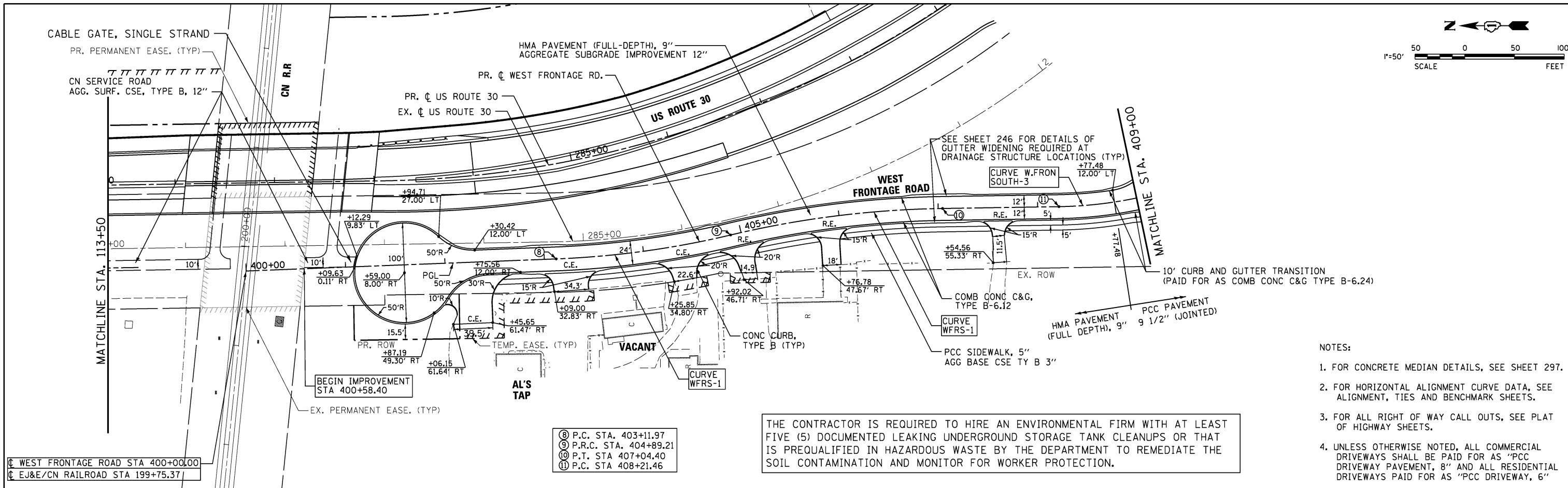

THE CONTRACTOR IS REQUIRED TO HIRE AN ENVIRONMENTAL FIRM WITH AT LEAST FIVE (5) DOCUMENTED LEAKING UNDERGROUND STORAGE TANK CLEANUPS OR THAT IS PREQUALIFIED IN HAZARDOUS WASTE BY THE DEPARTMENT TO REMEDIATE THE SOIL CONTAMINATION AND MONITOR FOR WORKER PROTECTION.

- NOTES:
- FOR CONCRETE MEDIAN DETAILS, SEE SHEET 297.
  - FOR HORIZONTAL ALIGNMENT CURVE DATA, SEE ALIGNMENT, TIES AND BENCHMARK SHEETS.
  - FOR ALL RIGHT OF WAY CALL OUTS, SEE PLAT OF HIGHWAY SHEETS.
  - UNLESS OTHERWISE NOTED, ALL COMMERCIAL DRIVEWAYS SHALL BE PAID FOR AS "PCC DRIVEWAY PAVEMENT, 8" AND ALL RESIDENTIAL DRIVEWAYS PAID FOR AS "PCC DRIVEWAY, 6"

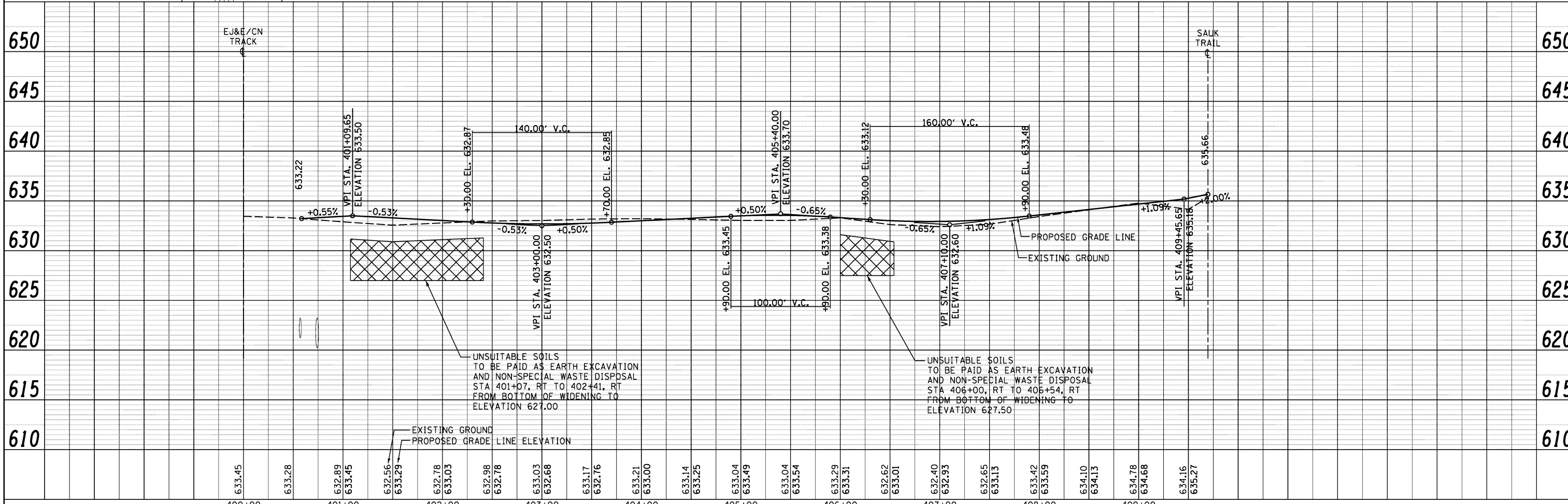

V3 Companies 7325 Janes Avenue Woodridge, IL 60517 630.724.9200 phone 630.724.9202 fax www.v3co.com	USER NAME = dsherman PLOT SCALE = 5/8" PLOT DATE = 3/27/2014	DESIGNED - DTE DRAWN - DRP CHECKED - VJD DATE - 03/28/2014	REVISED - REVISED - REVISED - REVISED -	<b>STATE OF ILLINOIS DEPARTMENT OF TRANSPORTATION</b>		<b>WEST FRONTAGE ROAD - SOUTH PLAN AND PROFILE STATION 401+10 TO STATION 409+70</b>		F.A.P. RTE. 353 SECTION 11-Y-A COUNTY COOK TOTAL SHEETS 354 SHEET NO. 107 CONTRACT NO. 60R19	SCALE: 1" = 50' SHEET NO. 6 OF 7 SHEETS STA. 401+10 TO STA. 409+70	ILLINOIS FED. AID PROJECT
--	--	---	--	---	--	---	--	---	--	---------------------------