

PART OF SECTIONS 20 & 29, T35N, R15E OF THE 3rd PM, BLOOM TOWNSHIP, COOK COUNTY, ILLINOIS.

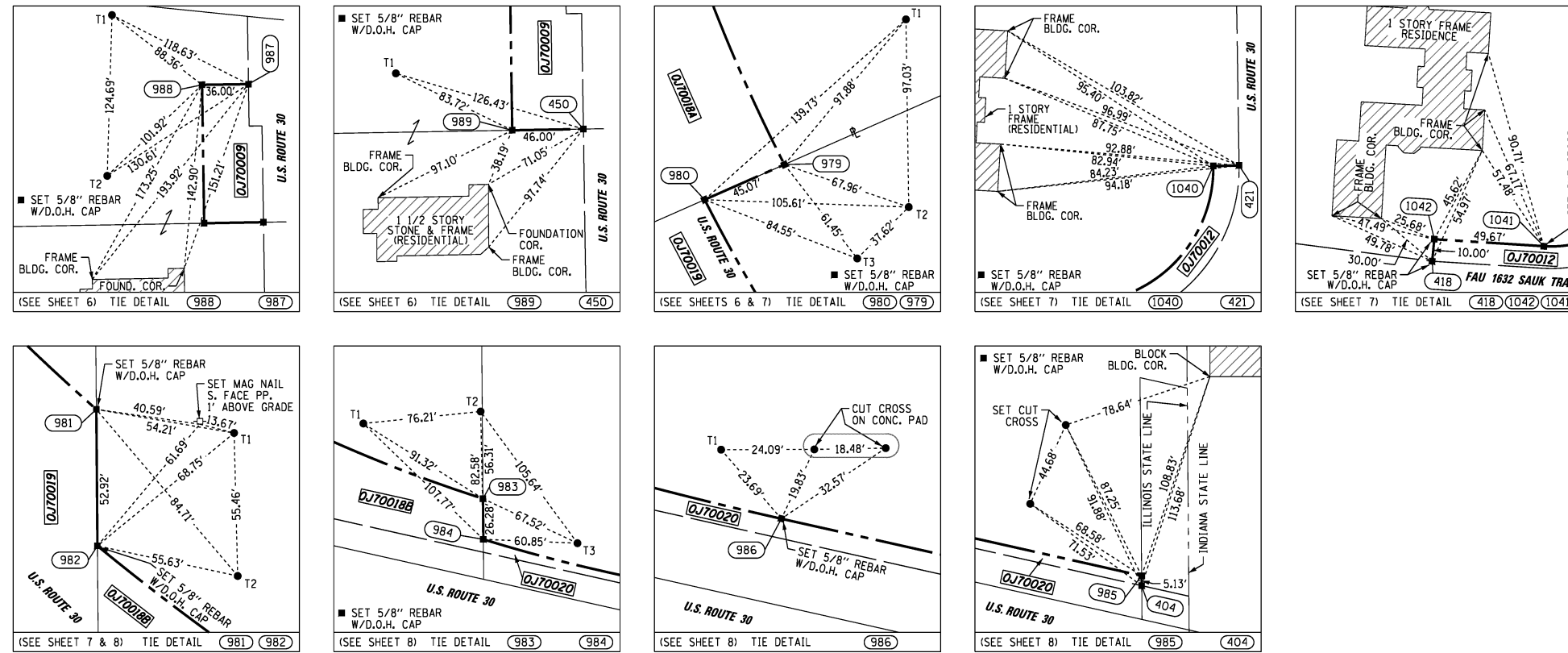

**LEGEND**

SECTION CORNER (9 10 16 15)      QUARTER SECTION CORNER (16 15)

SECTION LINE  
 QUARTER SECTION LINE  
 QUARTER, QUARTER SECTION LINE  
 PLATTED LOT LINE  
 PROPERTY (DEED) LINE

APL  
 APPARENT PROPERTY LINE  
 EXISTING CENTERLINE  
 PROPOSED CENTERLINE  
 EXISTING RIGHT OF WAY LINE  
 PROPOSED RIGHT OF WAY LINE  
 PROPOSED EASEMENT  
 MEASURED DIMENSION  
 COMPUTED DIMENSION  
 RECORD DATA

129.32'  
 129.32' (COMP)  
 (129.32')

BEARINGS ARE BASED ON ILLINOIS STATE PLANE COORDINATE SYSTEM EAST ZONE, N.A.D. 83 (2007)

- IRON PIPE OR ROD FOUND      ○ SET 5/8" x 30" REBAR
- + CUT CROSS FOUND OR SET      ● PK FOUND PK NAIL      ○ PK SET PK NAIL
- T1 THESE STAKES REFERENCE FOUND OR SET MONUMENTATION  
 T2 SET 5/8 INCH REBAR FLUSH WITH GROUND TO TIE FOUND IRON STAKE, IDENTIFIED BY COLORED PLASTIC CAP AND BEARING SURVEYORS PROFESSIONAL NUMBER.
- BT1 THESE STAKES, IN CULTIVATED AREAS, REFERENCE FOUND OR SET MONUMENTATION.  
 BT2 BURIED 5/8 INCH REBAR 20 INCHES BELOW GROUND TO TIE FOUND IRON STAKE.  
 BT3 IDENTIFIED BY COLORED PLASTIC CAP BEARING SURVEYORS PROFESSIONAL NUMBER.
- STAKING OF PROPOSED RIGHT OF WAY.  
 SET DIVISION OF HIGHWAYS SURVEY MARKER TO MONUMENT THE POSITION SHOWN, IDENTIFIED BY INSCRIPTION DATA AND SURVEYORS PROFESSIONAL NUMBER.
- M STAKING OF PROPOSED RIGHT OF WAY IN CULTIVATED AREAS.  
 BURIED 5/8 INCH REBAR 20 INCHES BELOW GROUND TO MARK FUTURE SURVEY MARKER POSITION, IDENTIFIED BY COLORED PLASTIC CAP BEARING SURVEYORS PROFESSIONAL NUMBER.
- ⊙ PERMANENT SURVEY MARKER, 100T STD. 2135 (TO BE SET BY OTHERS)
- RIGHT OF WAY STAKING PROPOSED TO BE SET.

STATE OF ILLINOIS )  
 ) SS  
 COUNTY OF WILL )

THIS IS TO CERTIFY THAT WE, CLAASSEN, WHITE & ASSOCIATES, P.C., AN ILLINOIS PROFESSIONAL DESIGN FIRM LAND SURVEYING CORPORATION NUMBER 184-004039, HAVE SURVEYED THE PLAT OF HIGHWAYS SHOWN HEREON IN SECTIONS 20 AND 29, TOWNSHIP 35 NORTH, RANGE 15 EAST OF THE THIRD PRINCIPAL MERIDIAN, COOK COUNTY, THAT THE SURVEY IS TRUE AND COMPLETE AS SHOWN TO THE BEST OF MY KNOWLEDGE AND BELIEF, THAT THE PLAT CORRECTLY REPRESENTS SAID SURVEY, THAT ALL MONUMENTS FOUND AND ESTABLISHED ARE OF PERMANENT QUALITY AND OCCUPY THE POSITIONS SHOWN THEREON AND THAT THE MONUMENTS ARE SUFFICIENT TO ENABLE THE SURVEY TO BE RETRACED. THIS SURVEY CONFORMS TO THE CURRENT ILLINOIS MINIMUM STANDARDS FOR A BOUNDARY SURVEY. MADE FOR THE DEPARTMENT OF TRANSPORTATION, STATE OF ILLINOIS.

DATED AT JOLIET, ILLINOIS THIS 16TH DAY OF AUGUST, 2013 A.D.

*Rhonda J. White* PRESIDENT  
 RHONDA J. WHITE  
 ILLINOIS PROFESSIONAL LAND SURVEYOR NO. 035-003306  
 LICENSE EXPIRES NOVEMBER 30, 2012  
 THIS PROFESSIONAL SERVICE CONFORMS TO THE CURRENT ILLINOIS MINIMUM STANDARDS FOR A BOUNDARY SURVEY.



**COORDINATE TABLE ~ US ROUTE 30**

PT.NO.	STATION	OFFSET	NORTHING	EASTING
988	282+78.01	160.00' RT.	1,760,535.2262	1,204,448.4323
987	282+78.01	124.00' RT.	1,760,535.7758	1,204,484.4282
989	283+75.18	162.36' RT.	1,760,427.9402	1,204,450.0704
450	283+77.68	116.45' RT.	1,760,428.7477	1,204,496.0635
980	287+83.69	120.00' LT.	1,760,104.2885	1,204,828.8374
979	287+86.67	165.00' LT.	1,760,122.4673	1,204,870.0820
981	291+74.48	120.00' LT.	1,759,832.4977	1,205,039.1649
982	292+12.83	80.00' LT.	1,759,779.5804	1,205,039.5948
983	296+06.43	80.00' LT.	1,759,606.9941	1,205,356.8553
984	296+15.09	55.00' LT.	1,759,580.7189	1,205,357.0687
986	296+98.63	55.00' LT.	1,759,560.3442	1,205,433.5059
985	297+85.33	55.00' LT.	1,759,541.3964	1,205,518.1063
404	297+86.49	50.00' LT.	1,759,536.2632	1,205,518.1480

**COORDINATE TABLE ~ SAUK TRAIL**

PT.NO.	STATION	OFFSET	NORTHING	EASTING
418	383+42.87	26.91' LT.	1,759,670.1653	1,204,407.4394
1042	383+44.05	36.86' LT.	1,759,680.1247	1,204,408.3970
1041	383+96.30	30.70' LT.	1,759,676.9846	1,204,457.9715
1040	384+66.06	74.20' LT.	1,759,730.1304	1,204,513.7310
421	384+77.19	72.07' LT.	1,759,730.2831	1,204,523.7298

PRINTING DATE: AUGUST 16, 2013 JLS /Microstation/Sheet 15.dgn

**CWA SURVEY**  
 CLAASSEN, WHITE & ASSOCIATES, P.C.  
 LAND SURVEYORS  
 121 AIRPORT DRIVE, UNIT 1, JOLIET, ILLINOIS 60431  
 (815) 744-3720      cklassenwhite@cwasurvey.com  
 CWA Job #5857

**PLAT OF HIGHWAYS  
 STATE OF ILLINOIS  
 DEPARTMENT OF TRANSPORTATION  
 U.S. ROUTE 30**

SECTION: @ CN RAILROAD      COOK COUNTY  
 PROJECT      JOB NO. R-90-017-11  
 STATION NONE      TO STATION NONE  
 SCALE: N/A      SHEET 15 OF 15

BUREAU OF LAND ACQUISITION  
 201 WEST CENTER COURT  
 SCHALMBURG, ILLINOIS 60196-1096