

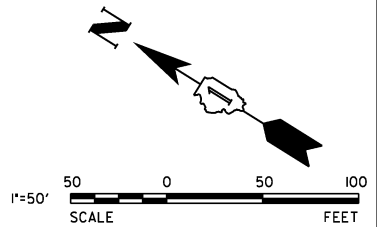





* CONTRACTOR TO STORE EXISTING SIGN PANEL UNTIL RE-INSTALLATION. COST OF STORING SIGN TO BE INCIDENTAL TO "REMOVE SIGN PANEL ASSEMBLY - TY A/B."

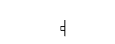

LEGEND

-  EXISTING SIGN
-  PROPOSED SIGN
-  SIGN REMOVAL
-  EXISTING SIGN LOCATION
-  PROPOSED SIGN LOCATION

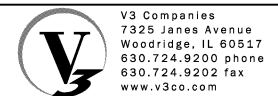
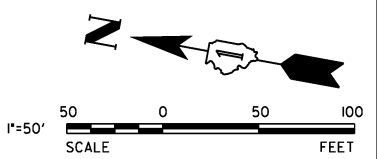
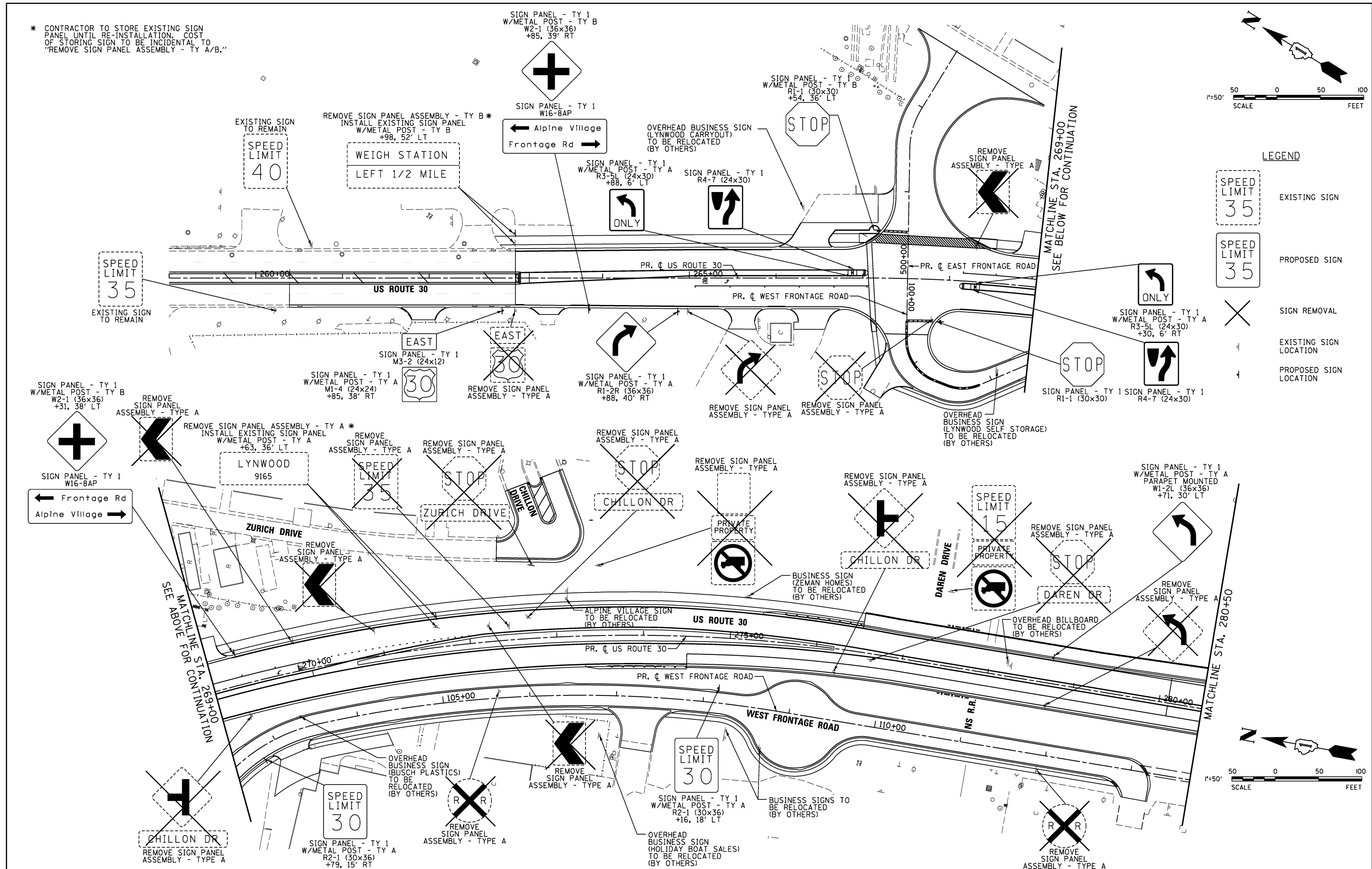

| | | |
|----------------------|-------------------|-----------|
| USER NAME = *USER* | DESIGNED - DTE | REVISED - |
| PLOT SCALE = *SCALE* | DRAWN - DRP | REVISED - |
| PLOT DATE = *DATE* | CHECKED - VJD | REVISED - |
| | DATE - 08/14/2013 | REVISED - |

**STATE OF ILLINOIS
DEPARTMENT OF TRANSPORTATION**

| | | |
|---|-------------------------|----------------------------|
| US ROUTE 30 SIGNING PLANS | | |
| STATION 259+00 TO STATION 280+50 | | |
| SCALE: 1" = 50' | SHEET NO. 1 OF 3 SHEETS | STA. 259+00 TO STA. 280+50 |

| | | | | |
|---------------------------|---------|--------|--------------|-----------|
| F.A.P. RTE. | SECTION | COUNTY | TOTAL SHEETS | SHEET NO. |
| 353 | 11-Y-A | COOK | 354 | 159 |
| CONTRACT NO. 60R19 | | | | |
| ILLINOIS FED. AID PROJECT | | | | |