

TOP OF BEAM ELEVATIONS

Beam No.	℄ Brg. N. Abut.	℄ Splice Span 1	℄ Brg. Pier	℄ Brg. S. Abut.
Beam 1	659.96	660.22	660.18	660.01
Beam 2	659.82	660.09	660.05	659.89
Beam 3	659.69	659.96	659.92	659.77
Beam 4	659.77	660.04	660.00	659.86
Beam 5	659.89	660.17	660.13	659.99
Beam 6	660.01	660.30	660.26	660.12
Beam 7	660.13	660.43	660.39	660.26
Beam 8	660.25	660.55	660.52	660.39
Beam 9	660.25	660.56	660.53	660.40
Beam 10	660.12	660.43	660.40	660.28
Beam 11	659.98	660.30	660.27	660.16
Beam 12	659.84	660.17	660.14	660.04
Beam 13	659.71	660.04	660.01	659.91

For Fabrication Only

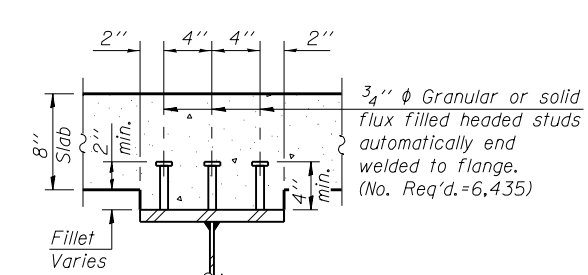
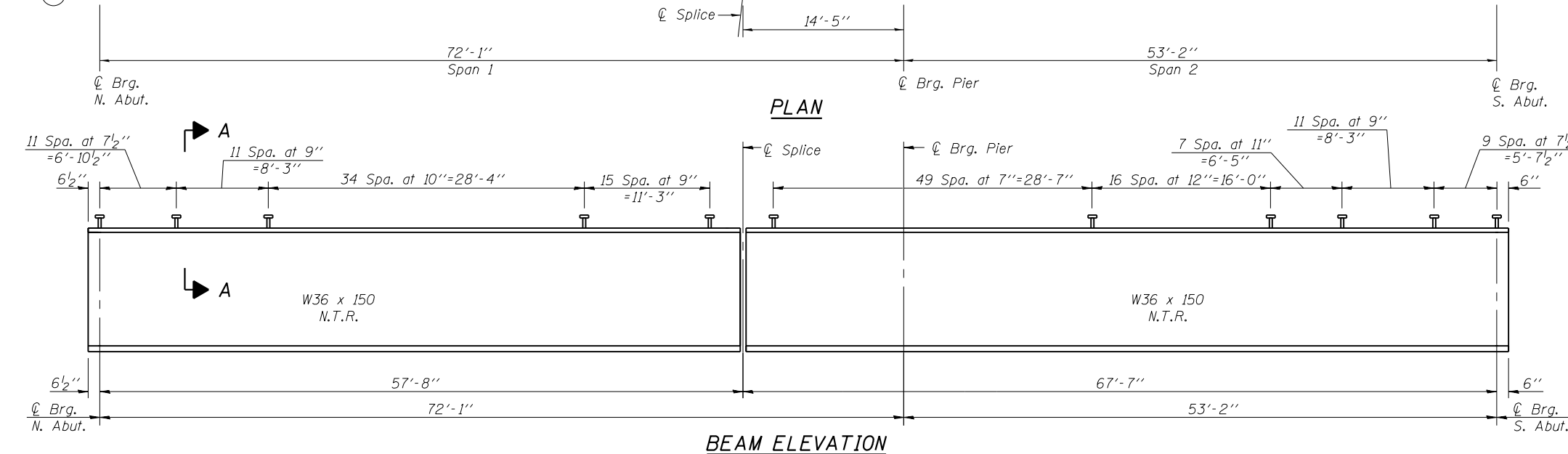

Notes:
 All diaphragms shall be installed as steel is erected and secured with erection pins and bolts except as otherwise noted. Individual diaphragms at supports may be temporarily disconnected to install bearing anchor rods.
 Load carrying components designated "N.T.R." shall conform to the Impact Testing Requirement, Zone 2.
 All Beams and splice ℄'s shall conform to the requirements of AASHTO M270 Grade 50.
 See Sheet 18 of 35 for diaphragm details, Beam Moment and Reaction Tables, and splice details.

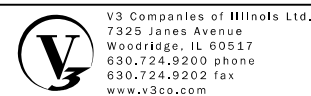

USER NAME =	DESIGNED - WJV	REVISOR
PLOT SCALE =	CHECKED - CJB	REVISOR
PLOT DATE =	DRAWN - WJV	REVISOR
	CHECKED - CJB	REVISOR

**STATE OF ILLINOIS
DEPARTMENT OF TRANSPORTATION**

**FRAMING PLAN AND ELEVATION
STRUCTURE NO. 016-1350
SHEET NO. 17 OF 35 SHEETS**

F.A.P. RTE.	SECTION	COUNTY	TOTAL SHEETS	SHEET NO.
353	11-Y-A	COOK	354	202
CONTRACT NO. 60R19				
ILLINOIS FED. AID PROJECT				