

LEGEND

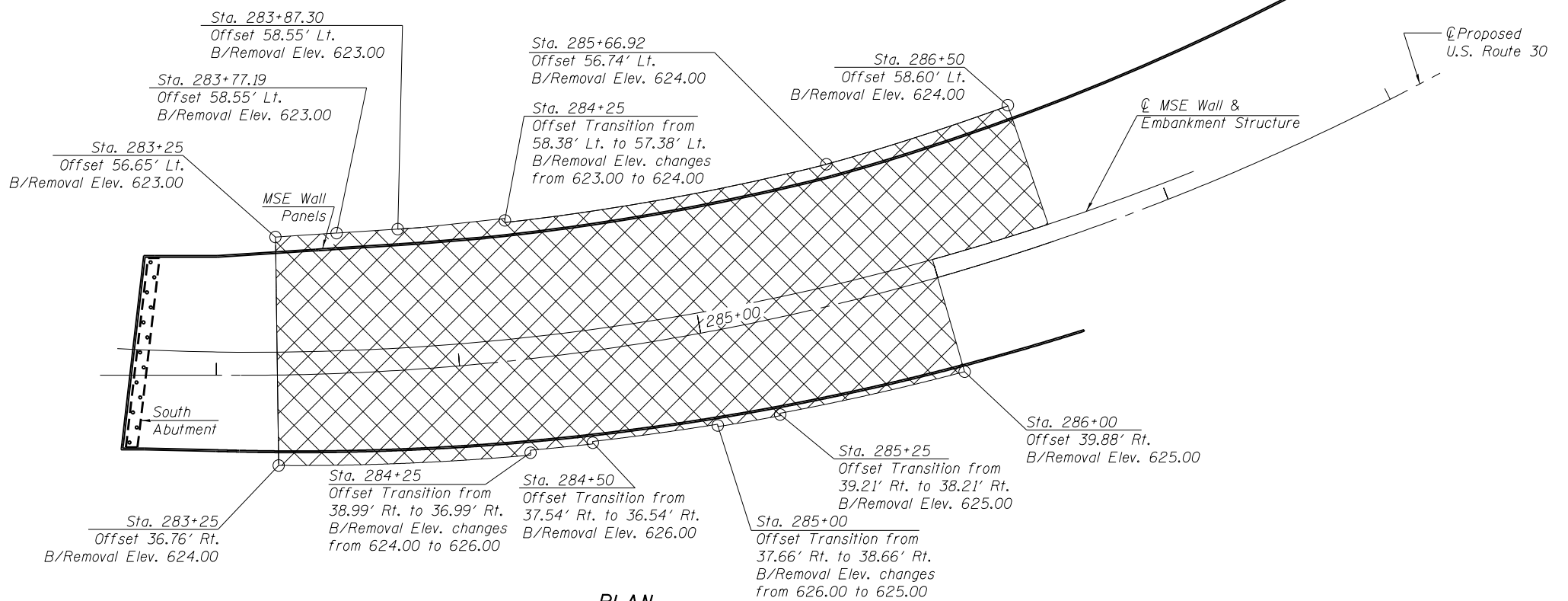

Limits of Removal and Disposal of Unsuitable Material for Structures, Backfill with Aggregate Subgrade Improvement.



Notes:

The limits and quantities of removal and replacement of unsuitable material for structures shown are based on the boring data and may be modified by the Engineer for variable subsurface conditions encountered in the field.

See Sheet 8 of 25 for cross section limits of Removal and Disposal of Unsuitable Material for Structures and placement of Aggregate Subgrade Improvement.



| | | |
|--------------|----------------|---------|
| USER NAME = | DESIGNED - EVS | REVISED |
| | CHECKED - WJV | REVISED |
| PLOT SCALE = | DRAWN - EVS | REVISED |
| PLOT DATE = | CHECKED - WJV | REVISED |

**STATE OF ILLINOIS
DEPARTMENT OF TRANSPORTATION**

**UNSUITABLE MATERIAL REMOVAL AND BACKFILL LAYOUT
STRUCTURE NO. 016-1280**

SHEET NO. 4 OF 25 SHEETS

| F.A.P. RTE. | SECTION | COUNTY | TOTAL SHEETS | SHEET NO. |
|--------------------|---------|--------|--------------|-----------|
| 353 | 11-Y-A | COOK | 354 | 259 |
| CONTRACT NO. 60R19 | | | | |

ILLINOIS FED. AID PROJECT