

Bench Mark:

BM #3 - Cut square in N.E. corner of large utility structure S. of the N. set of R.R. tracks (Norfolk Southern Railroad) and near the E. R.O.W. line of U.S. Rt. 30 Sta. 278+54.41, 71.23' L.L., Elev. 631.16

BM #103 - Cut square at corner of traffic manhole on E. side of U.S. Rt. 30 and E. line of Sauk Trail Sta. 291+34.10, 39.95' L.L., Elev. 633.67

Existing Structure: None

Stage traffic to be maintained along existing US 30. See Roadway Plans for maintenance of traffic.

MSE Wall (S.N. 016-1279, North Walls) For the limits of removal of unsuitable material and backfill with structural fill for the east half of the N. Abut. see SN 016-1279. The limits shall extend 5' in front of the wall face and 5' beyond the reinforced soil mass.

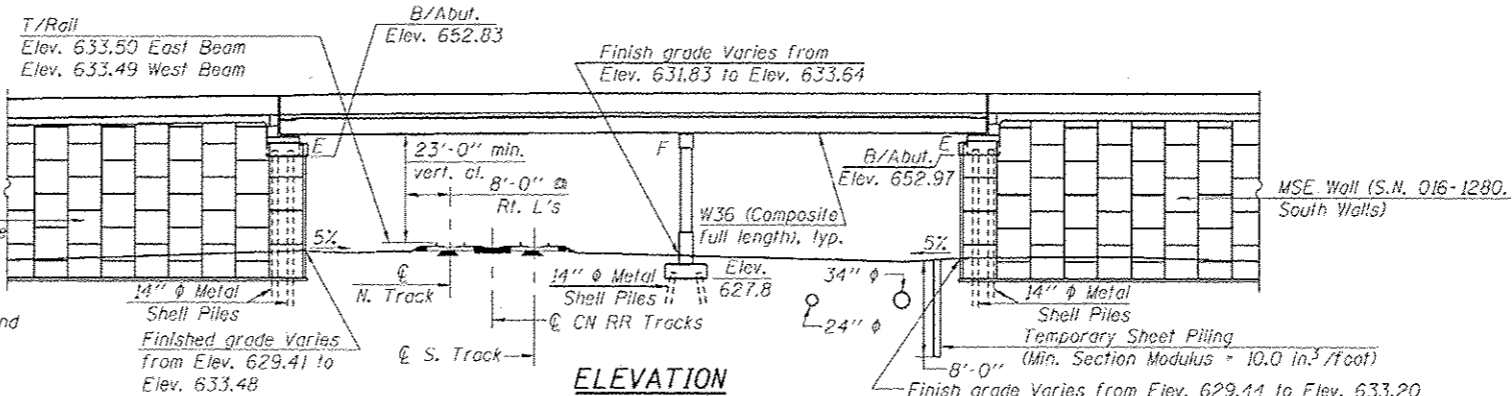

APPROVED
For Structural Adequacy Only
Bill Veam
Engineer of Bridges & Structures

STATION 282+05.51
BUILT BY
STATE OF ILLINOIS
F.A.P. RT. 353 SEC. 11-Y-A
LOADING HL-93
STRUCTURE NO. 016-1350

NAME PLATE
See Std. 515001

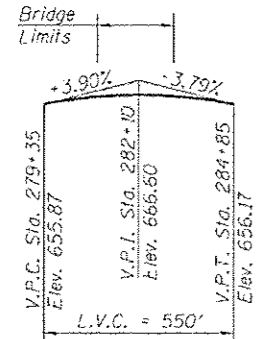

PROFILE GRADE - US 30
(along EB & WB P.G.L.'s)

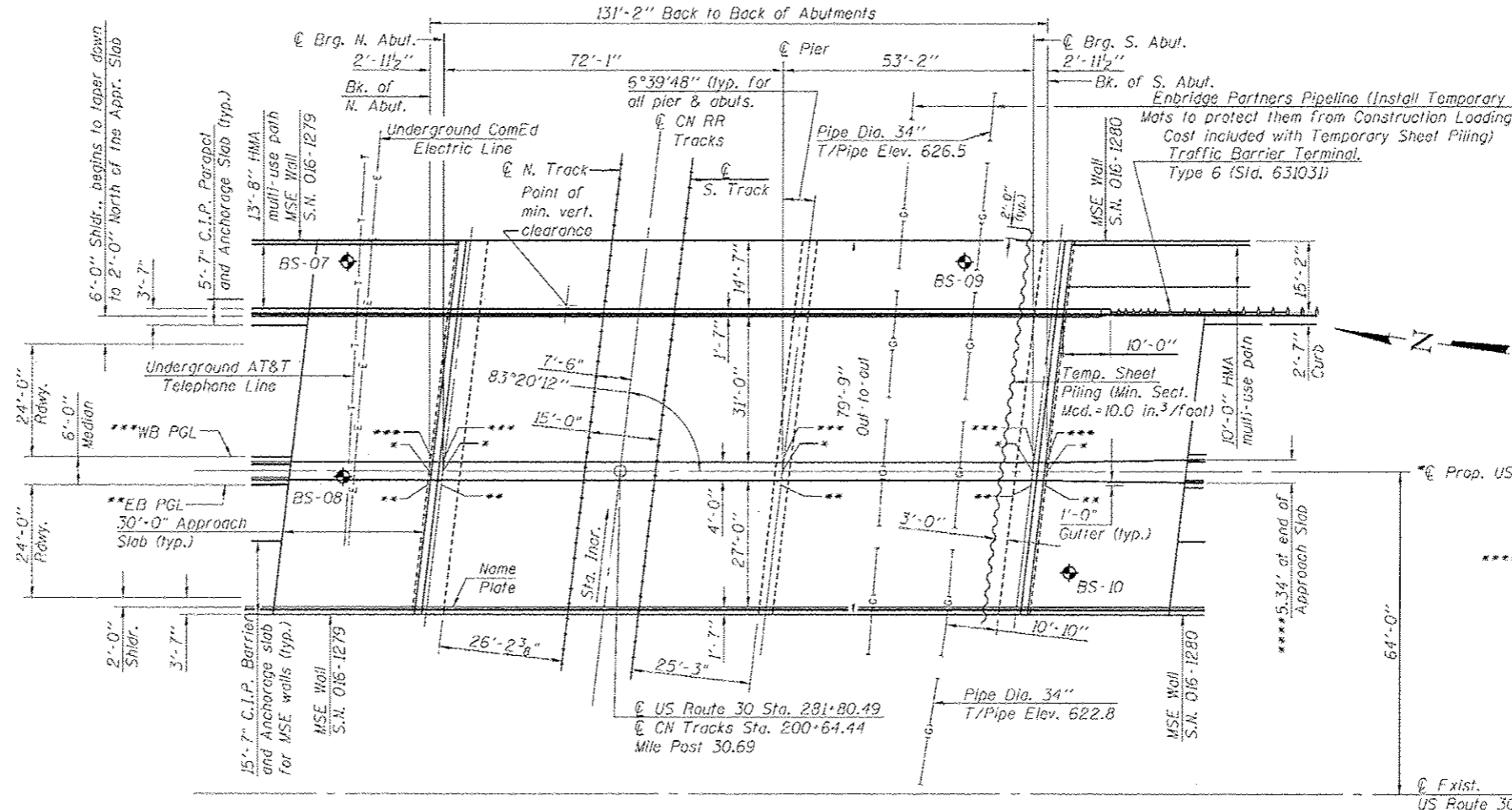

PLAN

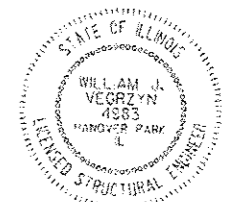

Bill Veam 8/12/2013
Expires 11-30-14

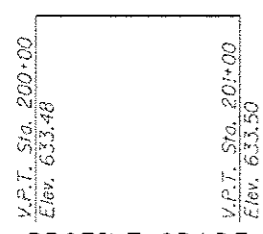

PROFILE GRADE
(Top of Rail CN Railroad)

***@ US RTE. 30, **EB PGL AND ***WB PGL STATIONS AND ELEVATIONS TABLE**

Transverse	@ US RTE. 30		**EB PGL		***WB PGL	
	Station	Elev.	Station	Elev.	Station	Elev.
Bk. of N. Abut.	281+39.93	660.99	281+39.56	660.93	281+40.28	660.93
@ Brg. N. Abut.	281+42.89	661.02	281+42.54	660.96	281+43.24	660.96
@ Pier	282+14.97	661.38	282+14.62	661.31	282+15.32	661.31
@ Brg. S. Abut.	282+68.14	661.17	282+67.79	661.11	282+68.49	661.11
Bk. of S. Abut.	282+71.09	661.15	282+70.74	661.09	282+71.44	661.08

LOADING HL-93
Allow 50#/sq. ft. for future wearing surface.
DESIGN SPECIFICATIONS
2012 AASHTO LRFD Bridge Design Specifications, 6th Edition

DESIGN STRESSES
FIELD UNITS
f'c = 3,500 psi
fy = 60,000 psi (Reinforcement)
fy = 50,000 psi (M270 Grade 50)

SEISMIC DATA
Seismic Performance Zone (SPZ) = 1
Design Spectral Acceleration at 1.0 sec. (S₀₁) = 0.093g
Design Spectral Acceleration at 0.2 sec. (S₀₅) = 0.152g
Soil Site Class = D

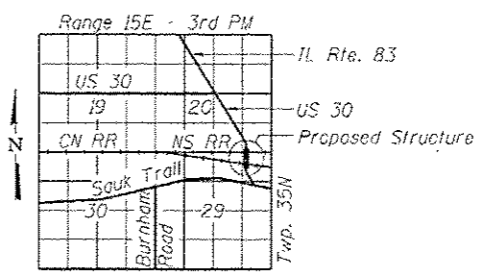

LOCATION SKETCH

GENERAL PLAN & ELEVATION
US ROUTE 30 OVER
THE CN RAILROAD
F.A.P. RTE. 353 - SEC. 11-Y-A
COOK COUNTY
STATION 282+05.51
STRUCTURE NO. 016-1350

V3 Companies of Illinois Ltd. 7325 Jones Avenue Woodridge, IL 60517 630.724.9200 phone 630.724.9202 fax www.v3co.com	USER NAME =	DESIGNED - WJV	REVISED	STATE OF ILLINOIS DEPARTMENT OF TRANSPORTATION	F.A.P. RTE. =	SECTION	COUNTY	TOTAL SHEETS	SHEET NO.	
	PLLOT SCALE =	CHECKED - CJB	REVISED		353	11-Y-A	COOK	354	186	
	PLLOT DATE =	DRAWN - WJV	REVISED		SHEET NO. 1 OF 35 SHEETS					
		CHECKED - CJB	REVISED		[ILLINOIS] FED. AID PROJECT					
CONTRACT NO. 60R19										