

**PROPOSED TEMP PAVEMENT MARKINGS AND TRAFFIC CONTROL DEVICES**

- (A) TEMP EPOXY PVT MK LINE 4 (SOLID WHITE)
- (B) TEMP EPOXY PVT MK LINE 4 (SOLID YELLOW)
- (C) TEMP EPOXY PVT MK LINE 8 (SOLID WHITE)
- (D) TEMP EPOXY PVT MK LINE 12 (WHITE CHEVRONS @ 45°, 30" SPACING) (TYP)
- (E) TEMP EPOXY PVT MK LINE 5 (10" DASH 30" SKIP, WHITE)
- (F) TEMP EPOXY PVT MK LINE 4 (2' DASH 6' SKIP, WHITE)
- (G) TYPE II BARRICADE OR DRUMS WITH STEADY BURN MONODIRECTIONAL LIGHT @ 50' C-C (TYP) ON TAPERS AND @ 100' C-C (TYP) ON TANGENTS
- (H) TYPE II BARRICADE OR DRUMS WITH STEADY BURN MONODIRECTIONAL LIGHT @ 50' C-C (TYP) ON RAMP TAPERS
- (I) DIRECTIONAL INDICATOR BARRICADE WITH STEADY BURN MONODIRECTIONAL LIGHT @ 50' C-C
- (J) TEMP CONC BARRIER @ 12:1 ON TAPERS UNLESS OTHERWISE NOTED
- (K) IMP ATTN TEMP FRN TL3

**NOTE:**

1. ALL TRAVEL LANES ON NB I-90/94 AND NW RAMP SHALL TIE INTO CURRENT STAGE OF CONSTRUCTION FOR NW RAMP FLYOVER CONTRACT 60W28 AND CONFORM TO ALL APPLICABLE IDOT DISTRICT 1 STANDARDS.
2. UNLESS NOTED OTHERWISE ALL PAVEMENT MARKINGS AND SIGNINGS ARE FROM PREVIOUS STAGE TO REMAIN
3. BEGIN PAVEMENT MARKING ALONG NW RAMP STA 10+15 (EX @ NB I-90/94)

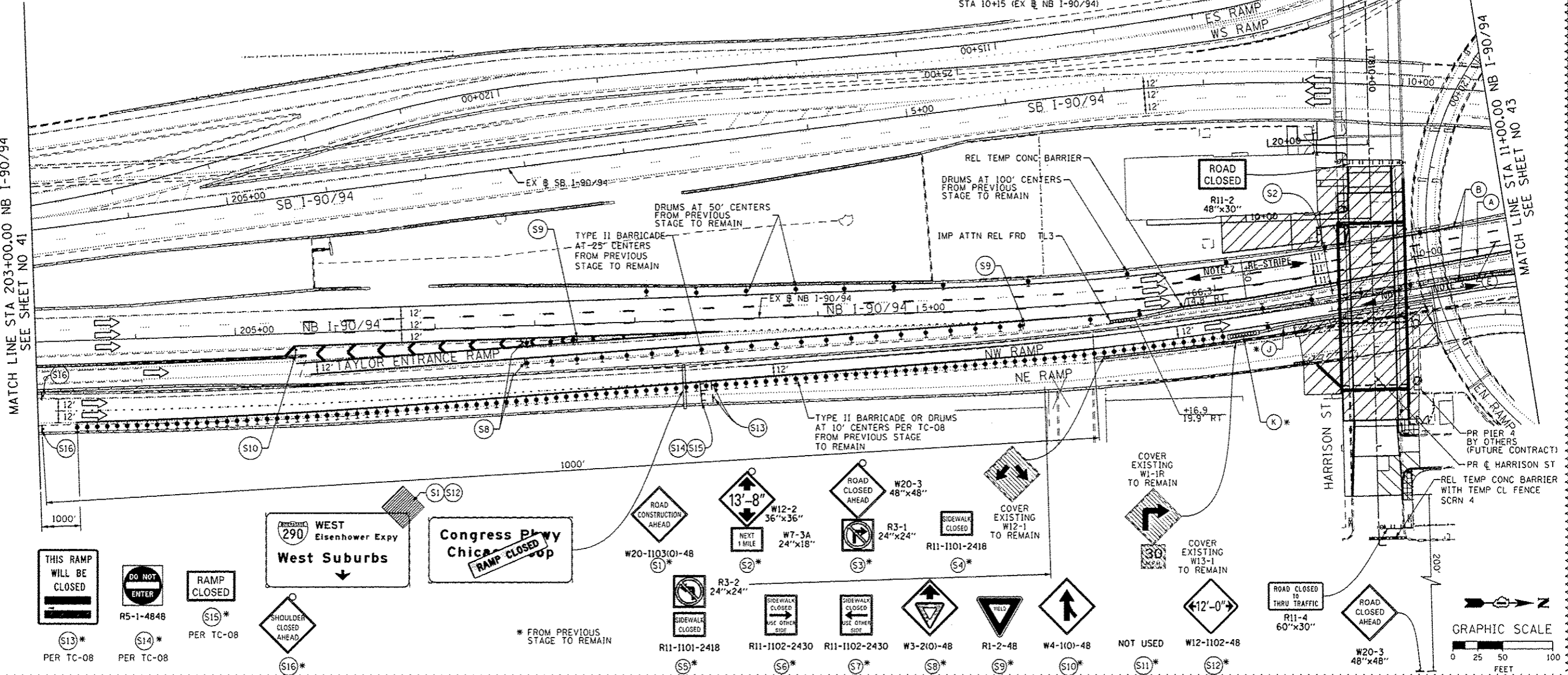
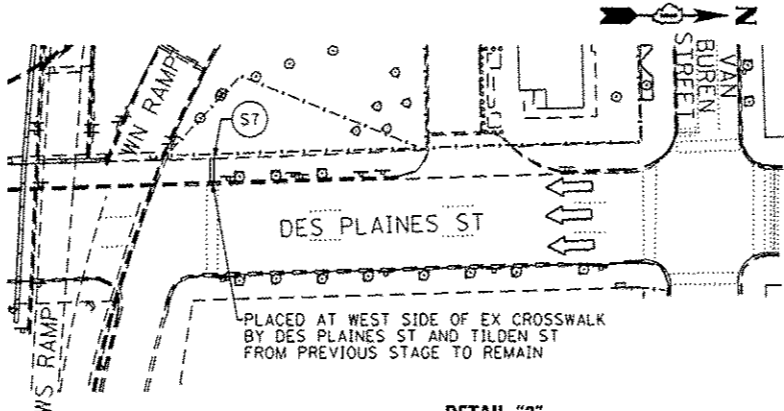
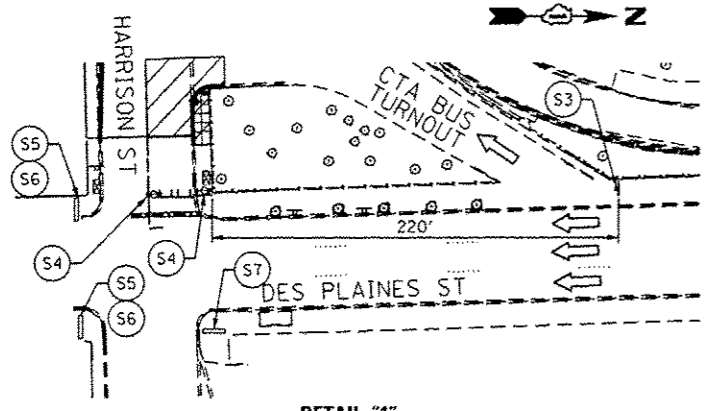

MATCH LINE STA 203+00.00 NB I-90/94 SEE SHEET NO 41

MATCH LINE STA 11+00.00 NB I-90/94 SEE SHEET NO 43

<p>303 EAST WACKER DRIVE, SUITE 1400 CHICAGO, IL 60601-2576 PHONE: (312) 373-7100 FAX: (312) 373-4800</p>	D160M71-Sht-Staging2-02.dgn	DESIGNED - OPS	REVISED - 04/03/2014	<p><b>STATE OF ILLINOIS</b> <b>DEPARTMENT OF TRANSPORTATION</b></p> <p><b>SUGGESTED STAGES OF CONSTRUCTION AND TRAFFIC CONTROL PLAN</b> <b>STAGE 2</b></p> <p>SCALE: 1" = 50' SHEET 2 OF 3 SHEETS STA. TO STA.</p>	F.A.I. RTE.	SECTION	COUNTY	TOTAL SHEET NO.	
	USER NAME - pimorino	DRAWN - OPS	REVISED -		90/94/290	2013-036R	COOK	256	42
	PLOT SCALE - 1/8"=1'-0"	CHECKED - DBM	REVISED -		CONTRACT NO. 60W71				
	PLOT DATE - 4/4/2014	DATE - 02/19/14	REVISED -		ILLINOIS FED. AID PROJECT				