

DATE	
BY	
APPROVED	
PLOTTED	
REPLACED	
NOTE BOOK	
AS EXECUTED	
NO.	

DATE	
BY	
APPROVED	
PLOTTED	
REPLACED	
NOTE BOOK	
AS EXECUTED	
NO.	

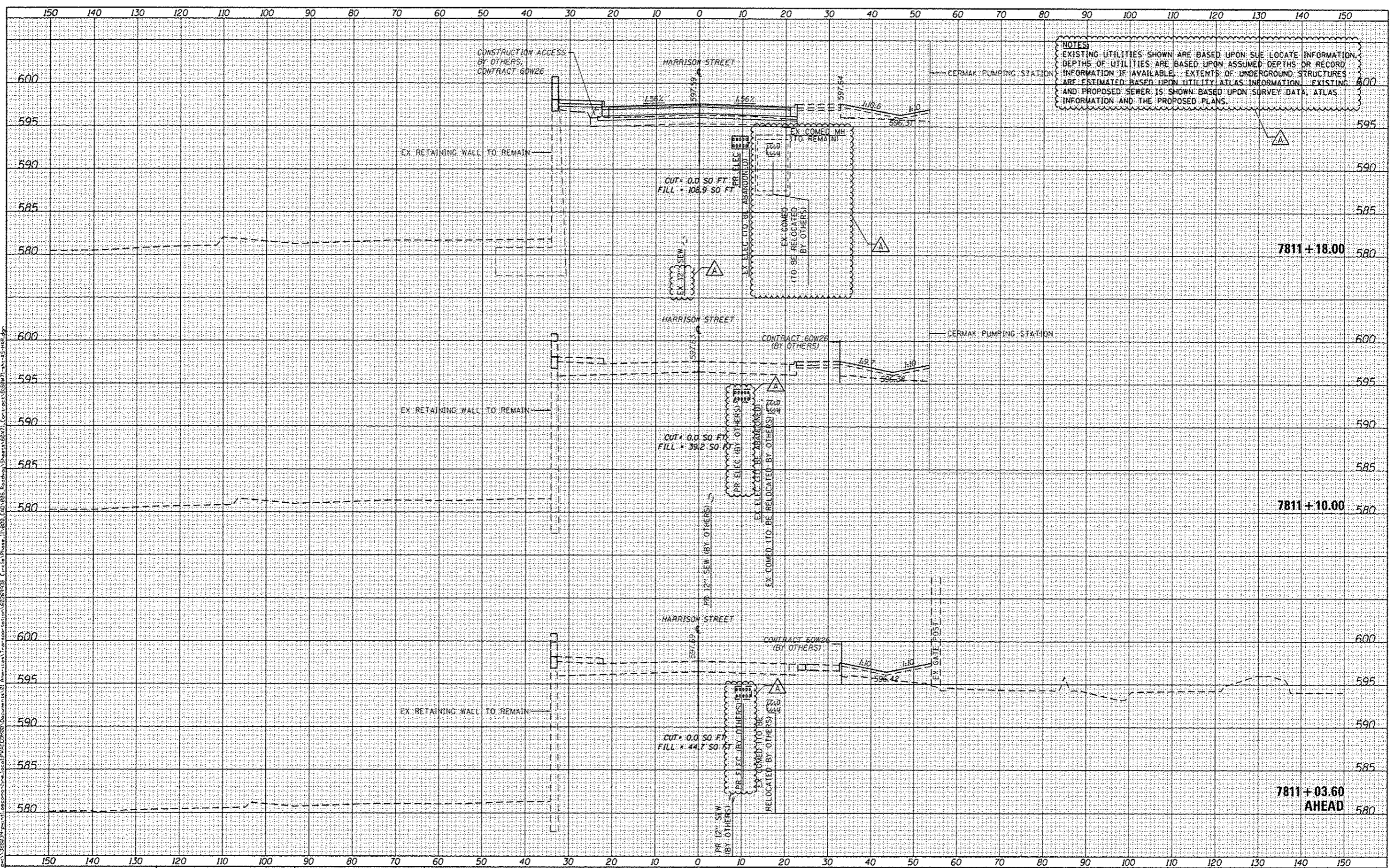

NOTES:
 EXISTING UTILITIES SHOWN ARE BASED UPON SUE LOCATE INFORMATION.
 DEPTHS OF UTILITIES ARE BASED UPON ASSUMED DEPTHS OR RECORD
 INFORMATION IF AVAILABLE. EXTENTS OF UNDERGROUND STRUCTURES
 ARE ESTIMATED BASED UPON UTILITY ATLAS INFORMATION. EXISTING
 AND PROPOSED SEWER IS SHOWN BASED UPON SURVEY DATA, ATLAS
 INFORMATION AND THE PROPOSED PLANS.



D:\6871-shr-KS-MAR.dgn	DESIGNED - OPS	REVISED - 04/03/2014
USER NAME = ChiuA	DRAWN - OPS	REVISED -
PLOT SCALE = 20.0000' / in.	CHECKED - DBW	REVISED -
PLOT DATE = 4/2/2014	DATE - 02/19/14	REVISED -

STATE OF ILLINOIS
 DEPARTMENT OF TRANSPORTATION

HARRISON STREET CROSS SECTION
 SCALE: 1/8"=1'-0"
 SHEET 1 OF 5 SHEETS
 STA. 7811+03.60 TO STA. 7811+18.00

FAA RTE.	SECTION	COUNTY	TOTAL SHEETS	SHEET NO.
90/94/290	2013-036R	COOK	256	254
CONTRACT NO. 60W71				ILLINOIS FED. AID PROJECT