

EX CURVE KDR-ENB-00-1 PI STA = 192+81.92 Δ = 3° 17' 58" (LT) D = 0° 48' 25" R = 7,100.63' T = 204.51' L = 408.90' E = 2.94' PC STA = 190+77.41 PT STA = 194+86.31	EX CURVE KDR-ENB-00-2 PI STA = 199+68.51 Δ = 3° 11' 12" (RT) D = 0° 30' 00" R = 11,460.32' T = 318.77' L = 637.38' E = 4.43' PC STA = 196+49.74 PT STA = 202+87.12	EX CURVE KDR-ESB-00-1 PI STA = 186+12.11 Δ = 0° 55' 38" (LT) D = 0° 45' 00" R = 7,640.04' T = 61.81' L = 123.62' E = 0.25' PC STA = 185+50.30 PT STA = 186+73.92	EX CURVE KDR-ESB-00-2 PI STA = 194+46.34 Δ = 4° 37' 53" (LT) D = 0° 18' 00" R = 19,100.00' T = 772.39' L = 1,543.93' E = 15.61' PC STA = 186+73.95 PT STA = 202+17.88
--	---	---	--

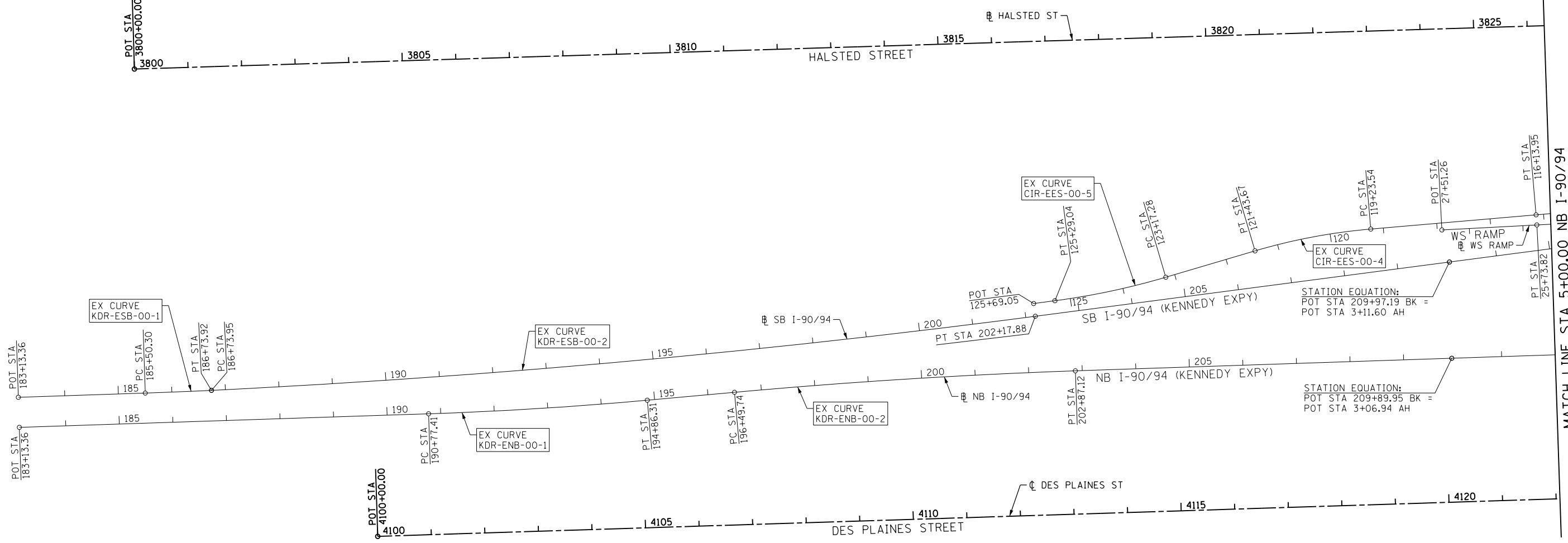
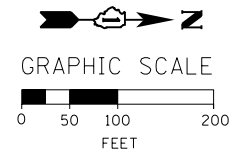

MATCH LINE STA 5+00.00 NB I-90/94

EX NW RAMP				
POINT	DESCRIPTION	STATION	NORTHING	EASTING
POT		7+96.20	1,897,507.4719	1,171,763.3763
PC	CIR-ENW-00-1	9+85.04	1,897,693.9515	1,171,733.5850
PI	CIR-ENW-00-1	10+35.96	1,897,744.2285	1,171,725.5529
PT	CIR-ENW-00-1	10+85.49	1,897,793.6250	1,171,737.8925
PC	CIR-ENW-00-2	12+39.06	1,897,942.6154	1,171,775.1112
PI	CIR-ENW-00-2	23+51.29	1,899,021.6848	1,172,044.6691
PT	CIR-ENW-00-2	20+73.26	1,898,256.1989	1,171,237.7716
PC	CIR-ENW-00-3	21+70.03	1,898,189.5975	1,171,167.5671
PI	CIR-ENW-00-3	22+66.58	1,898,123.1471	1,171,097.5218
PT	CIR-ENW-00-3	23+56.35	1,898,112.3438	1,171,001.5775
POT		29+69.88	1,898,043.6940	1,170,391.8959

EX EN RAMP				
POINT	DESCRIPTION	STATION	NORTHING	EASTING
POT		7+25.19	1,897,512.0887	1,171,791.0300
PC	CIR-ENE-00-1	8+65.84	1,897,650.9661	1,171,768.8085
PI	CIR-ENE-00-1	9+63.71	1,897,747.6108	1,171,753.3446
PCC	CIR-ENE-00-1/CIR-ENE-00-2	10+49.86	1,897,823.4622	1,171,815.1984
PI	CIR-ENE-00-2	11+58.48	1,897,907.6425	1,171,883.8441
PT	CIR-ENE-00-2	12+54.80	1,897,914.9083	1,171,992.2219
POT		14+03.76	1,897,924.8728	1,172,140.8541

PR CERMAK PUMPING STATION - EAST DRIVEWAY				
POINT	DESCRIPTION	STATION	NORTHING	EASTING
POT		9+00.00	1,897,325.0584	1,171,676.5264
POT		10+90.14	1,897,515.0846	1,171,669.9908
POT		11+25.00	1,897,549.9393	1,171,669.1216

PR CERMAK PUMPING STATION - WEST DRIVEWAY				
POINT	DESCRIPTION	STATION	NORTHING	EASTING
POT		20+00.00	1,897,446.7290	1,171,597.0350
POT		20+46.77	1,897,493.4658	1,171,595.3290
POT		20+68.91	1,897,515.6045	1,171,595.4033
POT		21+01.39	1,897,548.0829	1,171,594.6757

FILE PATH = p:\388035\pmt\lecomonline\local\p\wec\000\Documents\01_Americas\Transportation\6269938_Circle\Phase\1\000_CAD\005_Roadway\Sheets\60W71_Contract\0160W71_Sht-ATB-01.dgn



D160W71-Sht-ATB-01.dgn
USER NAME = pimsarno
PLOT SCALE = 100.0000' / 1" =
PLOT DATE = 12/19/2013

DESIGNED - OPS	REVISED -
DRAWN - PHP	REVISED -
CHECKED - DBM	REVISED -
DATE - 12/20/13	REVISED -

**STATE OF ILLINOIS
DEPARTMENT OF TRANSPORTATION**

ALIGNMENT, TIES AND BENCHMARKS

SCALE: 1" = 100' SHEET 1 OF 5 SHEETS STA. TO STA.

F.A.I. RTE. 90/94/290	SECTION 2013-036R	COUNTY COOK	TOTAL SHEETS 256	SHEET NO. 27
CONTRACT NO. 60W71				
ILLINOIS FED. AID PROJECT				