

DATE	
BY	
PLAN	SURVEYED
NOTE BOOK	ALIGNED
NO.	CHECKED
	FILE NAME

DATE	
BY	
PROFILE	SURVEYED
NOTE BOOK	GRADES CHECKED
NO.	STRUCTURE
	NOTATIONS
	CHNO

FILE PATH = p:\388035-p\m\1\escom\line\local\PAE\CD\000\Documents\01_Americas\Transportation\62629938_Circle\Phase 1\1000_CAD\005_Roadway\Sheets\60W71-Contract\0160W71-shr-Plnpr-f-01.dgn

PAVEMENT LEGEND

- (A) HMA SC "D" N70, 1 3/4"
- HMA BC IL-19.0 N70, 2 1/4"
- PCC BSE CSE 9
- SUB GRAN MAT B 6
- (B) HMA SC "D" N70, 1 1/2"
- LEV BIND MM N70, 3/4"
- (C) COMB C&G B V.12(CDOT)
- (D) PC CONC SIDEWALK 5
- SUB GRAN MAT B 4
- (E) CONC CURB TB SPL CDOT
- (F) BR APPR PVT CON (FLX)
- (G) BR APPR PAVT
- (SEE STRUCTURAL PLANS)
- (H) PCC DRIVEWAY PAVT 8
- (SEE NOTE 2)
- (I) DETECTABLE WARNINGS (SPECIAL)
- (J) TEMPORARY CHAIN LINK FENCE
- (K) ORNAMENTAL FENCE, WROUGHT IRON

PAVEMENT REMOVAL LEGEND

- [Symbol] PAVEMENT REMOVAL
- [Symbol] DRIVEWAY PAVEMENT REMOVAL
- [Symbol] SIDEWALK REMOVAL
- [Symbol] HMA SURFACE REMOVAL, 2 1/4"
- [Symbol] APPROACH SLAB REMOVAL
- [Symbol] PAVED SHOULDER REMOVAL
- [Symbol] CLASS D PATCHES
- [Symbol] LINEAR REMOVAL
- [Symbol] TREE REMOVAL (UNIT)
- [Symbol] REMOVAL (EACH)

MATCH LINE
STA 10+40.00

MATCH LINE
STA 10+40.00

END PROJECT LIMIT
STA 7814+50.00

EXISTING

NOTES

1. SEE CURB RAMP DETAIL FOR ADA RAMP INFORMATION.
2. SEE INTERSECTION DETAIL FOR EAST DRIVEWAY AT CERMAK PUMPING STATION.
3. SEE INTERSTATE REMOVAL PLAN FOR ADDITIONAL INFORMATION.
4. SEE INTERSTATE ROADWAY PLAN FOR ADDITIONAL INFORMATION.
5. SEE EX HARRISON STREET BRIDGE PLANS FOR ADDITIONAL INFORMATION FOR EX APPROACH SLAB REMOVAL
6. SEE FENCING PLAN AT CERMAK PUMPING STATION FOR ADDITIONAL INFORMATION.

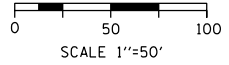

PROPOSED

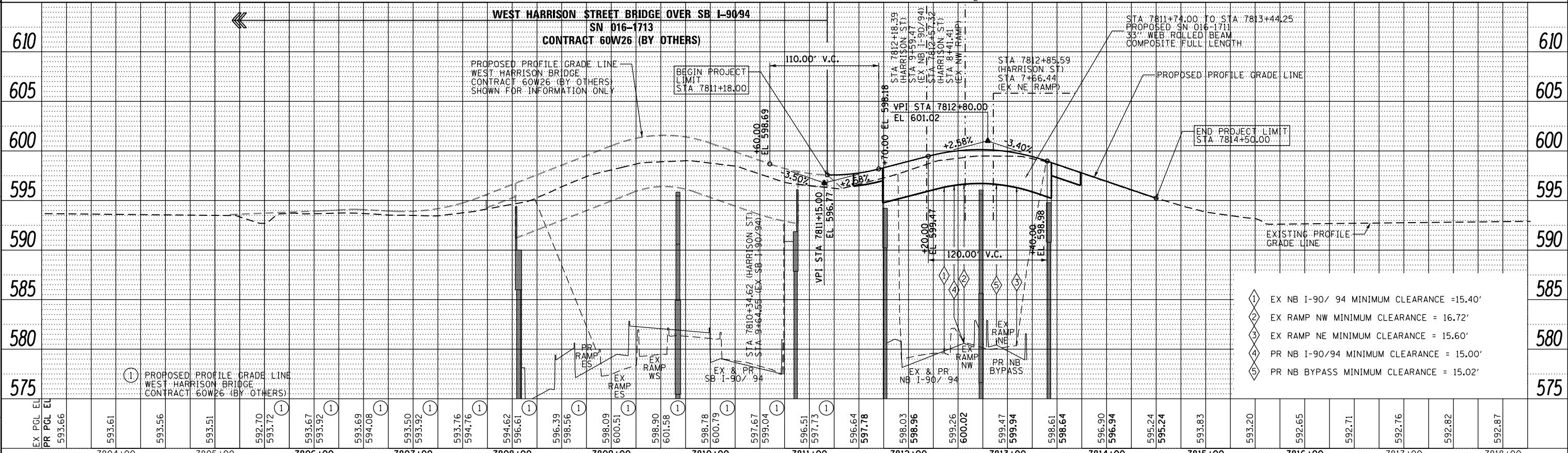

D160W71-shr-Plnpr-f-01.dgn	DESIGNED - OPS	REVISED -
USER NAME = pimsarno	DRAWN - OPS	REVISED -
PLOT SCALE = 100.0000' / in.	CHECKED - DBM	REVISED -
PLOT DATE = 2/20/2014	DATE = 02/19/14	REVISED -

**STATE OF ILLINOIS
DEPARTMENT OF TRANSPORTATION**

**PLAN AND PROFILE
HARRISON STREET**

SCALE: 1"=50' SHEET 1 OF 1 SHEETS STA. TO STA.

F.A.I. RTE.	SECTION	COUNTY	TOTAL SHEETS	SHEET NO.
90/94/290	2013-036R	COOK	256	32
CONTRACT NO. 60W71				
ILLINOIS FED. AID PROJECT				