

**LEGEND**

- (599.00) EXISTING ELEVATION
- 599.00 PROPOSED ELEVATION

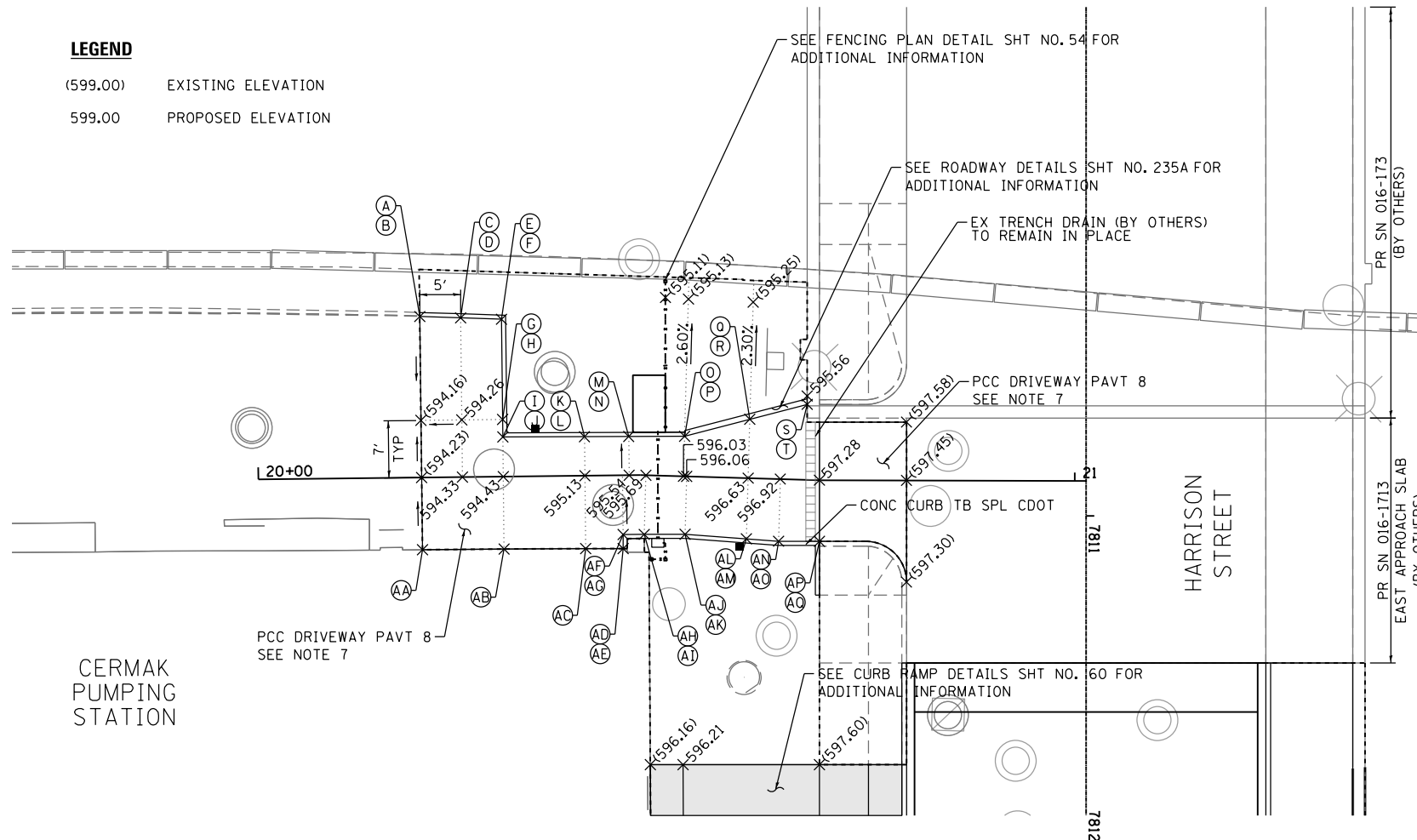

POINT	STATION	OFFSET	ELEVATION
A	20+20.00	19.73' LT	(594.38)(F)
B	20+20.00	19.73' LT	(594.93)(C)
C	20+25.00	19.50' LT	594.54 (F)
D	20+25.00	19.50' LT	595.04 (C)
E	20+30.00	19.28' LT	594.70 (F)
F	20+30.00	19.28' LT	595.14 (C)
G	20+30.00	7.00' LT	594.36 (F)
H	20+30.00	7.00' LT	594.65 (C)
I	20+30.00	4.86' LT	594.38 (F)
J	20+30.00	4.86' LT	594.63 (C)
K	20+40.00	4.79' LT	595.09 (F)
L	20+40.00	4.79' LT	595.34 (C)
M	20+45.03	4.75' LT	595.50 (F)
N	20+45.03	4.75' LT	595.75 (C)
O	20+52.07	4.90' LT	596.06 (F)
P	20+52.07	4.90' LT	596.31 (C)
Q	20+60.00	7.21' LT	596.74 (F)
R	20+60.00	7.21' LT	596.99 (C)
S	20+66.96	9.23' LT	(597.33)(F)
T	20+66.96	9.23' LT	(597.58)(C)

POINT	STATION	OFFSET	ELEVATION
AA	20+20.00	8.84' RT	(594.28)(F)
AB	20+30.91	8.87' RT	594.52 (F)
AC	20+40.00	8.92' RT	595.22 (F)
AD	20+44.58	8.97' RT	595.54 (F)
AE	20+44.58	8.97' RT	595.79 (C)
AF	20+44.59	7.25' RT	595.53 (F)
AG	20+44.59	7.25' RT	595.78 (C)
AH	20+47.47	7.25' RT	595.69 (F)
AI	20+47.47	7.25' RT	595.94 (C)
AJ	20+52.47	7.09' RT	596.04 (F)
AK	20+52.47	7.09' RT	596.29 (C)
AL	20+60.00	7.44' RT	596.57 (F)
AM	20+60.00	7.44' RT	596.82 (C)
AN	20+63.94	7.62' RT	596.85 (F)
AO	20+63.94	7.62' RT	597.10 (C)
AP	20+68.91	7.48' RT	597.19 (F)
AQ	20+68.91	7.48' RT	597.22 (C)

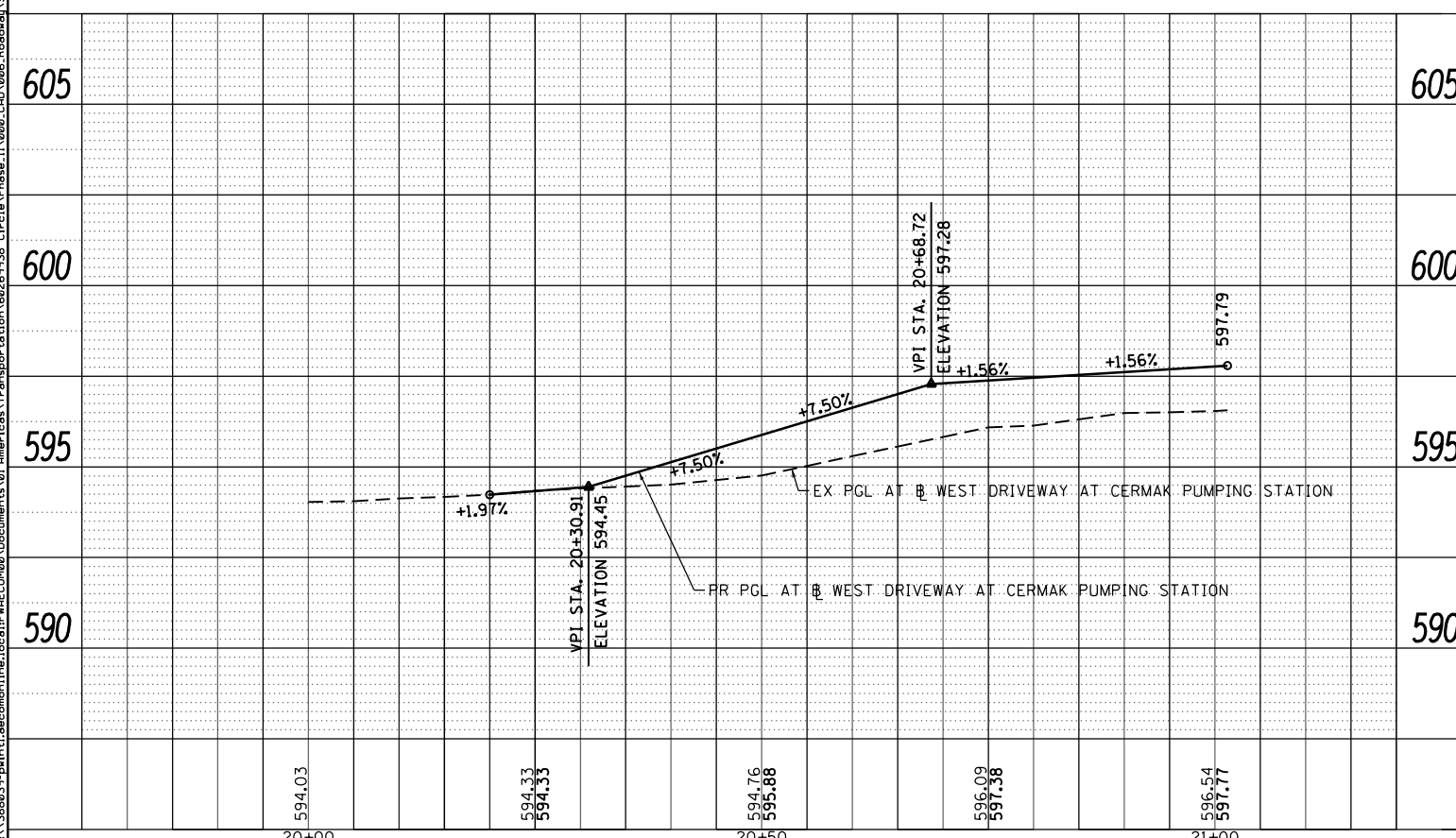
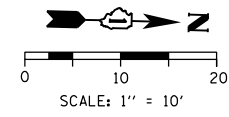

**NOTES:**

1. SEE DRAINAGE SCHEDULE AND PLANS FOR STRUCTURE INFORMATION.
2. SEE CURB RAMP DETAILS FOR ADA RAMP INFORMATION.
3. CURB HEIGHT IS 8" UNLESS OTHERWISE NOTED OR INDICATED ON THE CURB RAMP DETAILS.
4. ALL ELEVATIONS AND GRADES NOT SHOWN SHALL FOLLOW THE TYPICAL SECTIONS AND PROFILES.
5. ALL INTERSECTION PAVEMENT ELEVATIONS INSIDE OF THE HARRISON STREET EDGES OF PAVEMENT ARE CONTROLLED BY PROFILE AND CROSS SLOPES OF HARRISON STREET.
6. ELEVATIONS ARE PROVIDED AT FLOW LINE (F) AND TOP OF CURB (C) UNLESS OTHERWISE NOTED.
7. DRIVEWAY PAVEMENT LATERAL GROOVING SHALL BE APPLIED AT THE DRIVEWAY TO IMPROVE TRACTION. THIS WORK SHALL BE INCLUDED IN THE COST OF THE PCC DRIVEWAY PAVT 8 PAY ITEM. NO ADDITIONAL COMPENSATION WILL BE ALLOWED.

FILE PATH = p:\388035-p\m\1\escomon\me\local\p\AECD\00\Documents\01\Americas\Transportation\62629938\_Circle\Phase\_1\000\_CAD\005\_Roadway\_Sheets\60W71-Intersec-00



D160W71-sht-Intersec-00  
 USER NAME = pimsarno  
 PLOT SCALE = 20.0000' / in.  
 PLOT DATE = 2/21/2014

DESIGNED - AFC  
 DRAWN - AFC  
 CHECKED - DBM  
 DATE - 02/19/14

REVISED -  
 REVISED -  
 REVISED -  
 REVISED -

**STATE OF ILLINOIS  
 DEPARTMENT OF TRANSPORTATION**

**ROADWAY AND GRADING PLAN DETAILS  
 CERMAK PUMPING STATION - WEST DRIVEWAY**

SCALE: 1" = 10' SHEET 1 OF 3 SHEETS STA. TO STA.

F.A.I. RTE.	SECTION	COUNTY	TOTAL SHEETS	SHEET NO.
90/94/290	2013-036R	COOK	256	58
CONTRACT NO. 60W71				
ILLINOIS FED. AID PROJECT				