

LEGEND

- (599.00) EXISTING ELEVATION
- 599.00 PROPOSED ELEVATION

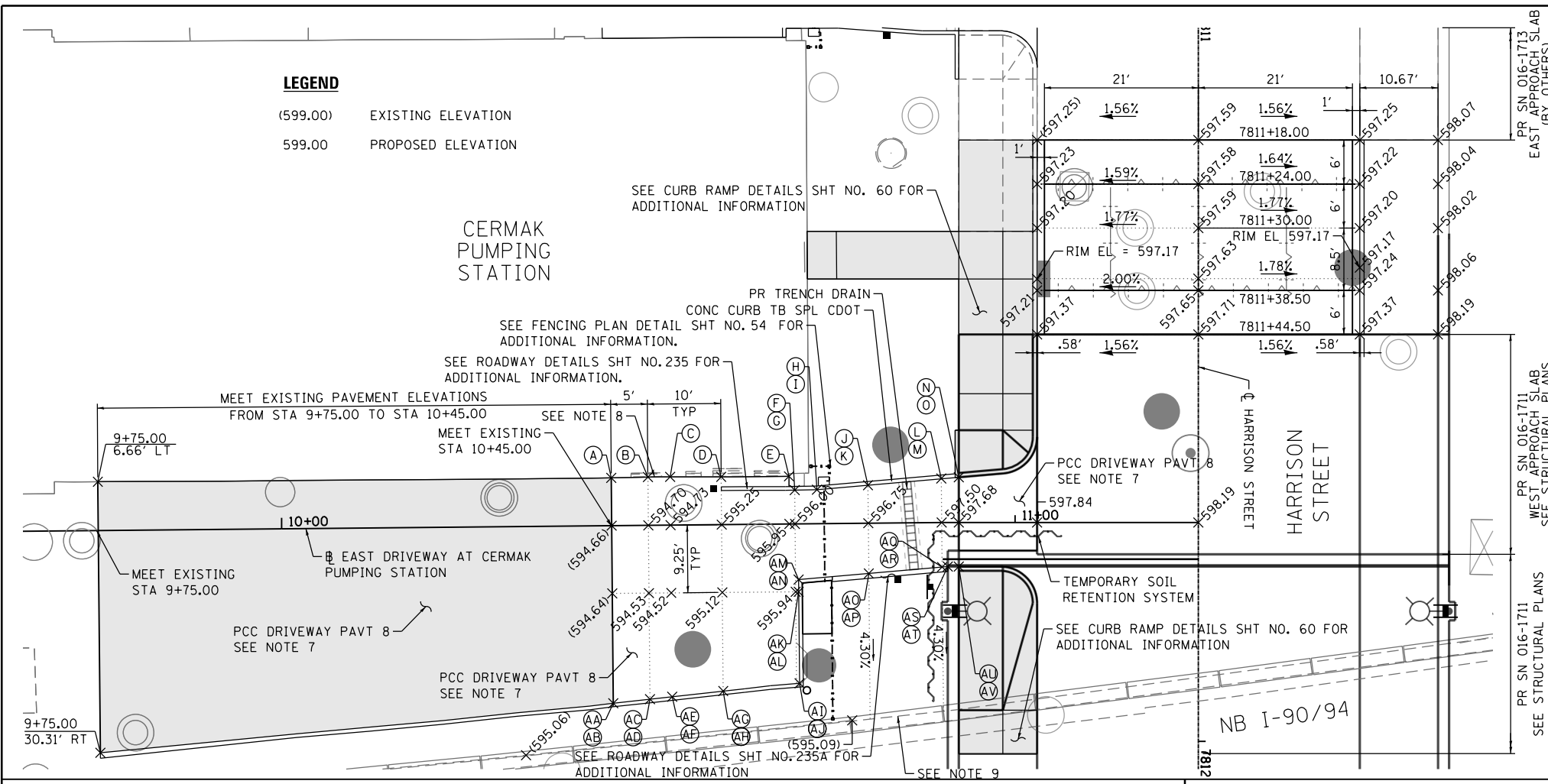

POINT	STATION	OFFSET	ELEVATION
A	10+45.00	6.52' LT	(594.70)(F)
B	10+50.00	6.58' LT	594.82 (F)
C	10+53.04	6.58' LT	594.88 (F)
D	10+60.00	6.52' LT	595.35 (F)
E	10+69.25	6.50' LT	595.40 (F)
F	10+70.00	4.62' LT	596.07 (F)
G	10+70.00	4.62' LT	596.32 (C)
H	10+73.03	4.65' LT	596.24 (F)
I	10+73.03	4.65' LT	596.49 (C)
J	10+80.00	5.19' LT	596.75 (F)
K	10+80.00	5.19' LT	597.00 (C)
L	10+90.00	6.00' LT	597.38 (F)
M	10+90.00	6.00' LT	597.63 (C)
N	10+92.34	6.18' LT	597.52 (F)
O	10+92.34	6.18' LT	597.55 (C)

POINT	STATION	OFFSET	ELEVATION
AA	10+45.00	24.23' RT	(594.72)(F)
AB	10+45.00	24.23' RT	(595.28)(C)
AC	10+50.00	23.72' RT	594.75 (F)
AD	10+50.00	23.72' RT	595.35 (C)
AE	10+53.04	23.41' RT	594.84 (F)
AF	10+53.04	23.41' RT	595.39 (C)
AG	10+60.00	22.70' RT	595.33 (F)
AH	10+60.00	22.70' RT	595.58 (C)
AI	10+70.41	21.74' RT	596.03 (F)
AJ	10+70.41	21.74' RT	596.28 (C)
AK	10+70.41	9.25' RT	595.97 (F)
AL	10+70.41	9.25' RT	596.22 (C)
AM	10+70.41	7.59' RT	596.02 (F)
AN	10+70.41	7.59' RT	596.27 (C)
AO	10+80.00	6.85' RT	596.82 (F)
AP	10+80.00	6.85' RT	597.07 (C)
AQ	10+90.00	6.07' RT	597.65 (F)
AR	10+90.00	6.07' RT	597.90 (C)
AS	10+90.84	6.00' RT	597.72 (F)
AT	10+90.84	6.00' RT	597.97 (C)
AU	10+92.34	6.00' RT	597.84 (F)
AV	10+92.34	6.00' RT	597.87 (C)

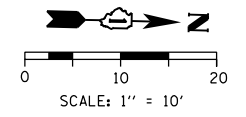

NOTES:

- SEE DRAINAGE SCHEDULE AND PLANS FOR STRUCTURE INFORMATION.
- SEE CURB RAMP DETAILS FOR ADA RAMP INFORMATION.
- CURB HEIGHT IS 8" UNLESS OTHERWISE NOTED OR INDICATED ON THE CURB RAMP DETAILS.
- ALL ELEVATIONS AND GRADES NOT SHOWN SHALL FOLLOW THE TYPICAL SECTIONS AND PROFILES.
- ALL INTERSECTION PAVEMENT ELEVATIONS INSIDE OF THE HARRISON STREET EDGES OF PAVEMENT ARE CONTROLLED BY PROFILE AND CROSS SLOPES OF HARRISON STREET.
- ELEVATIONS ARE PROVIDED AT FLOW LINE (F) AND TOP OF CURB (C) UNLESS OTHERWISE NOTED.
- DRIVEWAY PAVEMENT LATERAL GROOVING SHALL BE APPLIED AT THE DRIVEWAY TO IMPROVE TRACTION. THIS WORK SHALL BE INCLUDED IN THE COST OF THE PCC DRIVEWAY PAVT 8 PAY ITEM. NO ADDITIONAL COMPENSATION WILL BE ALLOWED.
- THE ELEVATION AT THE DOOR ENTRANCE SHALL MEET EXISTING.
- THE ELEVATIONS ALONG THE TOP OF EXISTING RETAINING WALL SHALL BE FIELD VERIFIED.

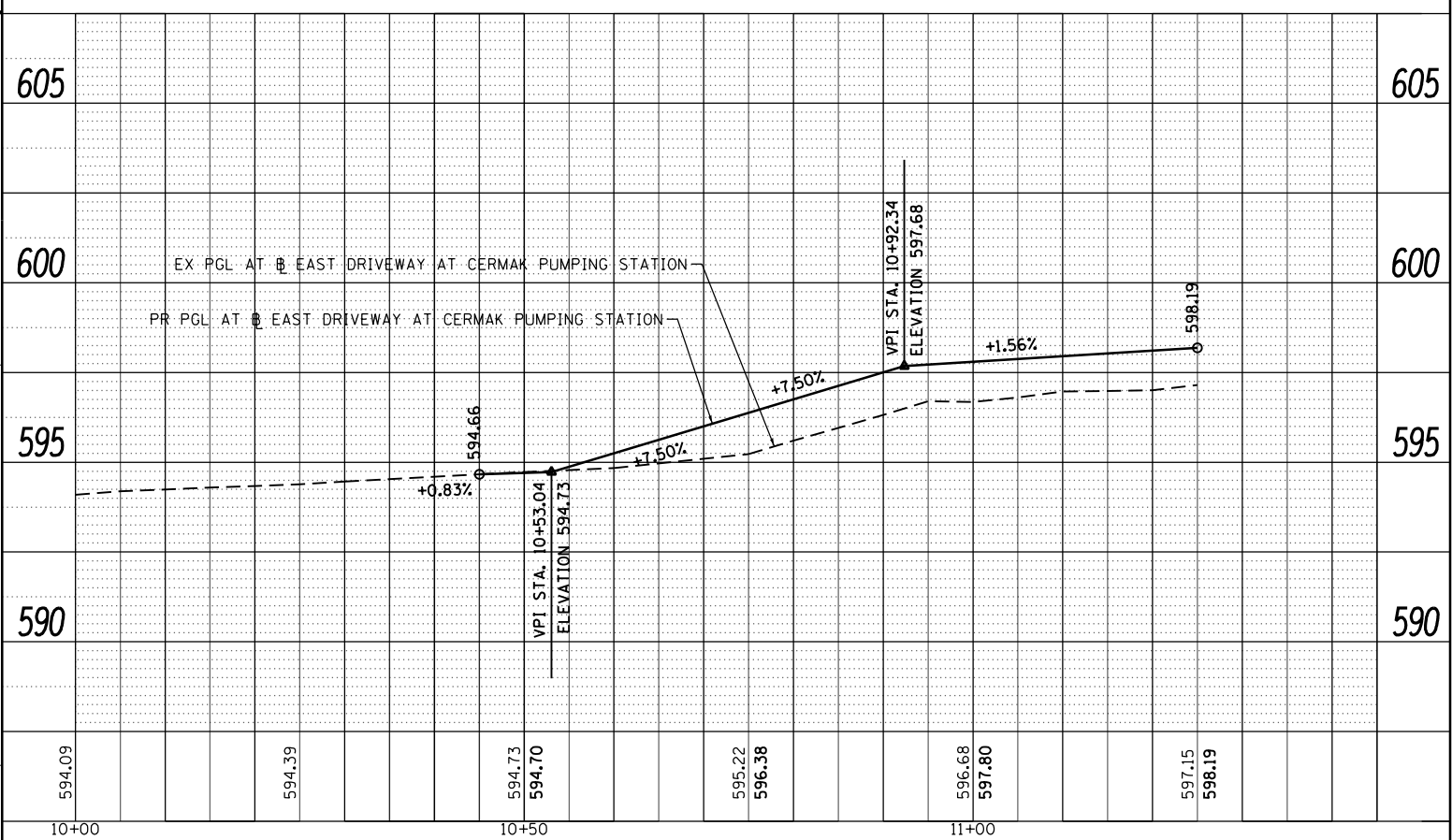

D160W71-sht-intersec-01
 USER NAME = chiue
 PLOT SCALE = 20.0000' / in.
 PLOT DATE = 2/21/2014

DESIGNED - AFC
 DRAWN - AFC
 CHECKED - DBM
 DATE - 02/19/14

REVISED -
 REVISED -
 REVISED -
 REVISED -

STATE OF ILLINOIS
 DEPARTMENT OF TRANSPORTATION

ROADWAY AND GRADING PLAN DETAILS
 HARRISON STREET

SCALE: 1" = 10' SHEET 2 OF 3 SHEETS STA. TO STA.

F.A.I. RTE.	SECTION	COUNTY	TOTAL SHEETS	SHEET NO.
90/94/290	2013-036R	COOK	256	58A
CONTRACT NO. 60W71				
ILLINOIS FED. AID PROJECT				