

LEGEND

PAVEMENT MARKING MATERIAL

- EPOXY PAVEMENT MARKING
- ◇ PAVEMENT MARKING TAPE, TYPE III
- THERMOPLASTIC PAVEMENT MARKING
- △ POLYUREA PAVEMENT MARKING TYPE I

PAVEMENT MARKING TYPE

- A - LETTERS AND SYMBOLS (WHITE)
- B - 4" WHITE EDGE LINE
- C - 4" YELLOW LINE
- D - 4" DOUBLE YELLOW CENTERLINE
- E - 4" WHITE (6' DASH, 18' SKIP)
- F - 4" YELLOW (6' DASH, 18' SKIP)
- G - 4" WHITE (2' DASH, 6' SKIP)
- H - 5" WHITE (10' DASH, 30' SKIP)
- I - 6" WHITE SOLID LINE
- J - 6" WHITE (2' DASH, 6' SKIP)
- K - 6" WHITE 45° DIAGONALS SPACED @ 20' CENTERS
- L - 8" WHITE EDGE LINE
- M - 12" WHITE (2' DASH, 2' SKIP)
- N - 12" WHITE 45° DIAGONALS SPACED @ 20' CENTERS
- O - 12" WHITE 45° DIAGONALS SPACED @ 30' CENTERS
- P - 12" WHITE 45° DIAGONALS SPACED @ 500' CENTERS
- Q - 12" YELLOW 45° DIAGONALS SPACED @ 50' CENTERS
- R - 12" YELLOW 45° DIAGONALS SPACED @ 500' CENTERS
- S - 12" WHITE CHEVRONS SPACED @ 30' CENTERS
- T - 24" WHITE STOP BAR
- U - 24" WHITE CROSSWALK, 6' WIDTH, SPACED @ 4' CENTERS
- Y - RAISED REFLECTIVE PAVEMENT MARKER (1-WAY YELLOW / OPAQUE)
- Z - RAISED REFLECTIVE PAVEMENT MARKER (1-WAY CRYSTAL / OPAQUE)

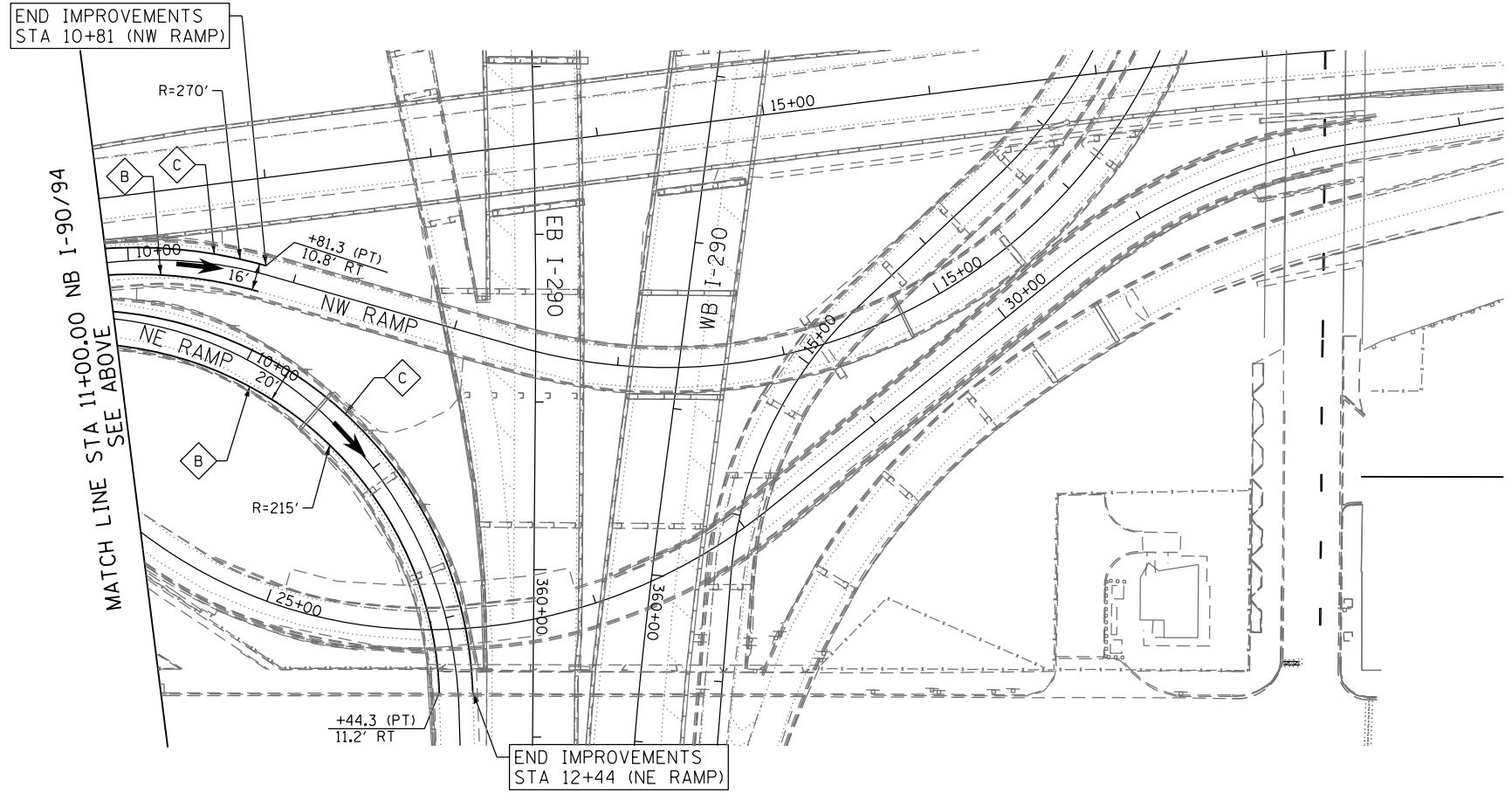
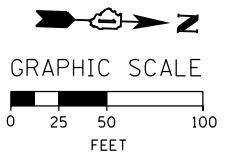

PAVEMENT MARKING NOTES

1. ALL FINAL PAVEMENT MARKING MATERIALS PLACED ON PCC PAVEMENT SHALL BE POLYUREA TYPE I EXCEPT WHERE NOTED IN THE PLANS.
2. ALL FINAL PAVEMENT MARKING MATERIALS PLACED ON BITUMINOUS PAVEMENT SHALL BE THERMOPLASTIC EXCEPT WHERE NOTED IN THE PLANS.
3. ALL FINAL PAVEMENT MARKING SYMBOLS SHALL BE OF SMALL SIZE.
4. ALL DAMAGE TO EXISTING PAVEMENT MARKINGS OR RAISED REFLECTIVE PAVEMENT MARKERS OUTSIDE OF THE IMPROVEMENT LIMITS SHOWN ON THE PLANS SHALL BE REPLACED AT THE CONTRACTOR'S EXPENSE.
5. BEFORE BEGINNING ANY WORK, THE CONTRACTOR SHALL RECORD AND RETAIN ALL EXISTING PAVEMENT MARKINGS AND MARKERS FOR FUTURE REFERENCE. EXACT LOCATIONS OF ALL PAVEMENT MARKINGS SHALL BE DIRECTED BY THE ENGINEER.
6. THE RESIDENT ENGINEER SHALL CONTACT EXPRESSWAY TRAFFIC CONTROL SUPERVISOR AT 847-705-4155 AND ARTERIAL TRAFFIC CONTROL SUPERVISOR AT 847-705-4470 A MINIMUM OF 2 WEEKS PRIOR TO PLACEMENT OF PERMANENT PAVEMENT MARKINGS.
7. SEE PAVEMENT MARKING DETAIL SHEETS FOR ADDITIONAL INFORMATION.

FILE PATH = p:\388035-p\m\1\escomon\me\local\PMACD\00\Documents\01_Americas\Transportation\6269938_Circle\Phase_1\000_CAD\005_Roadway\Sheets\60W71_Contract\0160W71-Sht-PMK-ML-01.dgn



D160W71-Sht-PMK-ML-01.dgn
 USER NAME = pimsarno
 PLOT SCALE = 100.0000' / 1"
 PLOT DATE = 2/19/2014

DESIGNED - OPS	REVISED -
DRAWN - OPS	REVISED -
CHECKED - DBM	REVISED -
DATE - 02/19/14	REVISED -

STATE OF ILLINOIS
DEPARTMENT OF TRANSPORTATION

PAVEMENT MARKING PLANS
INTERSTATE AND RAMPS
 SCALE: 1" = 50' SHEET 1 OF 1 SHEETS STA. TO STA.

F.A.I. RTE.	SECTION	COUNTY	TOTAL SHEETS	SHEET NO.
90/94/290	2013-036R	COOK	256	68
CONTRACT NO. 60W71				
ILLINOIS FED. AID PROJECT				