

**PLAN**

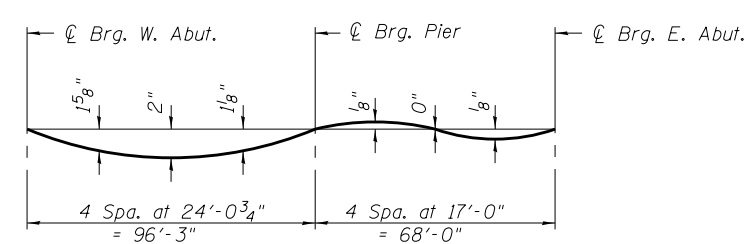

**DEAD LOAD DEFLECTION DIAGRAM**

(Includes weight of concrete deck, sidewalk, parapet and railing)

Note:  
The above deflections are not to be used in the field if the engineer is working from the grade elevations adjusted for dead load deflections as shown on sheets S-09 thru S-13 of S-47.

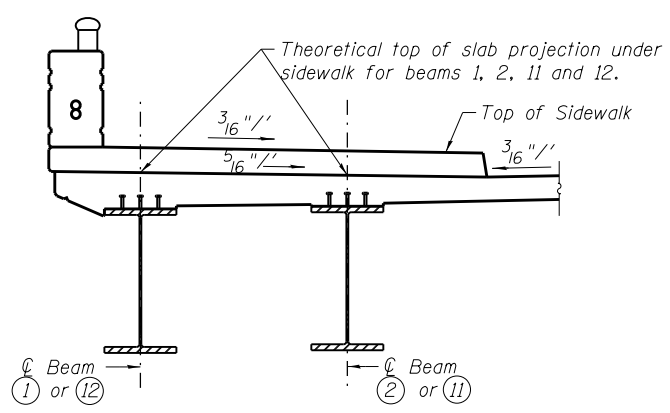

**PROJECTION UNDER SIDEWALK**  
(Typ. both sides)

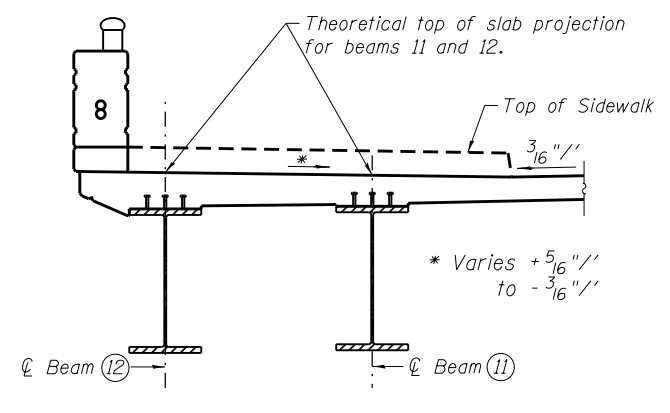

**PROJECTION OF DECK AT SIDEWALK RAMP**  
(Southwest Corner)

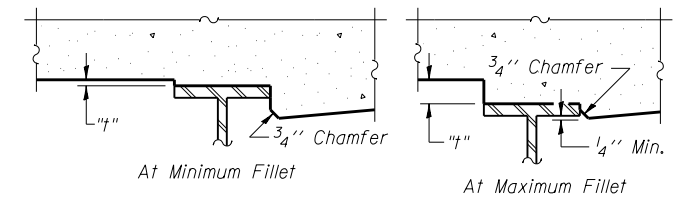

To determine "t": After all structural steel has been erected, elevations of the top flanges of the beams shall be taken at intervals shown above. These elevations subtracted from the "Theoretical Grade Elevations Adjusted for Dead Load Deflection" shown on Sheets S-09 thru S-13 of S-47, minus slab thickness, equals the fillet heights "t" above top flange of beams.

**FILLET HEIGHTS**

0161711-60W71-S08-TopSlab



USER NAME = dunkerleyb	DESIGNED - MK	REVISED
	CHECKED - DD	REVISED
PLOT SCALE = N.T.S.	DRAWN - BRD	REVISED
PLOT DATE = 12/17/2013	CHECKED - DD	REVISED

**STATE OF ILLINOIS  
DEPARTMENT OF TRANSPORTATION**

**TOP OF SLAB ELEVATION PLAN  
STRUCTURE NO. 016-1711**

SHEET NO. S-08 OF S-47 SHEETS

F.A.I. RTE. 90/94/290	SECTION 2013-036R	COUNTY COOK	TOTAL SHEETS 256	SHEET NO. 100
CONTRACT NO. 60W71				ILLINOIS FED. AID PROJECT -NUMBER-