

FOR INFORMATION ONLY

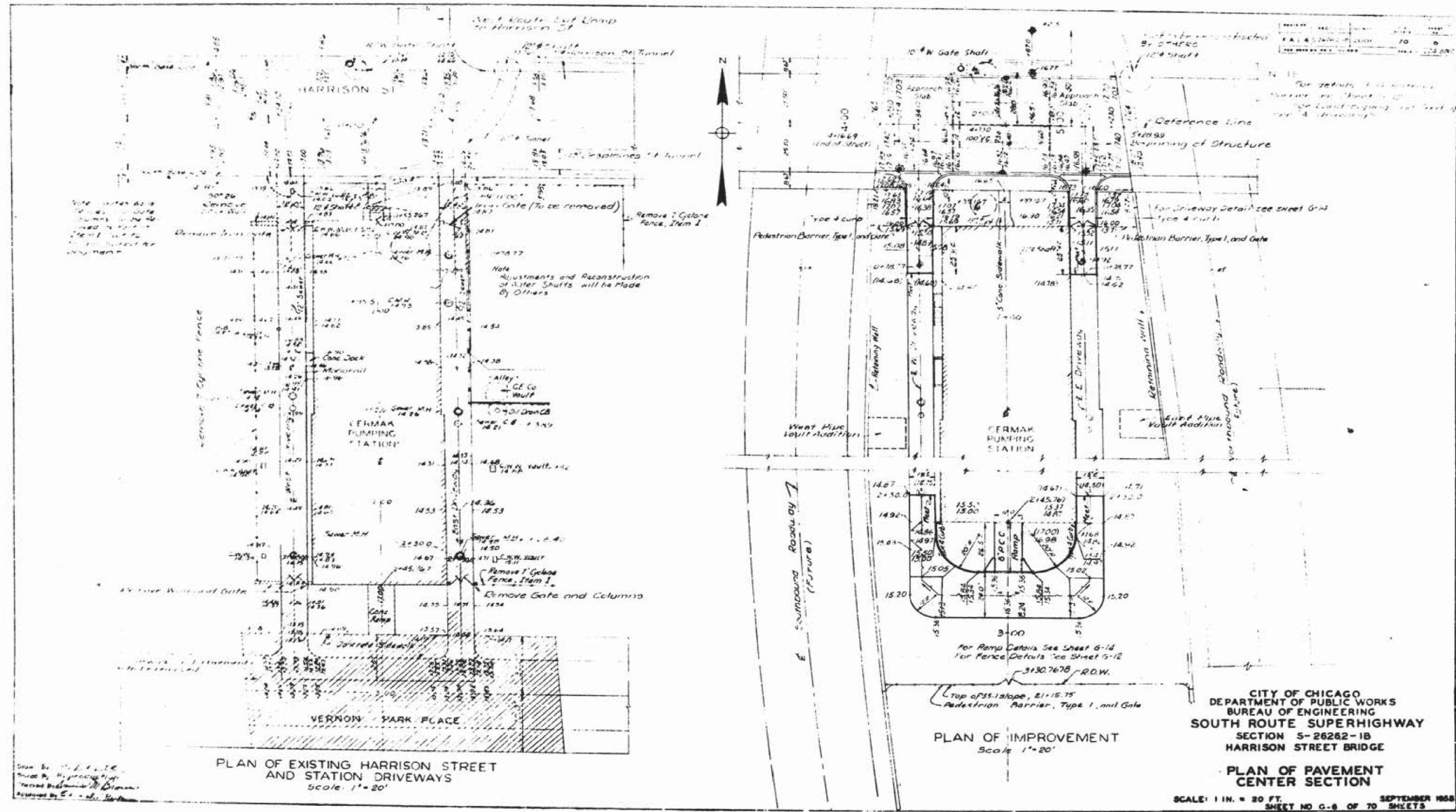

D:\60W71-sht-AS-BUILT-69.dgn

| | | |
|------------------------|------------|-----------|
| USER NAME = dunkerleyb | DESIGNED - | REVISED - |
| | CHECKED - | REVISED - |
| PLOT SCALE = N.T.S. | DRAWN - | REVISED - |
| PLOT DATE = 11/26/2013 | CHECKED - | REVISED - |

STATE OF ILLINOIS
DEPARTMENT OF TRANSPORTATION

EXISTING AS-BUILTS SN 016-1088

SHEET NO. AS-69 OF AS-72 SHEETS

| | | | | |
|------------------------------------|-----------|--------|--------------|-----------|
| F.A.I. RTE. | SECTION | COUNTY | TOTAL SHEETS | SHEET NO. |
| 90/94/290 | 2013-036R | COOK | 256 | 211 |
| CONTRACT NO. 60W71 | | | | |
| ILLINOIS FED. AID PROJECT -NUMBER- | | | | |

CITY OF CHICAGO
DEPARTMENT OF PUBLIC WORKS
BUREAU OF ENGINEERING
SOUTH ROUTE SUPERHIGHWAY
SECTION 5-2622-1B
HARRISON STREET BRIDGE

PLAN OF PAVEMENT
CENTER SECTION

SCALE: 1 IN. = 20 FT. SEPTEMBER 1988
SHEET NO. G-6 OF 70 SHEETS