

FILE PATH = p:\388035-paint\escomon\me\local\p\AEC\000\Documents\01_Americas\Transportation\62629938_Circle\Phase_1\1000_CAD\005_Roadway_Sheets\60W71_Contract\0160W71-sht-Drain-Detail-01

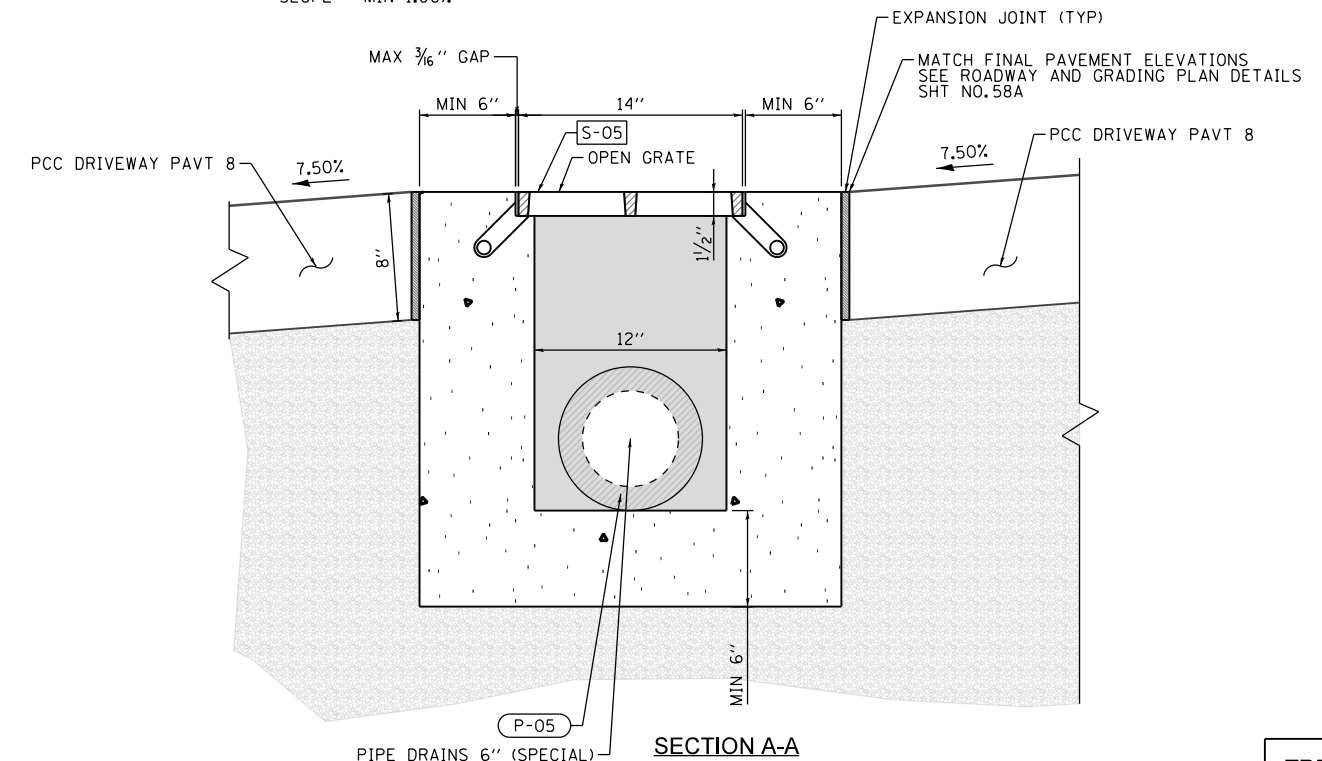

NOTES:

1. SEE DRAINAGE SCHEDULES FOR RIM AND INVERT ELEVATIONS.
2. THE GRATE USED FOR THE TRENCH DRAIN WILL BE INCLUDED IN THE COST OF TRENCH DRAIN.
3. OUTLET PIPES AND PREFORMED CHANNEL INVERTS SHALL BE SLOPED AT 1.00% OR STEEPER TOWARD OUTLET REGARDLESS OF THE SURFACE SLOPE.
4. TRENCH EXCAVATION MUST ALLOW FOR A MINIMUM OF 6 INCHES OF CONCRETE TO BE PLACED UNDER AND ALONGSIDE THE TRENCH DRAIN SYSTEM.
5. TRENCH DRAINS SHALL BE IN ACCORDANCE WITH THE MANUFACTURERS DETAILS AND SPECIFICATIONS.
6. PROVIDE 1/2" EXPANSION JOINT WITH PREFORMED JOINT FILLER BETWEEN PAVEMENT AND TRENCH DRAIN ENCASEMENT. THIS WILL BE INCLUDED IN THE COST OF TRENCH DRAIN.

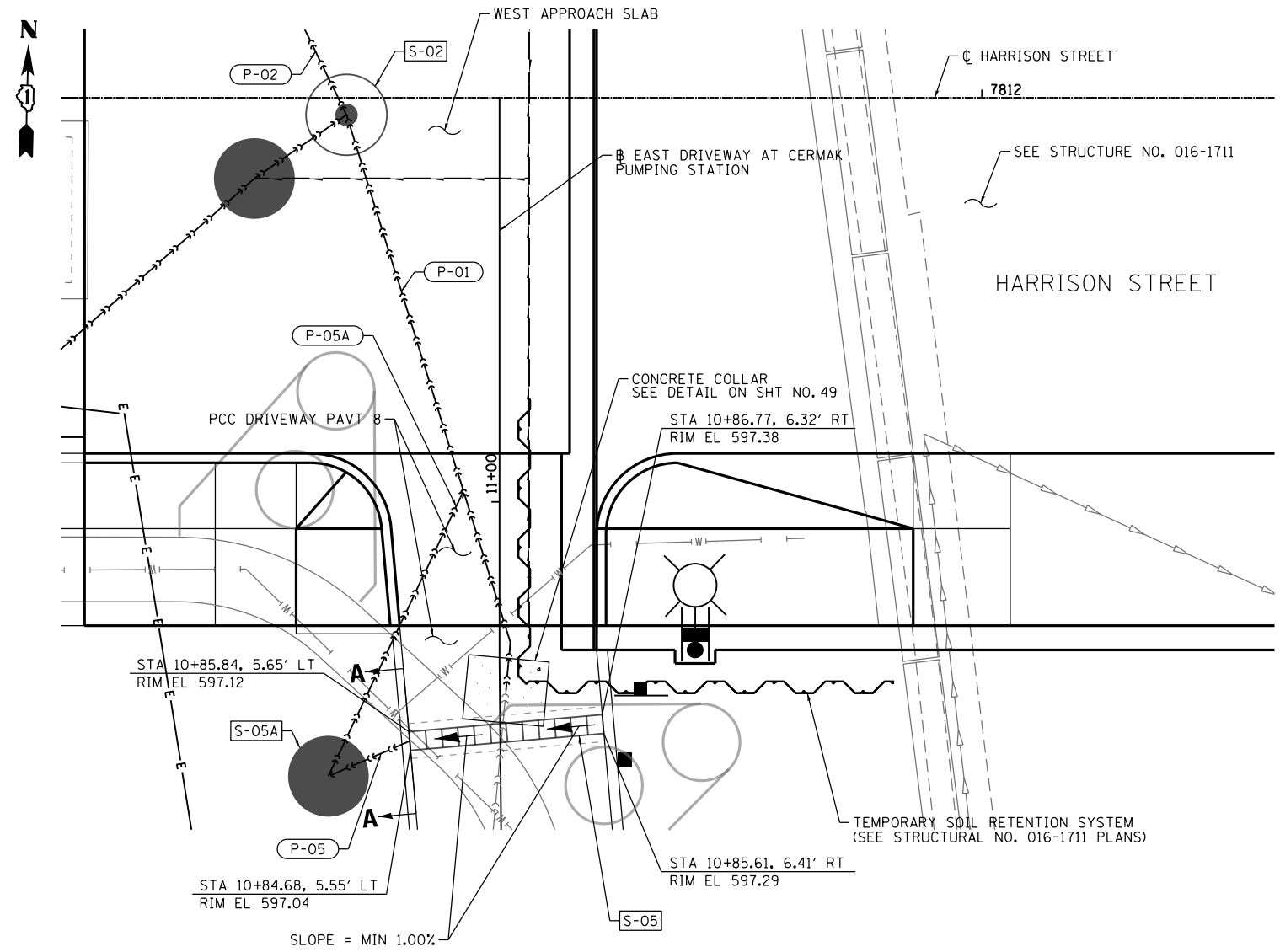

D160W71-sht-Drain-Detail-01	DESIGNED - AFC	REVISED -
USER NAME = chiue	DRAWN - AFC	REVISED -
PLOT SCALE = 10.0000' / in.	CHECKED - EY	REVISED -
PLOT DATE = 2/21/2014	DATE - 02/19/14	REVISED -

**STATE OF ILLINOIS
DEPARTMENT OF TRANSPORTATION**

**DRAINAGE DETAILS
TRENCH DRAIN**

SCALE: NTS SHEET 1 OF 2 SHEETS STA. TO STA.

F.A.I. RTE.	SECTION	COUNTY	TOTAL SHEETS	SHEET NO.
90/94/290	2013-036R	COOK	256	252
CONTRACT NO. 60W71				
ILLINOIS FED. AID PROJECT				

TRENCH DRAIN