

TEMPORARY TRAFFIC SIGNAL NOTES

- 53' OF THIS CONDUIT RUN SHALL BE CAPPED AND MAINTAINED FOR USE IN THE PERMANENT TRAFFIC SIGNAL INSTALLATION. EXISTING CABLES SHALL BE REMOVED FROM THE CONDUIT.
- 62' OF THIS CONDUIT RUN SHALL BE CAPPED AND MAINTAINED FOR USE IN THE PERMANENT TRAFFIC SIGNAL INSTALLATION. EXISTING CABLES SHALL BE REMOVED FROM THE CONDUIT.
- THESE SIGNAL POSTS SHALL BE RELOCATED TO THE PROPOSED TRAFFIC SIGNAL INSTALLATION.

THE FOLLOWING ITEMS SHALL BE REMOVED BY THE CONTRACTOR AND SHALL BE DISPOSED OF BY THEM OUTSIDE THE RIGHT-OF-WAY AT THEIR EXPENSE. THE SALVAGE VALUE OF THE REMOVED EQUIPMENT SHALL BE REFLECTED IN THE CONTRACT BID PRICE.

- 8 EACH SIGNAL POST
- 2 EACH STEEL MAST ARM ASSEMBLY AND POLE
- 1 EACH ALUMINUM MAST ASSEMBLY AND POLE
- 1 EACH SERVICE INSTALLATION
- 10 EACH SIGNAL HEAD, 1-FACE, 3-SECTION
- 1 EACH SIGNAL HEAD, 1-FACE, 5-SECTION
- 3 EACH SIGNAL HEAD, 2-FACE, 3-SECTION
- 1 EACH SIGNAL HEAD, 2-FACE, 1-3 SECTION, 1-5 SECTION
- 7 EACH TRAFFIC SIGNAL BACKPLATE
- 1 EACH CONTROLLER AND CABINET (COMPLETE)

THE FOLLOWING ITEMS SHALL BE REMOVED BY THE CONTRACTOR AND SHALL BE RELOCATED TO THE PROPOSED TRAFFIC SIGNAL INSTALLATION. THE CONTRACTOR SHALL MAKE ALL NECESSARY CONNECTIONS TO ENSURE PROPER OPERATION OF THE RELOCATED EQUIPMENT.

- 2 EACH PEDESTRIAN SIGNAL HEAD, 1-FACE
- 2 EACH PEDESTRIAN PUSH-BUTTON
- 1 EACH SIGNAL POST

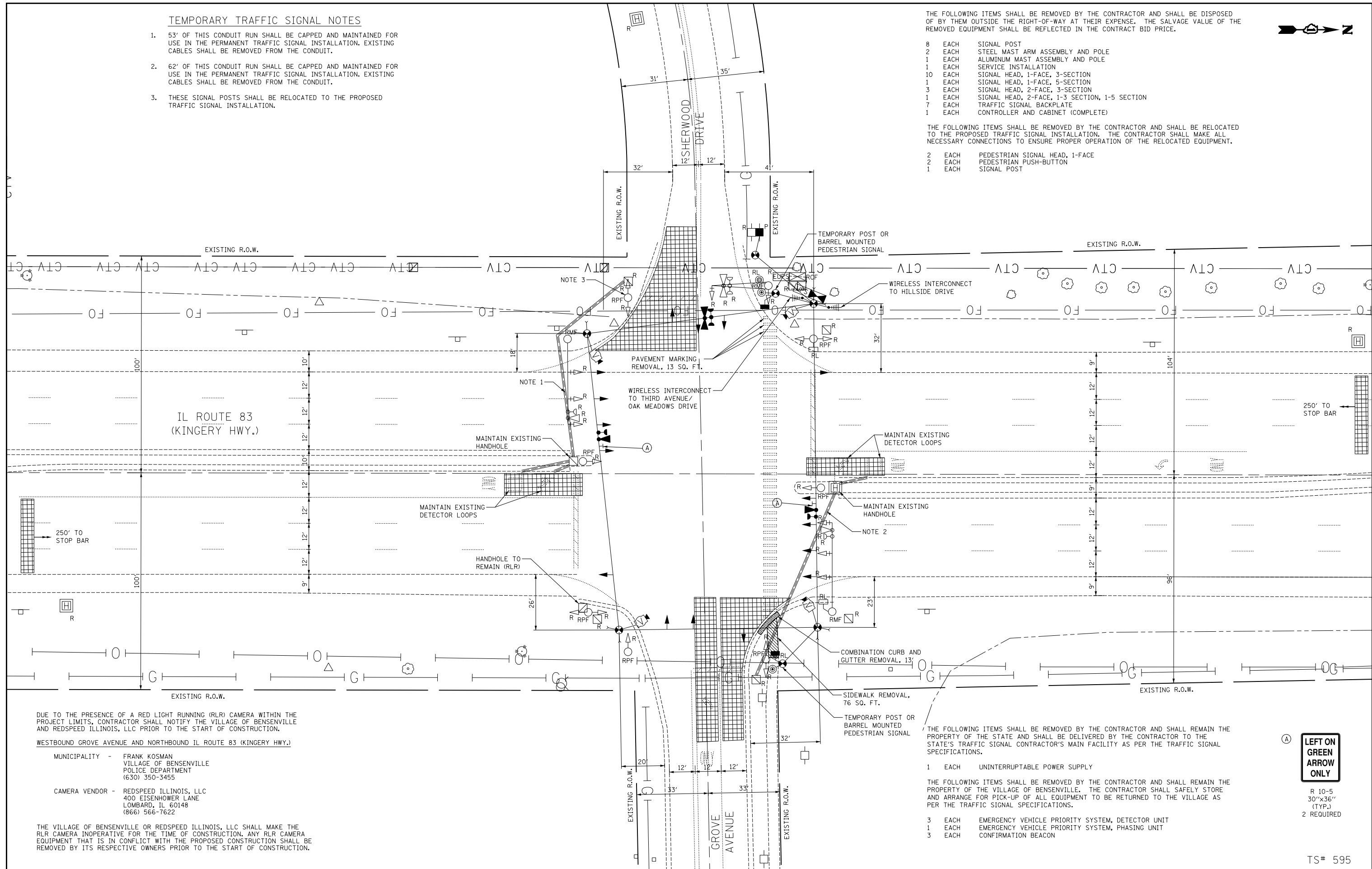

DUE TO THE PRESENCE OF A RED LIGHT RUNNING (RLR) CAMERA WITHIN THE PROJECT LIMITS, CONTRACTOR SHALL NOTIFY THE VILLAGE OF BENSenville AND REDSPEED ILLINOIS, LLC PRIOR TO THE START OF CONSTRUCTION.

WESTBOUND GROVE AVENUE AND NORTHBOUND IL ROUTE 83 (KINGERY HWY.)

MUNICIPALITY - FRANK KOSMAN
VILLAGE OF BENSenville
POLICE DEPARTMENT
(630) 350-3455

CAMERA VENDOR - REDSPEED ILLINOIS, LLC
400 EISENHOWER LANE
LOMBARD, IL 60148
(866) 566-7622

THE VILLAGE OF BENSenville OR REDSPEED ILLINOIS, LLC SHALL MAKE THE RLR CAMERA INOPERATIVE FOR THE TIME OF CONSTRUCTION. ANY RLR CAMERA EQUIPMENT THAT IS IN CONFLICT WITH THE PROPOSED CONSTRUCTION SHALL BE REMOVED BY ITS RESPECTIVE OWNERS PRIOR TO THE START OF CONSTRUCTION.

THE FOLLOWING ITEMS SHALL BE REMOVED BY THE CONTRACTOR AND SHALL REMAIN THE PROPERTY OF THE STATE AND SHALL BE DELIVERED BY THE CONTRACTOR TO THE STATE'S TRAFFIC SIGNAL CONTRACTOR'S MAIN FACILITY AS PER THE TRAFFIC SIGNAL SPECIFICATIONS.

- 1 EACH UNINTERRUPTABLE POWER SUPPLY

THE FOLLOWING ITEMS SHALL BE REMOVED BY THE CONTRACTOR AND SHALL REMAIN THE PROPERTY OF THE VILLAGE OF BENSenville. THE CONTRACTOR SHALL SAFELY STORE AND ARRANGE FOR PICK-UP OF ALL EQUIPMENT TO BE RETURNED TO THE VILLAGE AS PER THE TRAFFIC SIGNAL SPECIFICATIONS.

- 3 EACH EMERGENCY VEHICLE PRIORITY SYSTEM, DETECTOR UNIT
- 1 EACH EMERGENCY VEHICLE PRIORITY SYSTEM, PHASING UNIT
- 3 EACH CONFIRMATION BEACON

LEFT ON GREEN ARROW ONLY

R 10-5
30"x36"
(TYP.)
2 REQUIRED

TS# 595



USER NAME = jrt	DESIGNED - BRD	REVISED -
	DRAWN - JRT	REVISED -
PLOT SCALE = 40.0000' / in.	CHECKED - JJE	REVISED -
PLOT DATE = 1/30/2014	DATE - 01/30/2014	REVISED -

**STATE OF ILLINOIS
DEPARTMENT OF TRANSPORTATION**

**TEMPORARY TRAFFIC SIGNAL INSTALLATION AND REMOVAL PLAN
IL ROUTE 83 (KINGERY HWY.) AT GROVE AVENUE /SHERWOOD DRIVE**

SCALE: 1" = 20' SHEET NO. 1 OF 1 SHEETS STA. TO STA.

F.A.P. RTE.	SECTION	COUNTY	TOTAL SHEETS	SHEET NO.
344	2013-063TS	DUPAGE	68	29
CONTRACT NO. 60X35				
ILLINOIS FED. AID PROJECT				