

TEMPORARY TRAFFIC SIGNAL NOTES

- 73' OF THIS CONDUIT RUN SHALL BE CAPPED AND MAINTAINED FOR USE IN THE PERMANENT TRAFFIC SIGNAL INSTALLATION. EXISTING CABLES SHALL BE REMOVED FROM THE CONDUIT.
- 61' OF THIS CONDUIT RUN SHALL BE CAPPED AND MAINTAINED FOR USE IN THE PERMANENT TRAFFIC SIGNAL INSTALLATION. EXISTING CABLES SHALL BE REMOVED FROM THE CONDUIT.
- THESE SIGNAL POSTS SHALL BE RELOCATED TO THE PROPOSED TRAFFIC SIGNAL INSTALLATION.

THE FOLLOWING ITEMS SHALL BE REMOVED BY THE CONTRACTOR AND SHALL BE DISPOSED OF BY THEM OUTSIDE THE RIGHT-OF-WAY AT THEIR EXPENSE. THE SALVAGE VALUE OF THE REMOVED EQUIPMENT SHALL BE REFLECTED IN THE CONTRACT BID PRICE.

- 6 EACH SIGNAL POST
- 2 EACH ALUMINUM MAST ARM ASSEMBLY AND POLE
- 1 EACH SERVICE INSTALLATION
- 2 EACH SIGNAL HEAD, 1-FACE, 5-SECTION
- 2 EACH SIGNAL HEAD, 2-FACE, 1-3 SECTION, 1-5 SECTION
- 2 EACH TRAFFIC SIGNAL BACKPLATE

THE FOLLOWING ITEMS SHALL BE REMOVED BY THE CONTRACTOR AND SHALL BE RELOCATED TO THE PROPOSED TRAFFIC SIGNAL INSTALLATION. THE CONTRACTOR SHALL MAKE ALL NECESSARY CONNECTIONS TO ENSURE PROPER OPERATION OF THE RELOCATED EQUIPMENT.

- 1 EACH CONTROLLER
- 6 EACH SIGNAL HEAD, 1-FACE, 3-SECTION
- 2 EACH SIGNAL HEAD, 2-FACE, 2-3 SECTION
- 2 EACH PEDESTRIAN SIGNAL HEAD, 1-FACE
- 2 EACH PEDESTRIAN PUSH-BUTTON
- 3 EACH EMERGENCY VEHICLE PRIORITY SYSTEM, DETECTOR UNIT
- 1 EACH EMERGENCY VEHICLE PRIORITY SYSTEM, PHASING UNIT
- 2 EACH SIGNAL POST
- 3 EACH CONFIRMATION BEACON

THE FOLLOWING ITEMS SHALL BE REMOVED BY THE CONTRACTOR, SHALL REMAIN THE PROPERTY OF THE STATE AND SHALL BE DELIVERED BY THE CONTRACTOR TO THE STATE'S TRAFFIC SIGNAL CONTRACTOR'S MAIN FACILITY AS PER THE TRAFFIC SIGNAL SPECIFICATIONS.

- 1 EACH CONTROLLER CABINET, TYPE IV
- 1 EACH UNINTERRUPTIBLE POWER SUPPLY

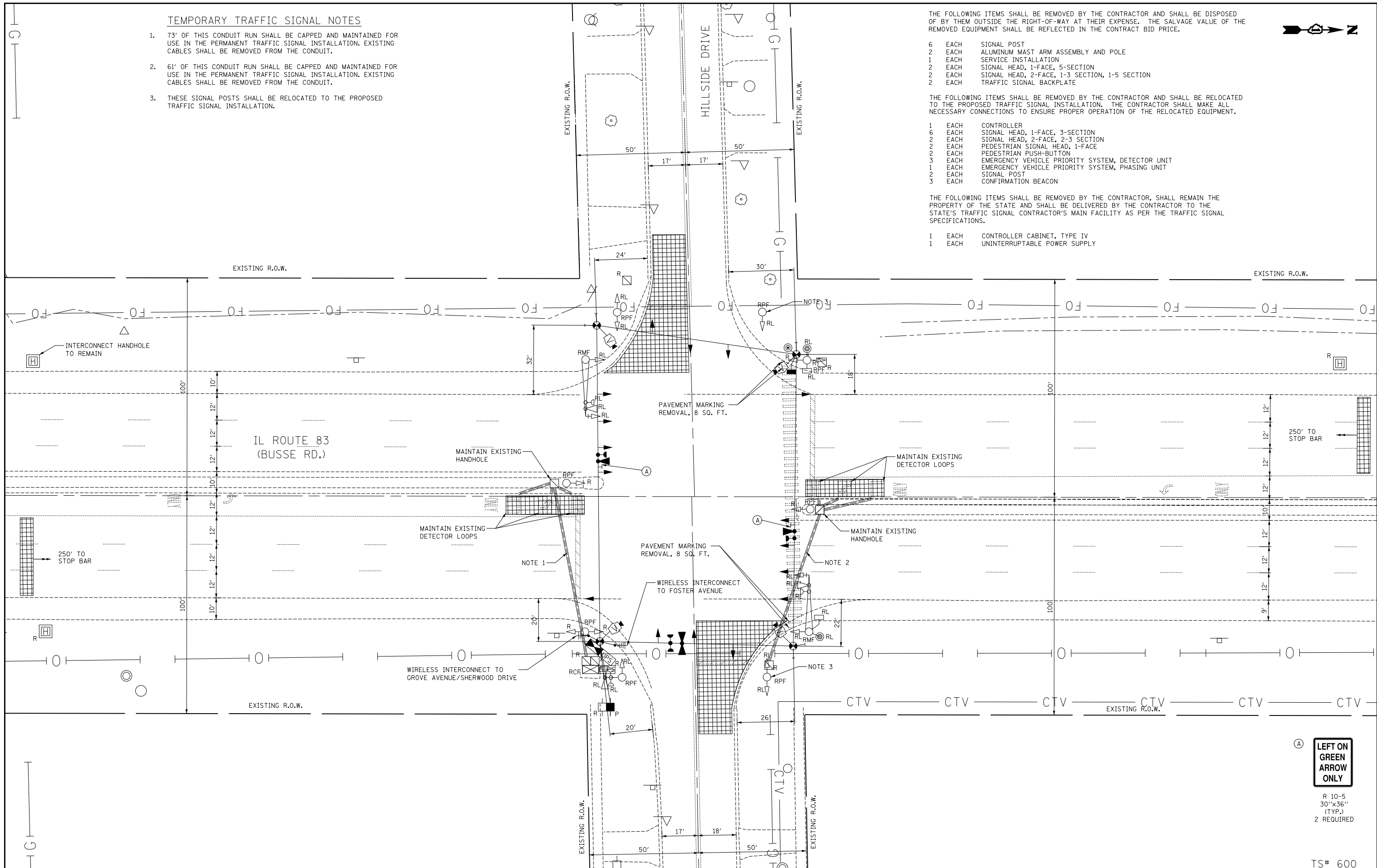
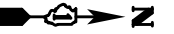

**LEFT ON GREEN
ARROW
ONLY**

R 10-5
30"x36"
(TYP.)
2 REQUIRED

TS# 600



USER NAME = jrt	DESIGNED - BRD	REVISED -
	DRAWN - JRT	REVISED -
PLOT SCALE = 40.0000' / in.	CHECKED - JJE	REVISED -
PLOT DATE = 1/29/2014	DATE - 01/30/2014	REVISED -

**STATE OF ILLINOIS
DEPARTMENT OF TRANSPORTATION**

**TEMPORARY TRAFFIC SIGNAL INSTALLATION AND REMOVAL PLAN
IL ROUTE 83 (BUSSE RD.) AT HILLSIDE DRIVE**

SCALE: 1" = 20' SHEET NO. 1 OF 1 SHEETS STA. TO STA.

F.A.P. RTE.	SECTION	COUNTY	TOTAL SHEETS	SHEET NO.
344	2013-063TS	DUPAGE	68	34
CONTRACT NO. 60X35				
ILLINOIS FED. AID PROJECT				