



SCHEDULE OF QUANTITIES

MOVEMENT	6 ↓			2 ↑			8 ←			F L A S H
	2+6			4+8						
PHASE	2+6			4+8						
INTERVAL	1	2A	2B	3	4A	4B				
CHANGE TO	/			4+8			/			
				2+6						
EAST END AVENUE ALL SIGNALS	N/B	G	Y	R	R	R	R	R	R	R
EAST END AVENUE ALL SIGNALS	S/B	G	Y	R	R	R	R	R	R	R
26TH STREET ALL SIGNALS	E/B	R	R	R	G	Y	R	R	R	R
26TH STREET ALL SIGNALS	W/B	R	R	R	G	Y	R	R	R	R

SEQUENCE OF OPERATION

Items	Unit	Quantity
MAINTENANCE OF EXISTING TRAFFIC SIGNAL INSTALLATION	EACH	1
TRAFFIC SIGNAL POST, GALVANIZED STEEL 14 FT.	EACH	2
TRAFFIC SIGNAL POST, GALVANIZED STEEL 15 FT.	EACH	1
TRAFFIC SIGNAL POST, GALVANIZED STEEL 18 FT.	EACH	1
SIGNAL HEAD, LED, 1-FACE, 3-SECTION, MAST-ARM MOUNTED	EACH	3
SIGNAL HEAD, LED, 1-FACE, 4-SECTION, MAST ARM MOUNTED	EACH	1
SIGNAL HEAD, LED, 2-FACE, 3-SECTION, BRACKET MOUNTED	EACH	3
SIGNAL HEAD, LED, 2-FACE, 1-3 SECTION, 1-4 SECTION, BRACKET MOUNTED	EACH	1
TRAFFIC SIGNAL BACKPLATE, LOUVERED, ALUMINUM	EACH	4
MODIFY EXISTING CONTROLLER CABINET	EACH	1
REMOVE EXISTING TRAFFIC SIGNAL EQUIPMENT	EACH	1
UNINTERRUPTABLE POWER SUPPLY, SPECIAL	EACH	1

CHANGE FROM NORMAL SEQUENCE OF OPERATION INTERVAL NUMBER	1		3		PREEMPTOR NUMBER 3					CLEAR TO NORMAL SEQUENCE
	1A	1B	1C	1D	2	3	4	5		
RAILROAD PREEMPTION SEQUENCE OF OPERATION INTERVAL NUMBER										
CHANGE TO RAILROAD PREEMPTION SEQUENCE OF OPERATION INTERVAL NUMBER	1B	2	1D	2	3	4	5			
EAST END AVENUE ALL SIGNALS	N/B	Y	R	R	R	R	R	G	△	
EAST END AVENUE ALL SIGNALS	S/B	Y	R	R	R	R	R	G	△	
26TH STREET ALL SIGNALS	E/B	R	R	G	G	←G	Y	R	△	
26TH STREET ALL SIGNALS	W/B	R	R	Y	R	R	R	R	△	
INTERNALLY ILLUMINATED SIGNS	NLT	NLT	NLT	NLT	NLT	NLT	NLT	NLT	△	
INTERNALLY ILLUMINATED SIGNS	NRT	NRT	NRT	NRT	NRT	NRT	NRT	NRT	△	

RAILROAD PREEMPTION SEQUENCE OF OPERATION

NLT=NO LEFT TURN OR
NRT=NO RIGHT TURN OR
HOLD

△ RAILROAD PREEMPTION SEQUENCE SHALL PROVIDE THE PROPER CLEARANCE INTERVAL TO RESUME THE NORMAL SEQUENCE OF OPERATION OR PROPER CLEARANCE INTERVAL TO DISPLAY AN EMERGENCY VEHICLE INTERVAL (IF APPLICABLE) AFTER RAILROAD PREEMPTION INTERVAL 5 IS TERMINATED.

NOTES

- ALL COSTS RELATED TO ATTACHING THE POSTS TO THE EXISTING FOUNDATION SHALL BE INCLUDED IN THE UNIT COST OF TRAFFIC SIGNAL POST OF THE SIZE SPECIFIED
- PRIOR TO REMOVING ANY TRAFFIC SIGNAL POST SPECIFIED TO BE REPLACED IN THE SAME LOCATION THE CONTRACTOR SHALL VERIFY THAT THE PATTERN, SPACING, AND CONDITION OF THE EXISTING BOLTS ARE SUITABLE FOR RE-USE WITH A NEW POST. IF THE BOLTS ARE NOT USABLE, REPLACE AS DIRECTED BY THE ENGINEER.
- THE CONTRACTOR SHALL RELOCATE EXISTING SIGN PANELS, INCLUDING BLANK OUT SIGNS, FROM POSTS THAT ARE INDICATED FOR REPLACEMENT TO THE NEW POSTS AS SHOWN ON THE PLANS OR AS DIRECTED BY THE ENGINEER. THE COST OF REMOVAL, RELOCATION AND ANY NEW MOUNTING HARDWARE NECESSARY TO COMPLETE THIS WORK SHALL BE INCLUDED IN THE UNIT COST OF TRAFFIC SIGNAL POST OF THE SIZE SPECIFIED.

I. D. O. T. TRAFFIC SIGNAL INSTALLATION ELECTRICAL SERVICE REQUIREMENTS				
TYPE	NO. LAMPS	WATTAGE INCAND.	WATTAGE LED	TOTAL WATTAGE
SIGNAL (RED)	12		17	102.0
(YELLOW)	12		25	75.0
(GREEN)	12		15	45.0
ARROW	2		12	6.0
CONTROLLER	1	100		100.0
BATTERY BACKUP	1	25		25.0
TOTAL =				353.0

ENERGY COSTS- BILLED TO: IDOT DISTRICT 1
201 WEST CENTER COURT
SCHAUMBURG, IL 60196-1096

ENERGY SUPPLY- CONTACT BRAD SHINABARGAR
PHONE 708-325-2692
COMMONWEALTH EDISON

FILE NAME = D:\60X64-sh-t-153740.dgn	USER NAME = SE3	DESIGNED - WSA	REVISED -
Default	PLOT SCALE = 40.0000' / in.	DRAWN - WSA	REVISED -
	PLOT DATE = 2/3/2014	CHECKED - BKS	REVISED -
		DATE - \$SUBDATE	REVISED -

STATE OF ILLINOIS
DEPARTMENT OF TRANSPORTATION

EAST END AVENUE /26TH STREET - CABLE PLAN AND
SCHEDULE OF QUANTITIES, PHASE DESIG. DIAGRAM & EVP SEQUENCE

SCALE: SHEET OF SHEETS STA. TO STA.

F.A. RTE.	SECTION	COUNTY	TOTAL SHEETS	SHEET NO.
	2013-075TS	COOK	78	42
CONTRACT NO. 60X64				
ILLINOIS FED. AID PROJECT				

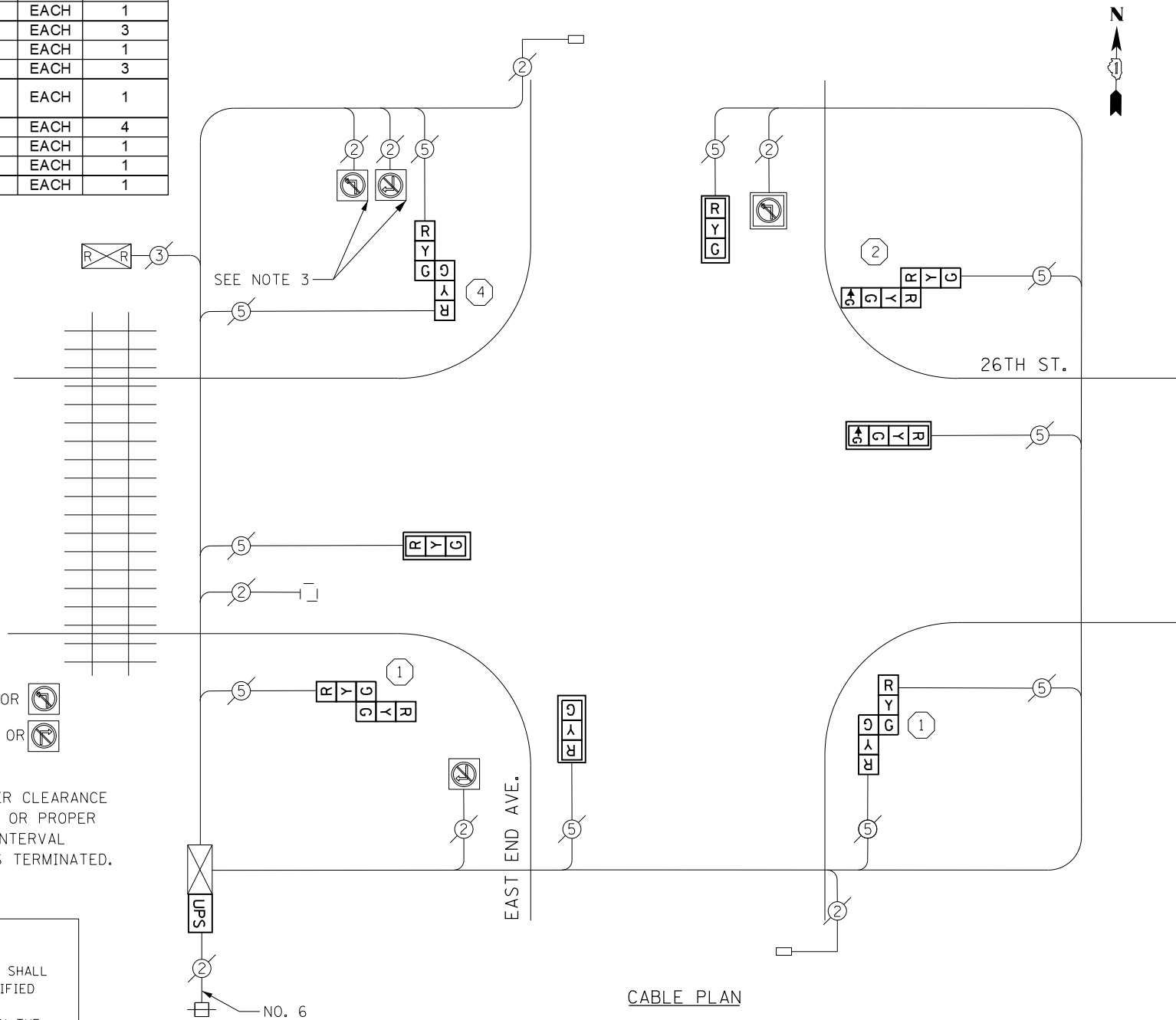

CABLE PLAN

CONSTRUCTION NOTES

- THE CONTRACTOR SHALL REPLACE THE EXISTING TRAFFIC SIGNAL POST WITH THE PROPOSED TRAFFIC SIGNAL POST, 14 FT. AND ATTACH THE PROPOSED POST TO THE EXISTING FOUNDATION.
- THE CONTRACTOR SHALL REPLACE THE EXISTING TRAFFIC SIGNAL POST WITH THE PROPOSED TRAFFIC SIGNAL POST, 15 FT. AND ATTACH THE PROPOSED POST TO THE EXISTING FOUNDATION.
- THE CONTRACTOR SHALL REPLACE THE EXISTING TRAFFIC SIGNAL POST WITH THE PROPOSED TRAFFIC SIGNAL POST, 18 FT. AND ATTACH THE PROPOSED POST TO THE EXISTING FOUNDATION.

REMOVAL OF EXISTING TRAFFIC SIGNAL EQUIPMENT

THE FOLLOWING ITEMS SHALL BE REMOVED BY THE CONTRACTOR AND SHALL BE DISPOSED OF BY THEM OUTSIDE THE RIGHT-OF-WAY AT THEIR EXPENSE. THE SALVAGE VALUE OF THE REMOVED EQUIPMENT SHALL BE REFLECTED IN THE CONTRACT BID PRICE.

3	EACH	TRAFFIC SIGNAL POST
3	EACH	SIGNAL HEAD, 1-FACE, 3-SECTION
1	EACH	SIGNAL HEAD, 1-FACE, 4-SECTION
1	EACH	SIGNAL HEAD, 2-FACE, 1-4 SECTION, 1-3 SECTION
3	EACH	SIGNAL HEAD, 2-FACE, 3-SECTION
4	EACH	PEDESTRIAN SIGNAL HEAD, 1-FACE
4	EACH	PEDESTRIAN PUSH-BUTTON

TS 3740
CHICAGO HEIGHTS