

STAGE IB DECK PATCHING SCHEDULE

STRUCTURE NO.	LANE NO.	PARTIAL-DEPTH PATCHING SQ YD	FULL-DEPTH PATCHING SQ YD	LANE CLOSURE
016-0036	---	---	---	
016-1045	---	---	---	
016-1048	---	---	---	
016-1052	2	2.2	0	LANE 2 SB
016-1055	---	---	---	
016-1075	2	26.9	0	LANE 2 NB

* SPAN SP 1 TO SP 7

NOTE:



SOME PARTIAL-DEPTH PATCHES MAY REQUIRE FULL-DEPTH PATCHING BASED ON FIELD CONDITIONS

STAGE IB TRAFFIC CONTROL NOTES

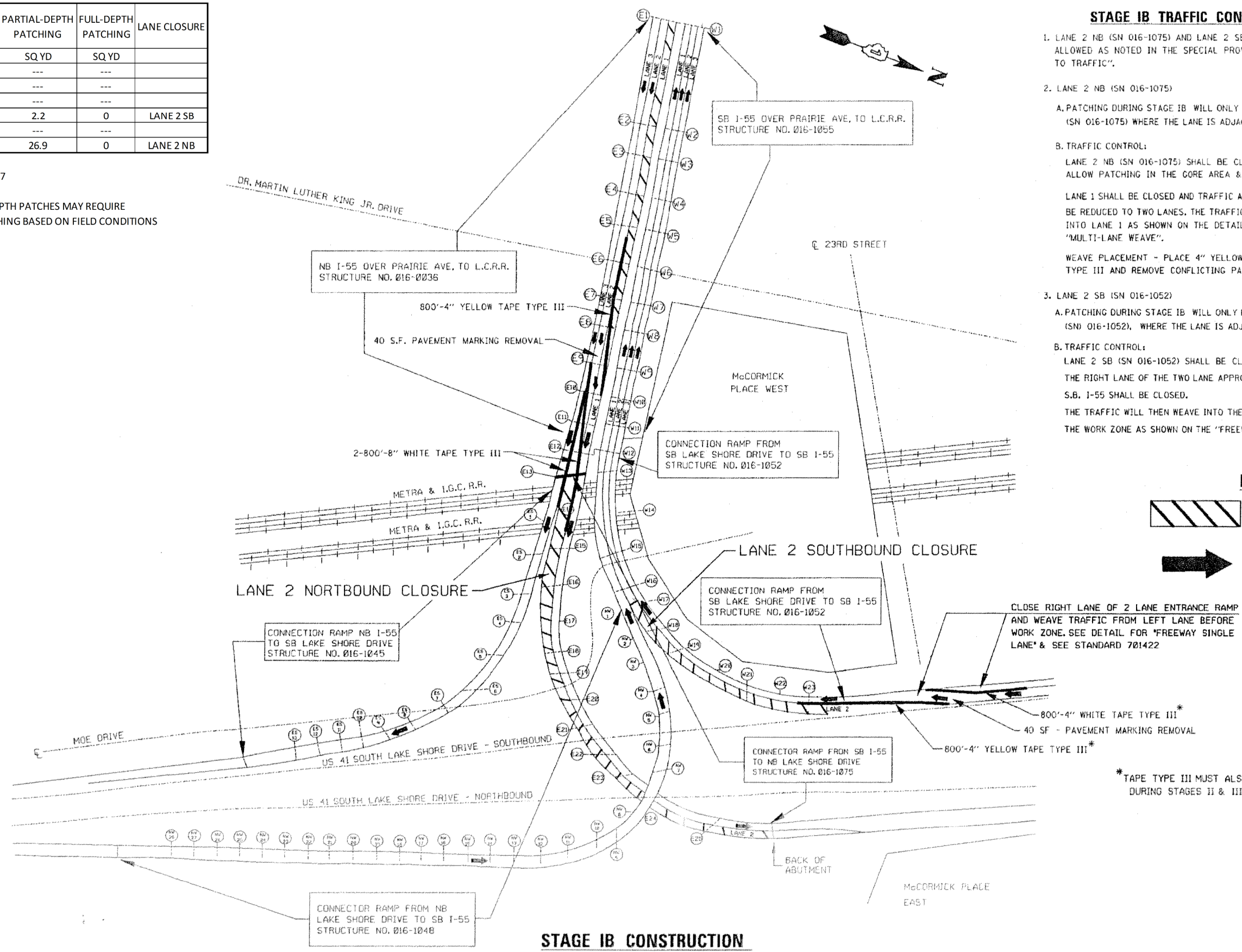
- LANE 2 NB (SN 016-1075) AND LANE 2 SB (SN 016-1052) CLOSURES WILL BE ALLOWED AS NOTED IN THE SPECIAL PROVISION "KEEPING EXPRESSWAY OPEN TO TRAFFIC".
- LANE 2 NB (SN 016-1075)
 - PATCHING DURING STAGE IB WILL ONLY BE ALLOWED IN THE RIGHT LANE OF (SN 016-1075) WHERE THE LANE IS ADJACENT TO THE PARAPET WALL.
 - TRAFFIC CONTROL:
 - LANE 2 NB (SN 016-1075) SHALL BE CLOSED AS SHOWN. LOCATE WEAVE TO ALLOW PATCHING IN THE GORE AREA & LANE 2 ADJACENT TO THE GORE AREA.
 - LANE 1 SHALL BE CLOSED AND TRAFFIC APPROACHING THE WORK ZONE SHALL BE REDUCED TO TWO LANES. THE TRAFFIC IN LANE 2 WILL THEN BE WEAVED INTO LANE 1 AS SHOWN ON THE DETAIL FOR "FREEWAY SINGLE LANE" & "MULTI-LANE WEAVE".
 - WEAVE PLACEMENT - PLACE 4" YELLOW AND 8" WHITE PAVEMENT MARKING TAPE, TYPE III AND REMOVE CONFLICTING PAVEMENT MARKINGS.
- LANE 2 SB (SN 016-1052)
 - PATCHING DURING STAGE IB WILL ONLY BE ALLOWED IN THE LEFT LANE OF (SN 016-1052), WHERE THE LANE IS ADJACENT TO THE PARAPET WALL.
 - TRAFFIC CONTROL:
 - LANE 2 SB (SN 016-1052) SHALL BE CLOSED AS SHOWN.
 - THE RIGHT LANE OF THE TWO LANE APPROACH TO RAMP FROM S.B. U.S. 41 TO S.B. I-55 SHALL BE CLOSED.
 - THE TRAFFIC WILL THEN WEAVE INTO THE RIGHT LANE (LANE 3) OF THE RAMP BEFORE THE WORK ZONE AS SHOWN ON THE "FREEWAY SINGLE LANE WEAVE" DETAIL.



LEGEND:

-  WORK ZONE OR LANE CLOSURE
-  TRAFFIC DIRECTION

* TAPE TYPE III MUST ALSO BE PLACED DURING STAGES II & IIIA

STAGE IB CONSTRUCTION

FILE NAME =	USER NAME = osbornnp	DESIGNED -	REVISED -	STATE OF ILLINOIS DEPARTMENT OF TRANSPORTATION	SUGGESTED STAGE IB CONSTRUCTION I-55 (STEVENSON EXPRESSWAY) AT US-41 (LAKE SHORE DRIVE)				F.A.I. RTE. = 55	SECTION = 2014-018BR	COUNTY = COOK	TOTAL SHEETS = 33	SHEET NO. = 6
Default	c:\p\work\p\dot\osbornnp\d0382528\016414-shr-cover.dgn	DRAWN -	REVISED -		SCALE: SHEET OF SHEETS STA. TO STA.	CONTRACT NO. 60X91							
	PLOT SCALE = 2.0000' / in.	CHECKED -	REVISED -			ILLINOIS FED. AID PROJECT							
	PLOT DATE = 3/20/2014	DATE -	REVISED -										