

NOTES:

1. ALL SIGN DIMENSIONS ARE SHOWN IN INCHES.
2. THE COST OF PROVIDING AND REMOVING THE DETOUR SIGNING SHALL BE INCLUDED IN THE BID PRICE FOR "TRAFFIC CONTROL AND PROTECTION (EXPRESSWAYS)".
3. ALL DETOUR AND DIRECTION SIGNS SHALL BE ORANGE WITH BLACK LETTERS & SYMBOLS.
4. SIGN M1-1 SHALL BE BLUE AND RED WITH WHITE LETTERS. SIGN M1-4 SHALL BE WHITE WITH BLACK LETTERS.

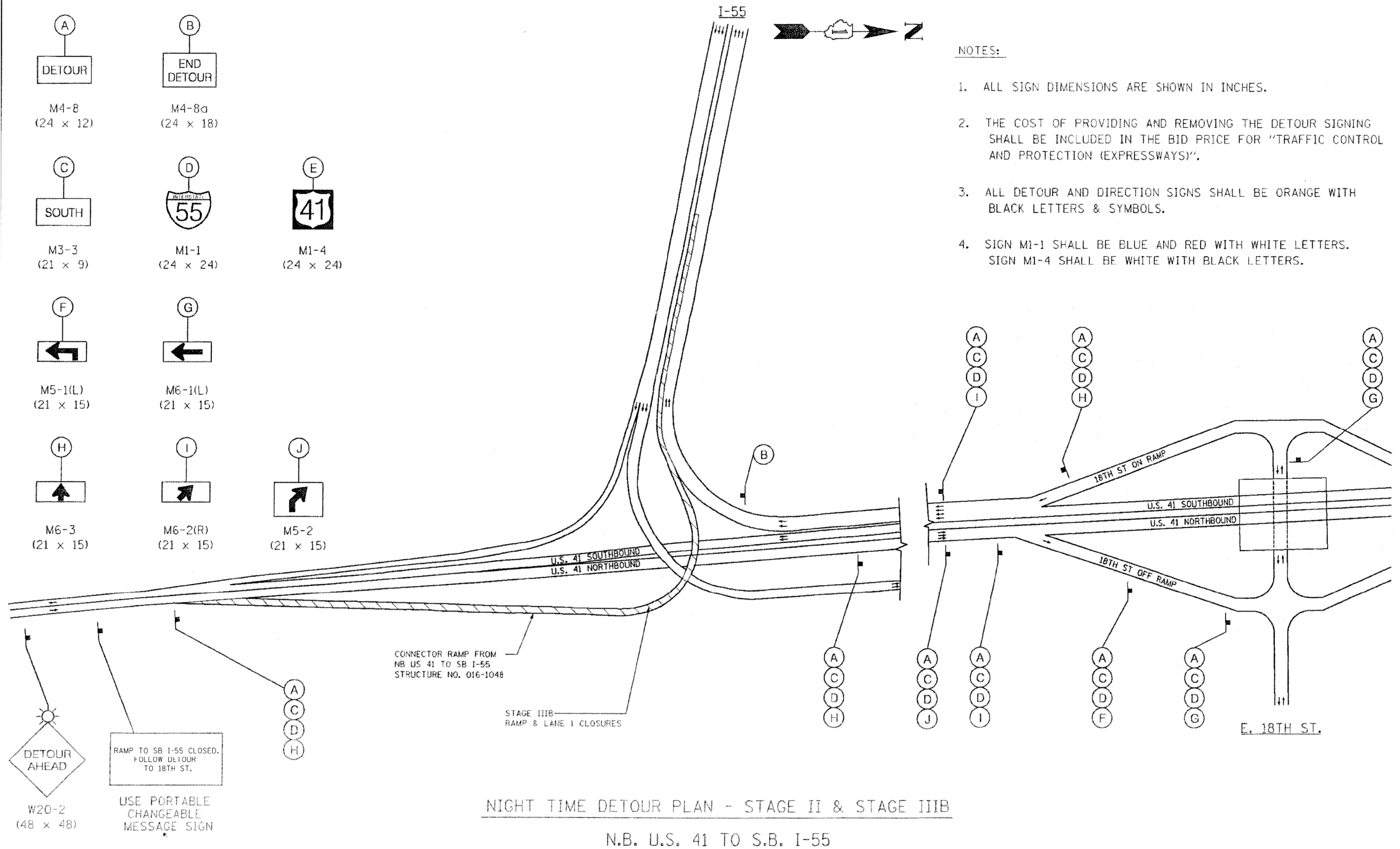

NIGHT TIME DETOUR PLAN - STAGE II & STAGE IIIB
N.B. U.S. 41 TO S.B. I-55

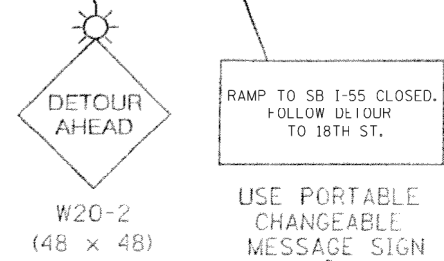

FILE NAME =	USER NAME = osbornnp	DESIGNED -	REVISED -	STATE OF ILLINOIS DEPARTMENT OF TRANSPORTATION	NIGHT TIME DETOUR PLAN - STAGE II & STAGE IIIB I-55 (STEVENSON EXPRESSWAY) AT US-41 (LAKE SHORT DRIVE)	F.A.I. RTE.	SECTION	COUNTY	TOTAL SHEETS	SHEET NO.	
ci:\p\work\p\idot\osbornnp\d0382528\016414-shr-cover.dgn	PLOT SCALE = 2.0000' / in.	DRAWN -	REVISED -			55	2014-018BR	COOK	33	12	
Default	PLOT DATE = 4/1/2014	CHECKED -	REVISED -			CONTRACT NO. 60X91					
		DATE -	REVISED -			ILLINOIS FED. AID PROJECT					