

ELEVATION - N.B. ROADWAY

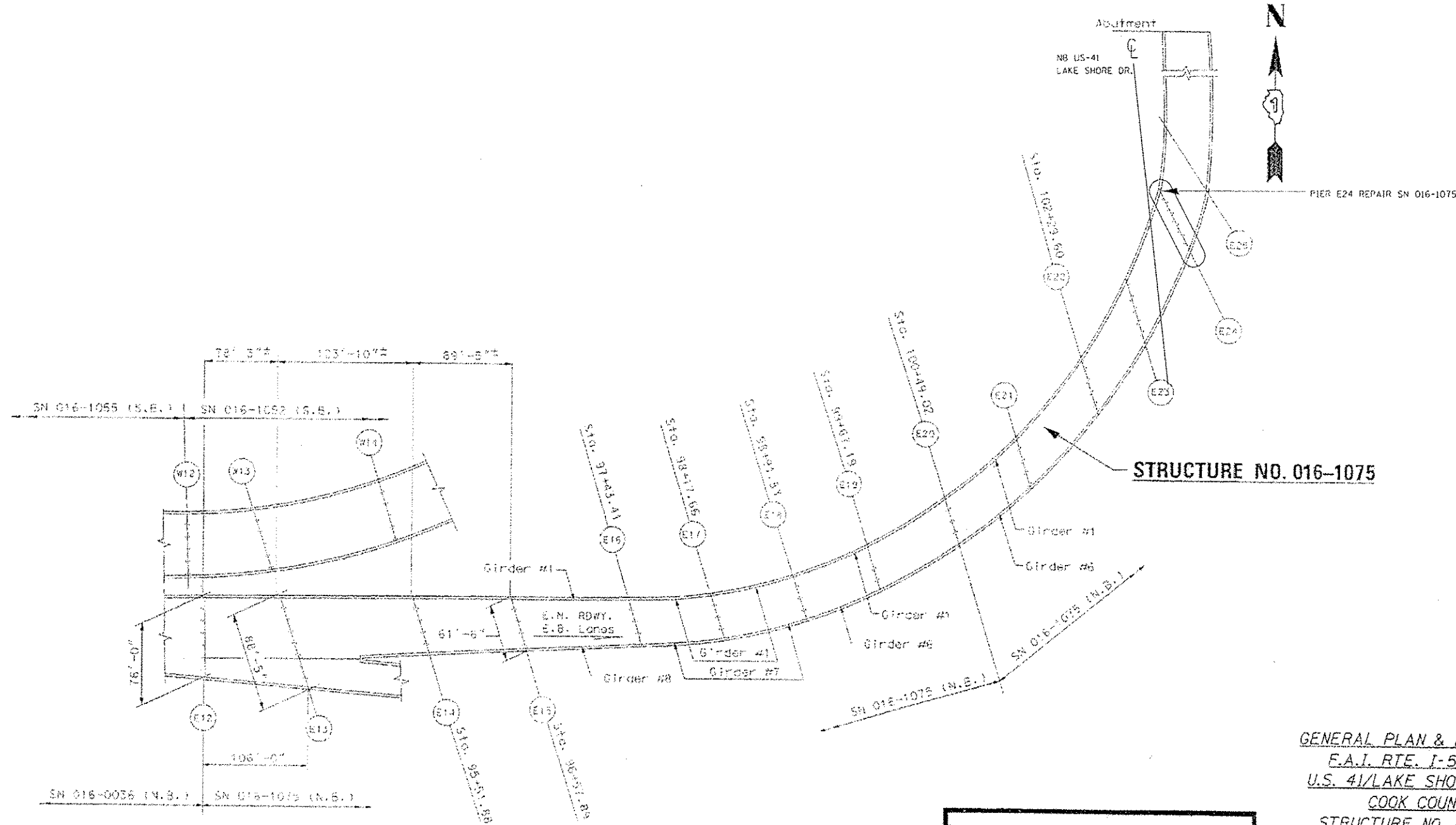

PLAN

FOR INFORMATION ONLY

GENERAL PLAN & ELEVATION
 E.A.I. RTE. I-55 OVER
 U.S. 41/LAKE SHORE DRIVE
 COOK COUNTY
 STRUCTURE NO. 016-1075



David Carl Puzey 3/27/14
Expires 11/30/14

FILE NAME: c:\p-work\p-ws\d\osborne\08382528\016414-snt-cover.dgn	USER NAME: osborne	DESIGNED: JAH	REVISED:	STATE OF ILLINOIS DEPARTMENT OF TRANSPORTATION	GENERAL PLAN AND ELEVATION - S.N. 016-1075 I-55 (STEVENSON EXPRESSWAY) AT US-41 (LAKE SHORE DRIVE)			F.A.I. RTE. 55	SECTION 2014-018BR	COUNTY COOK	TOTAL SHEETS 33	SHEET NO. 25
Default	PLOT SCALE: 2.0000 1/16"	CHECKED: FR	REVISED:		SCALE: SHEET OF SHEETS STA. TO STA.	CONTRACT NO. 60X91			ILLINOIS FED. AID PROJECT			
	PLOT DATE: 3/28/2014	DATE:	REVISED:									