

FOR INFORMATION ONLY

071-0025 vch

Benchmark: Chiseled 'O' on top of S.E. Wingwall of Existing Structure El. 684.28
 Existing Structure: 3-Span RC Deck, continuous RC, arched girder bridge, RC pier on concrete footings + 28'-0" clear deck width, Gross Structure length = 100'-6", Piers to be re-used, Exist Structure No. 071-0025
 Traffic is to be maintained during construction utilizing Stage Construction

Note: Existing Substructure Removal is indicated by Estimated Abutment Concrete Removal - 50.8 cu. yd.

Traffic Barrier Terminal Std 2341-Type 6 (All Four Corners)

EA 742	OGLE	40	15	SHEET 1
				16 SHEETS

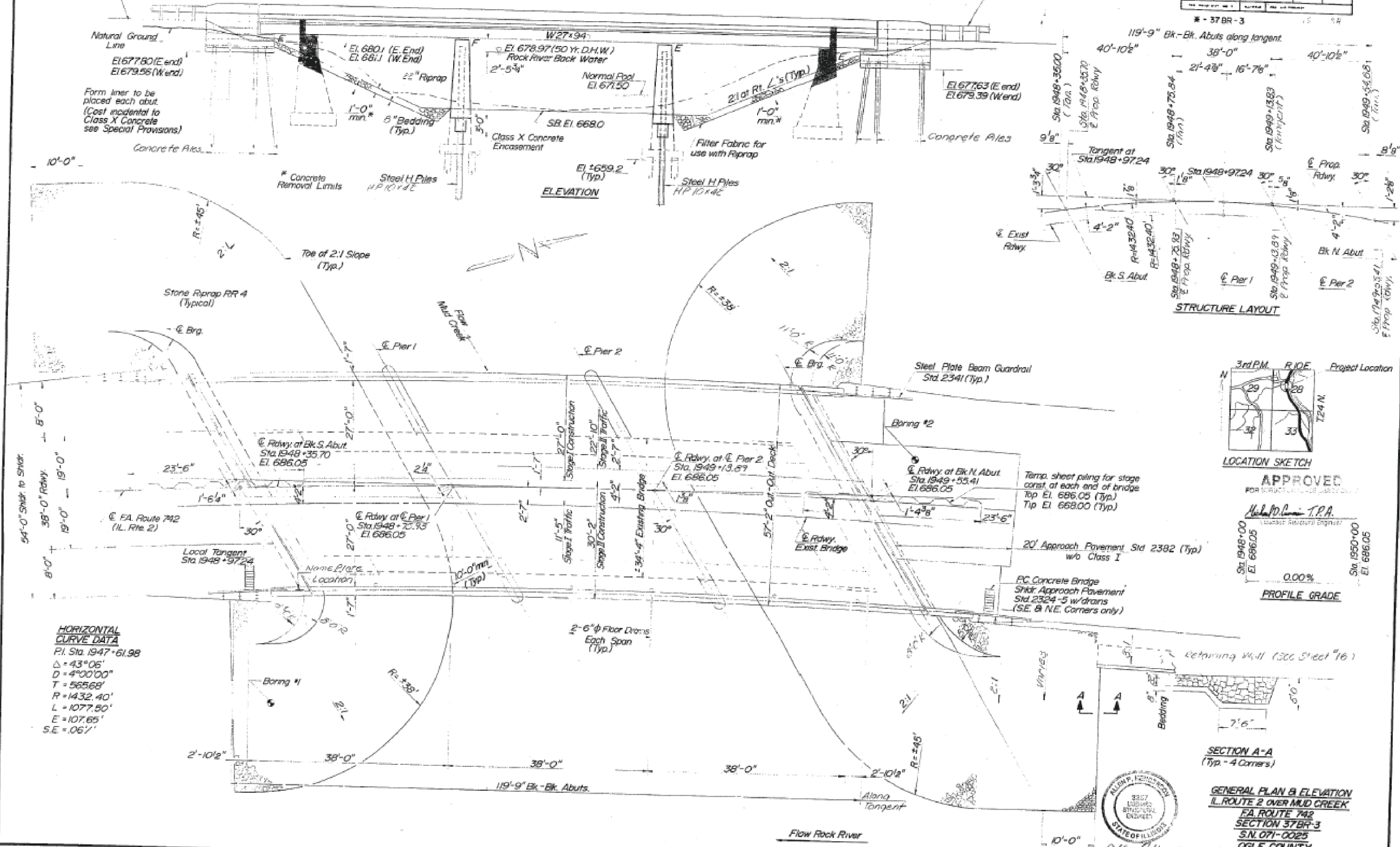

HORIZONTAL CURVE DATA
 P.I. Sta. 1947+61.98
 Δ = 43°06'
 D = 4°00'00"
 T = 565.68'
 R = 1432.40'
 L = 1077.50'
 E = 107.65'
 S.E. = .061'

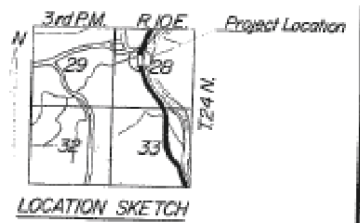

APPROVED FOR STRUCTURAL ENGINEER

Michael D. Lewis - T.P.E. (Professional Engineer)

0.00%
 PROFILE GRADE



GENERAL PLAN & ELEVATION
 ILL. ROUTE 742 OVER MUD CREEK
 SECTION 37BR-3
 S.N. 071-0025
 OGLE COUNTY

ALLEN HENDERSON & ASSOCIATES CONSULTING CIVIL AND STRUCTURAL ENGINEERS
 SPRINGFIELD, ILL. PHONE: (217) 544-8033

STATE OF ILLINOIS
 DEPARTMENT OF TRANSPORTATION

EXISTING BRIDGE PLANS
 SN: 071-0025

F.A.P. RT.	SECTION	COUNTY	TOTAL SHEETS	SHEET NO.
IL 2 D2	BRIDGE PAINTING 2014-1	LEE / OGLE	25	20
				CONTRACT NO. 64J52

ILLINOIS

DESIGNED -	REVISED -
DRAWN -	REVISED -
CHECKED -	REVISED -
DATE -	REVISED -