

F.A.P. RTE.	SECTION	COUNTY	TOTAL SHEETS	SHEET NO.
573	D3 SANITARY SEWER 2014-1	DEKALB	11	1
		ILLINOIS	CONTRACT NO. 66D23	

INDEX OF SHEETS

1. COVER SHEET
2. GENERAL NOTES
- 3-4. SUMMARY OF QUANTITIES
5. SITE PLAN - FOR SANITARY SEWER CONSTRUCTION
6. SANITARY SEWER PROFILE
- 7-8. MANHOLE DETAILS
9. SITE PLAN - FOR WATER SERVICE CONSTRUCTION
- 10-11. MISCELLANEOUS DETAILS

STANDARDS

000001-06	STANDARD SYMBOLS, ABBREVIATIONS AND PATTERNS
001001-02	AREAS OF REINFORCEMENT BARS
001006	DECIMAL OF AN INCH AND OF A FOOT
602401-03	MANHOLE, TYPE A
602701-02	MANHOLE STEPS
604001-03	FRAME AND LIDS, TYPE 1
701001-02	OFF-ROAD OPERATIONS 2L, 2W, MORE THAN 15' (4.5 m) AWAY
701006-05	OFF-ROAD OPERATIONS 2L, 2W, 15' (4.5 m) TO 24" (600 mm) FROM PAVEMENT EDGE
701201-04	LANE CLOSURE, 2L, 2W, DAY ONLY, FOR SPEEDS ≥ 45 MPH
701301-04	LANE CLOSURE, 2L, 2W, SHORT TIME OPERATIONS
701901-03	TRAFFIC CONTROL DEVICES

STATE OF ILLINOIS
DEPARTMENT OF TRANSPORTATION
DIVISION OF HIGHWAYS

PROPOSED
HIGHWAY PLANS

F.A.P. ROUTE 573 (US 30)
SECTION D3 SANITARY SEWER 2014-1

FURNISHING AND INSTALLING A
SANITARY SEWER SERVICE LINE AT THE DISTRICTS
WATERMAN MAINTENANCE FACILITY
DEKALB COUNTY

C-93-011-14

PROJECT LOCATION

WATERMAN MAINTENANCE FACILITY
0.23 MILES WEST OF IL ROUTE 23

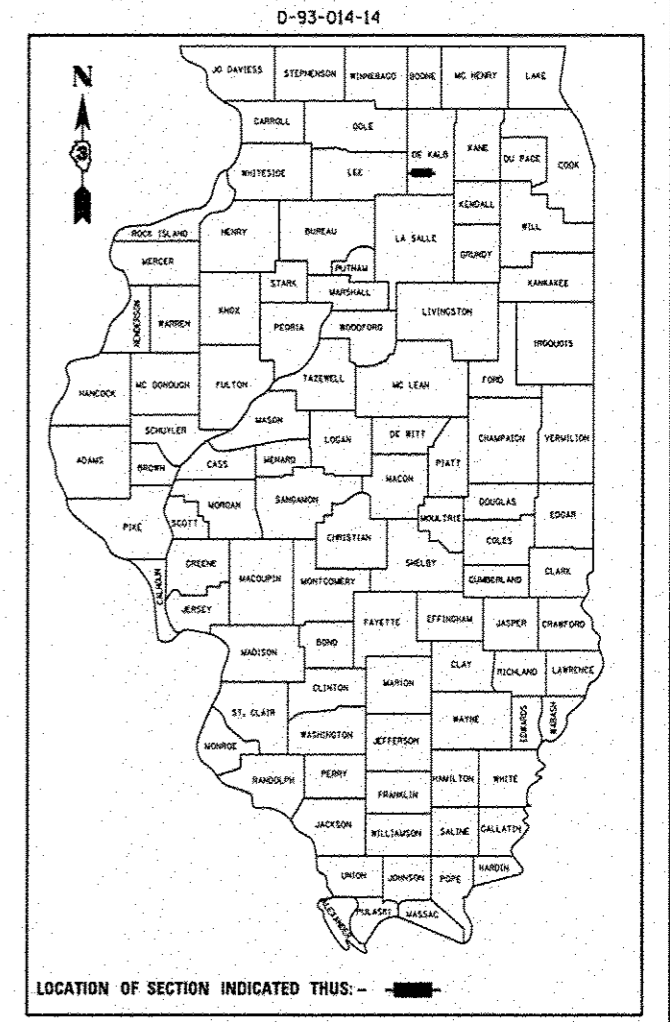

RURAL
MINOR ARTERIAL
FAP 573 (US 30)
2011

ADT	4700
P.V.	83.73%
S.U.	4.57%
M.U.	11.70%

STATE OF ILLINOIS
DEPARTMENT OF TRANSPORTATION
DIVISION OF HIGHWAYS

SUBMITTED 2-7-2014
Paul Lott
DEPUTY DIRECTOR OF HIGHWAYS, REGION ENGINEER

March 21 2014
John D. Baranzelli, P.E.
acting ENGINEER OF DESIGN AND ENVIRONMENT

March 21 2014
Omer Coman, P.E.
DIRECTOR OF HIGHWAYS, CHIEF ENGINEER

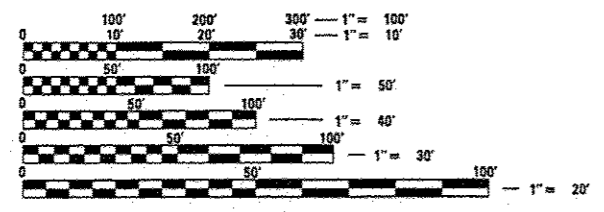

FULL SIZE PLANS HAVE BEEN PREPARED USING STANDARD ENGINEERING SCALES. REDUCED SIZED PLANS WILL NOT CONFORM TO STANDARD SCALES. IN MAKING MEASUREMENTS ON REDUCED PLANS, THE ABOVE SCALES MAY BE USED.

J.U.L.I.E.
JOINT UTILITY LOCATION INFORMATION FOR EXCAVATION
1-800-892-0123
OR 811

PROJECT ENGINEER: JOE KANNEL P.E.
UNIT CHIEF: RON WOODSHANK
TOWNSHIP: CLINTON
CONTRACT NO. 66D23

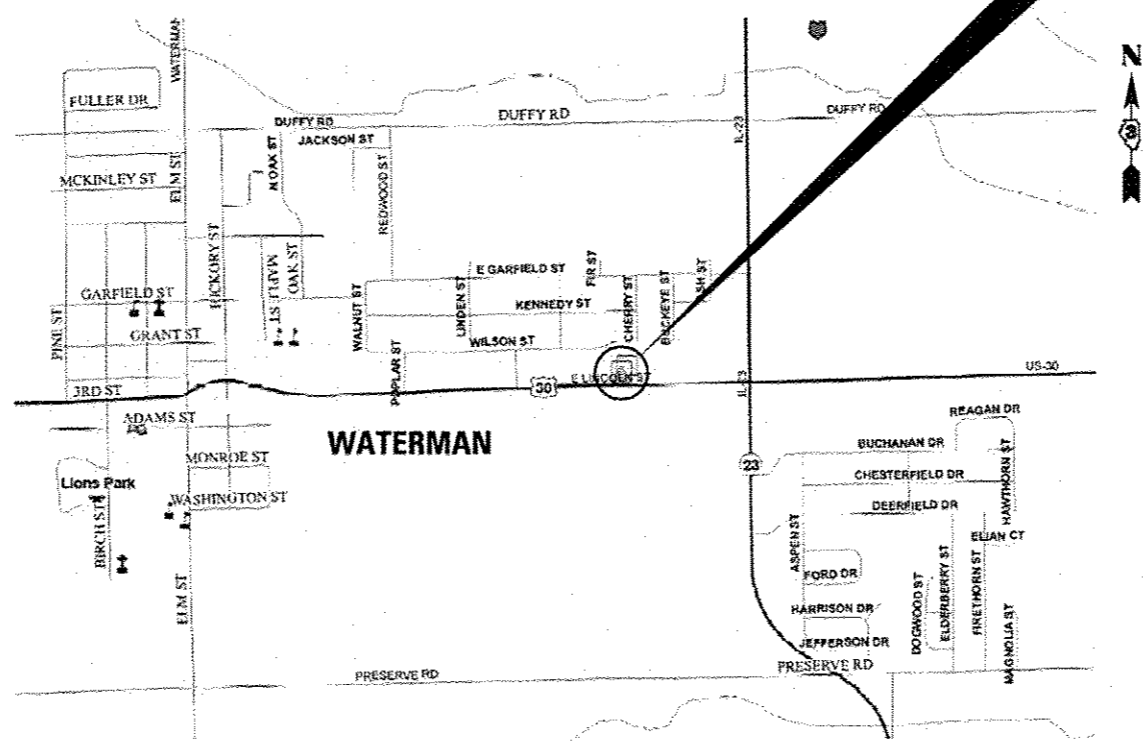

LOCATION MAP
NOT TO SCALE
POINT LOCATION

PRINTED BY THE AUTHORITY
OF THE STATE OF ILLINOIS