

NOTE:
STATIONS AND OFFSETS
ARE BASED ON THE
CL ALLEN ROAD ALIGNMENT

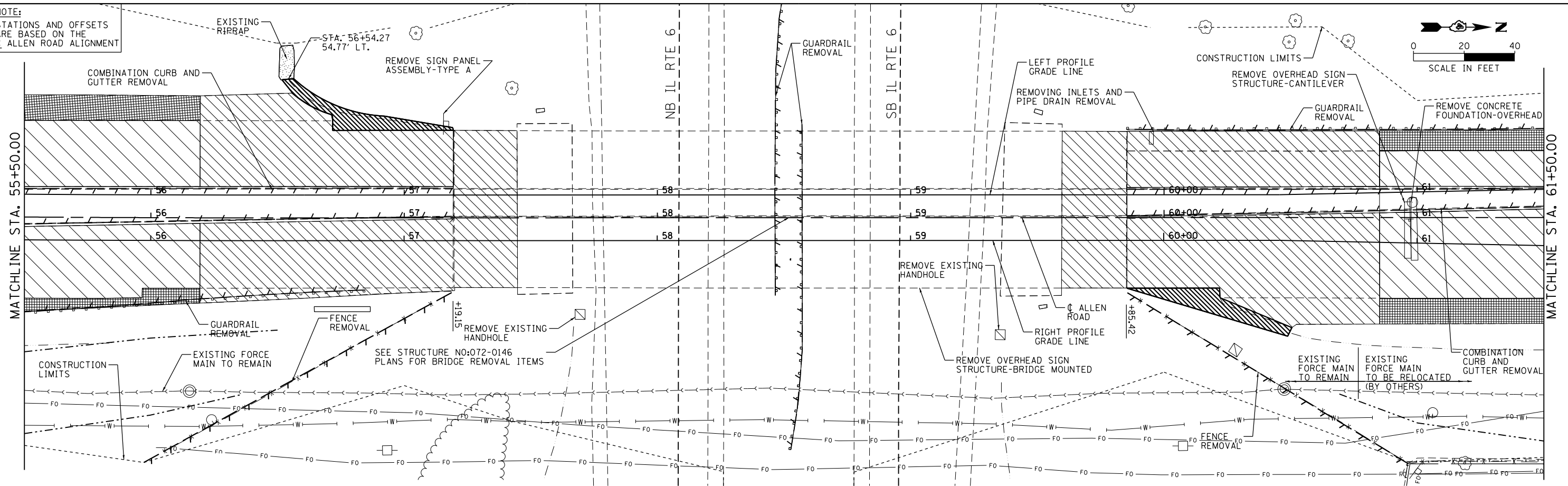
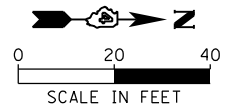

LEGEND

PAVEMENT REMOVAL		GUTTER REMOVAL	
PAVED SHOULDER REMOVAL		APPROACH SLAB REMOVAL	
MEDIAN REMOVAL			

NOTE:
SEE TRAFFIC SIGNAL PLAN SHEETS
FOR EXISTING TRAFFIC SIGNAL AND
EQUIPMENT REMOVAL.

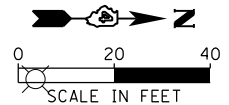
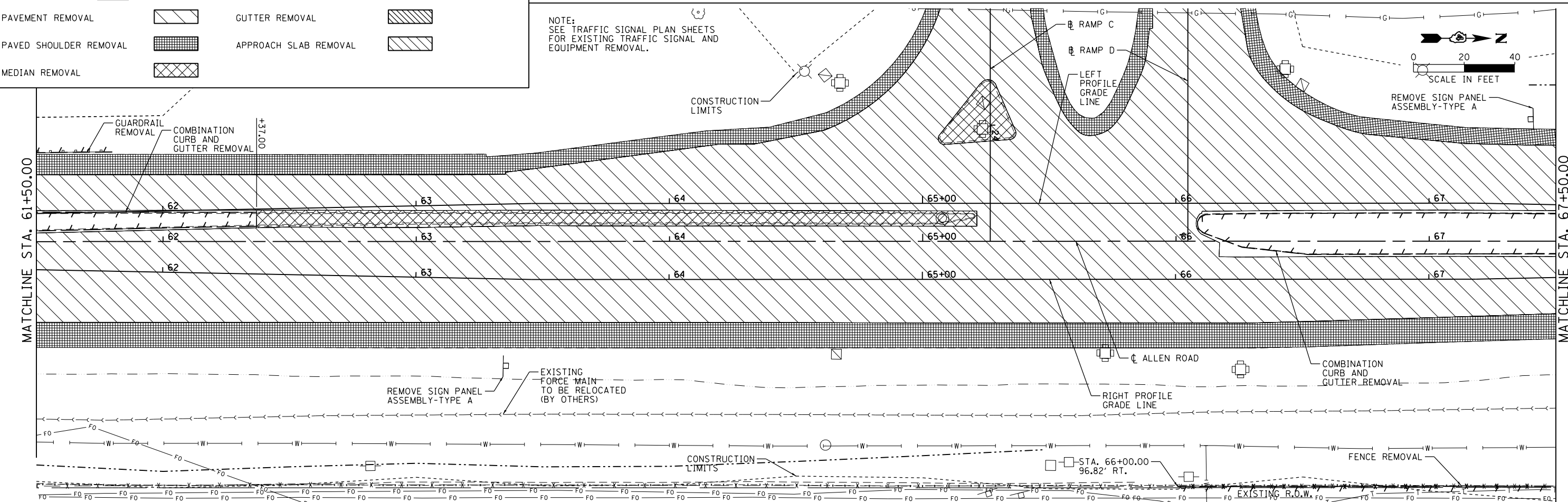

MAURER-STUTZ
ENGINEERS SURVEYORS

FILE NAME = S:\237\2013\23713009\00\AllenRdPh11\CADD	USER NAME = wllewis	DESIGNED -	REVISED -
CADD Sheets\0468683-sht-rem-ALN2.dgn		DRAWN -	REVISED -
PLOT SCALE = 40.0000' / in.		CHECKED -	REVISED -
PLOT DATE = 2/18/2014 3:01:31 PM		DATE -	REVISED -

**STATE OF ILLINOIS
DEPARTMENT OF TRANSPORTATION**

**ALLEN ROAD IMPROVEMENTS
REMOVAL PLAN SHEET - ALLEN ROAD**

SCALE: SHEET 2 OF 9 SHEETS STA. TO STA.

F.A.U. RTE. 6584	SECTION 105; (72-7HB)BY	COUNTY PEORIA	TOTAL SHEETS 487	SHEET NO. 72
6585		CONTRACT NO. 68683		

ILLINOIS FED. AID PROJECT