

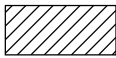

| TEMPORARY PAVEMENT MARKING LEGEND |                    |   |                             |
|-----------------------------------|--------------------|---|-----------------------------|
| ①                                 | 4" SOLID (WHITE)   | ⑥ | 24" SOLID (WHITE)           |
| ②                                 | 4" SOLID (YELLOW)  | ⑦ | 4" DOUBLE SOLID (YELLOW)    |
| ③                                 | 8" SOLID (WHITE)   | ⑧ | 6" SKIP DASH (WHITE)        |
| ④                                 | 12" SOLID (WHITE)  | ⑨ | 8" DOTTED (WHITE)           |
| ⑤                                 | 12" SOLID (YELLOW) | ⑩ | LETTERS AND SYMBOLS (WHITE) |

| TEMPORARY RAISED REFLECTIVE PAVEMENT MARKERS LEGEND |                        |
|---|------------------------|
| ▲   | ONE-WAY CRYSTAL MARKER |
| ▲   | TWO-WAY AMBER MARKER   |

| LEGEND  |                              |
|---|------------------------------|
|  | PROPOSED CONSTRUCTION        |
|  | VERTICAL BARRICADES OR DRUMS |
|  | PROPOSED TEMPORARY PAVEMENT  |

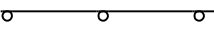

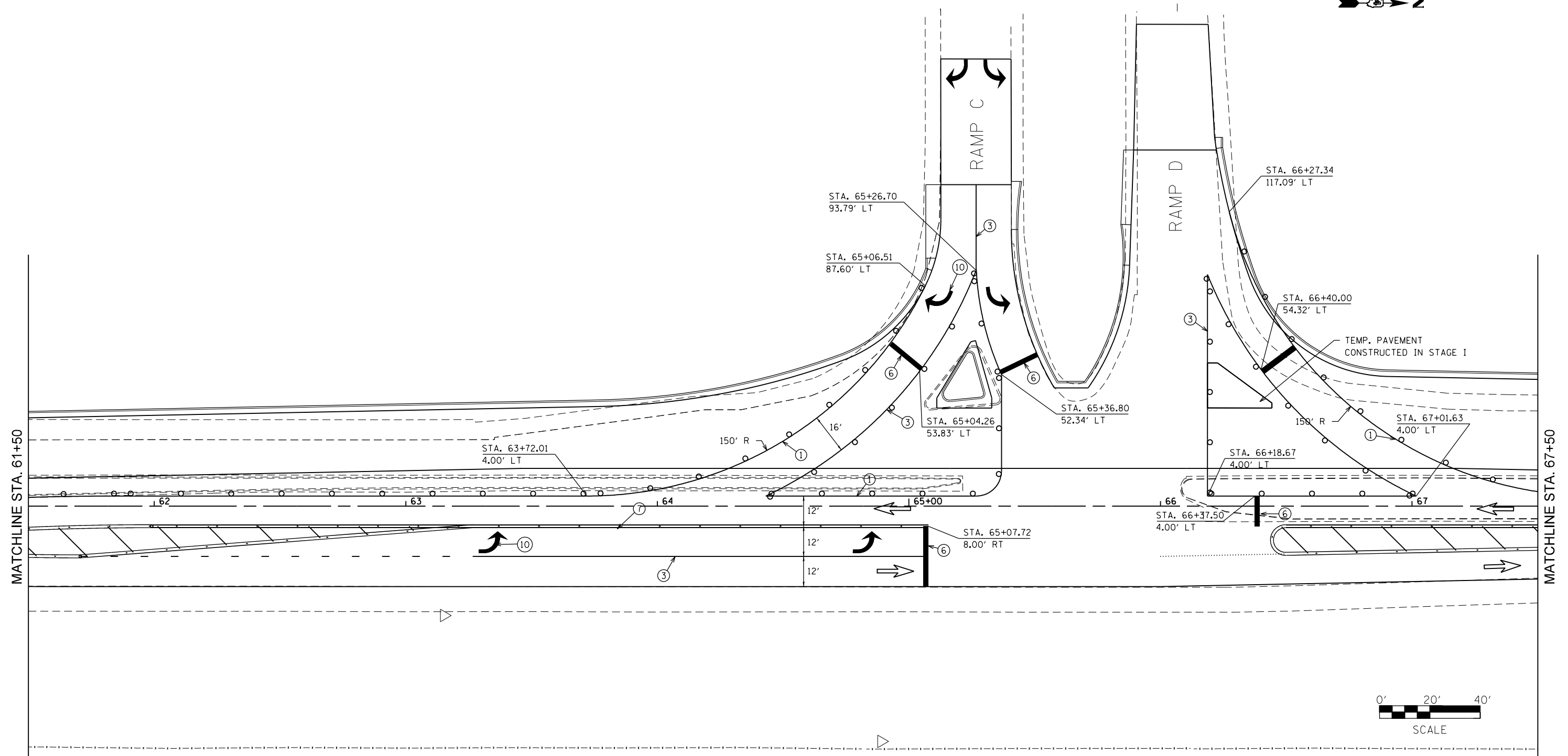
|  |                             |            |           |
|--|-----------------------------|------------|-----------|
| FILE NAME =  | USER NAME = aubreygs        | DESIGNED - | REVISED - |
| et:\pw\work\p\idot\aubreygs\d0346345\0468683-staging.dgn |                             | DRAWN -    | REVISED - |
| Stage IB   | PLOT SCALE = 40.0000' / in. | CHECKED -  | REVISED - |
|  | PLOT DATE = 1/29/2014       | DATE -     | REVISED - |

STATE OF ILLINOIS  
DEPARTMENT OF TRANSPORTATION

| STAGE IB PLAN |       |    |        |
|---------------|-------|----|--------|
| SCALE:        | SHEET | OF | SHEETS |
|               | STA.  | TO | STA.   |

| F.A.P. RTE.               | SECTION        | COUNTY | TOTAL SHEETS       | SHEET NO. |
|---------------------------|----------------|--------|--------------------|-----------|
| 6584                      | 105; (72-7H)BY | PEORIA | 487                | 149       |
| 6585                      |                |        | CONTRACT NO. 68683 |           |
| ILLINOIS FED. AID PROJECT |                |        |                    |           |