

NOTE:
STATIONS AND OFFSETS
ARE BASED ON THE
CL ALLEN ROAD ALIGNMENT

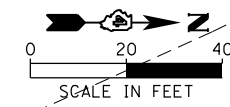

MATCHLINE STA. 79+50.00

MATCHLINE STA. 85+50.00

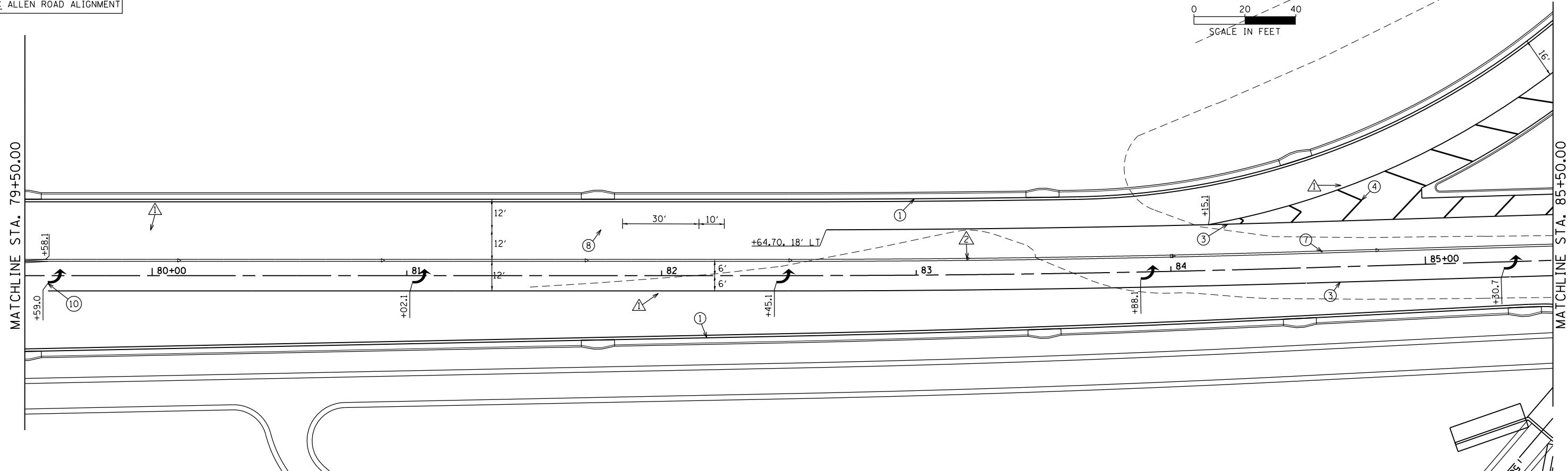

MATCHLINE STA. 85+50.00

MATCHLINE STA. 91+50.00

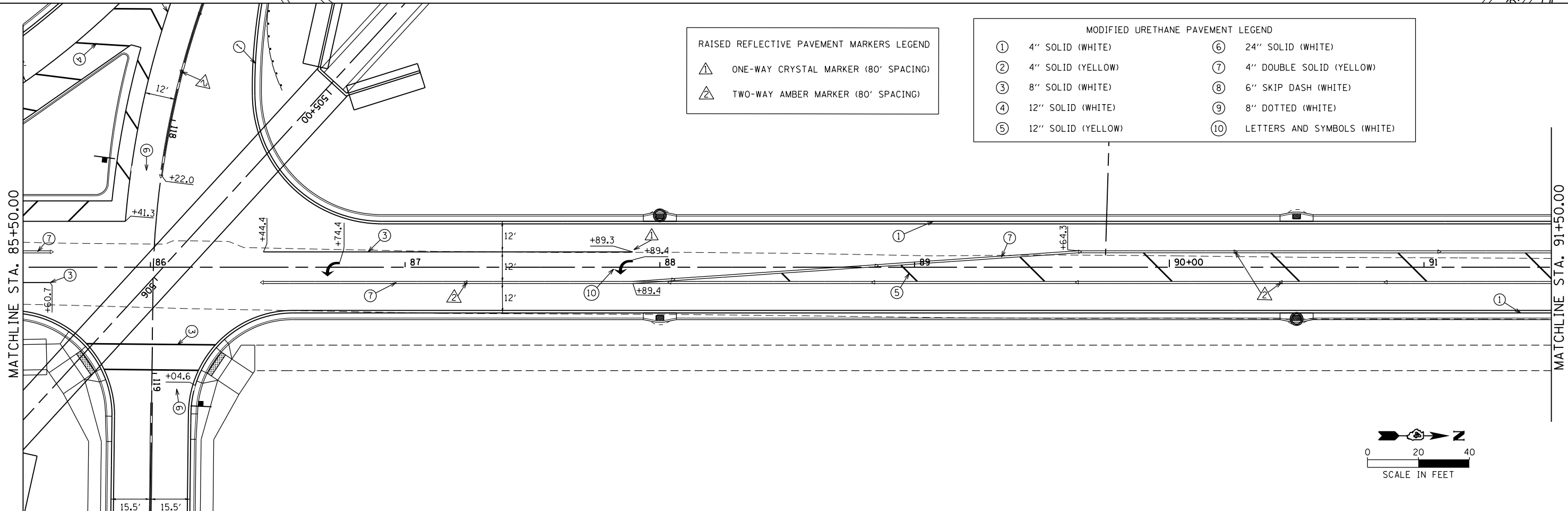

RAISED REFLECTIVE PAVEMENT MARKERS LEGEND

	ONE-WAY CRYSTAL MARKER (80' SPACING)
	TWO-WAY AMBER MARKER (80' SPACING)

MODIFIED URETHANE PAVEMENT LEGEND

①	4" SOLID (WHITE)	⑥	24" SOLID (WHITE)
②	4" SOLID (YELLOW)	⑦	4" DOUBLE SOLID (YELLOW)
③	8" SOLID (WHITE)	⑧	6" SKIP DASH (WHITE)
④	12" SOLID (WHITE)	⑨	8" DOTTED (WHITE)
⑤	12" SOLID (YELLOW)	⑩	LETTERS AND SYMBOLS (WHITE)

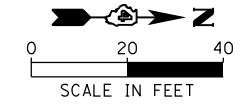

FILE NAME =	USER NAME = aubreys	DESIGNED -	REVISED -
S:\GEN\DRAW\STD&PLNS\SQUAD3\Allen Rd	pvt marking details\468683-pvt markings-ALN	DRAWN -	REVISED -
Default	PLOT SCALE = 40.0000' / in.	CHECKED -	REVISED -
	PLOT DATE = 1/29/2014	DATE -	REVISED -

**STATE OF ILLINOIS
DEPARTMENT OF TRANSPORTATION**

**ALLEN ROAD IMPROVEMENTS
PAVEMENT MARKING DETAILS - ALLEN ROAD**

SCALE: SHEET OF SHEETS STA. TO STA.

F.A.U. RTE.	SECTION	COUNTY	TOTAL SHEETS	SHEET NO.
6584	105; (72-7HB)BY	PEORIA	487	229
6585			CONTRACT NO. 68683	

ILLINOIS FED. AID PROJECT