

SECTION A-A

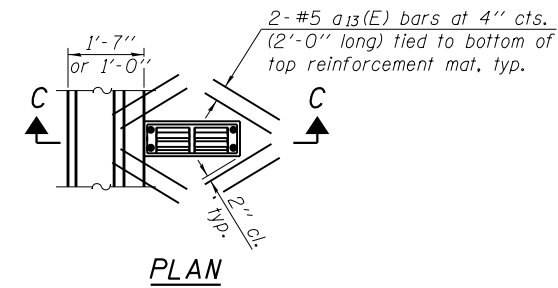

Note: Cut longitudinal reinforcement to clear drainage scuppers. See Sheet 1 of 36 for scupper locations.

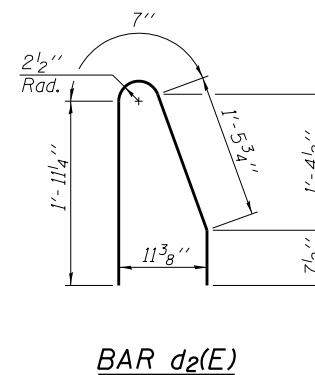
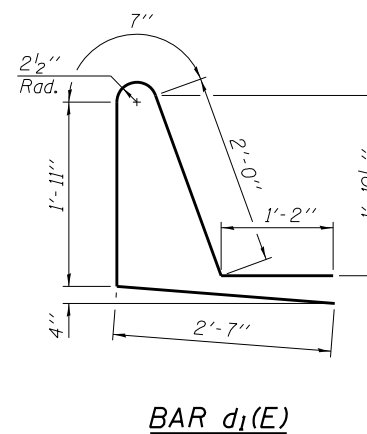
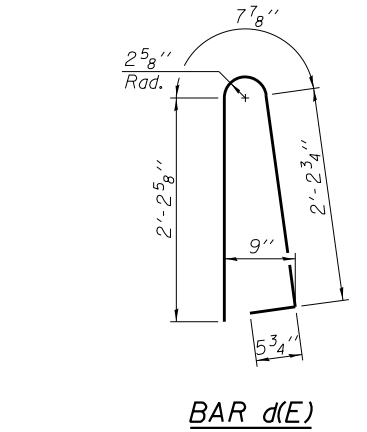
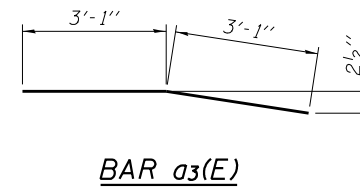
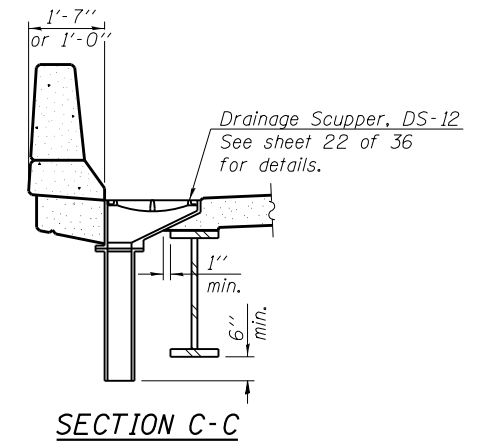

SUPERSTRUCTURE BILL OF MATERIAL

Bar	No.	Size	Length	Shape
a(E)	669	#5	28'-10"	—
a1(E)	752	#5	28'-6"	—
a2(E)	879	#5	19'-11"	—
a3(E)	669	#5	6'-2"	—
a4(E)	188	#6	6'-6"	—
a13(E)	152	#5	2'-0"	—
a14(E)	188	#6	20'-6"	—
b(E)	712	#5	29'-8"	—
b1(E)	258	#6	25'-11"	—
b2(E)	648	#5	26'-8"	—
b3(E)	40	#5	29'-8"	—
c(E)	220	#5	3'-6"	—
c1(E)	440	#5	1'-4"	Γ
d(E)	480	#5	5'-7"	⌋
d1(E)	240	#5	8'-3"	⌋
d2(E)	240	#5	4'-8"	⌋
d3(E)	220	#6	3'-9"	L
d4(E)	220	#4	5'-0"	L
d5(E)	50	#4	2'-0"	⌋
d6(E)	3	#6	4'-5"	L
d7(E)	5	#6	8'-11"	⌋
e(E)	198	#4	17'-8"	—
e1(E)	22	#4	16'-8"	—
e2(E)	44	#4	19'-8"	—
e3(E)	12	#8	33'-6"	—
e4(E)	4	#8	19'-8"	—
e5(E)	16	#4	24'-1"	—
e6(E)	4	#4	19'-8"	—
Reinforcement Bars, Epoxy Coated		Pound	138640	
Concrete Superstructure		Cu. Yd.	599.0	

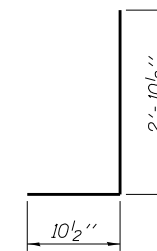
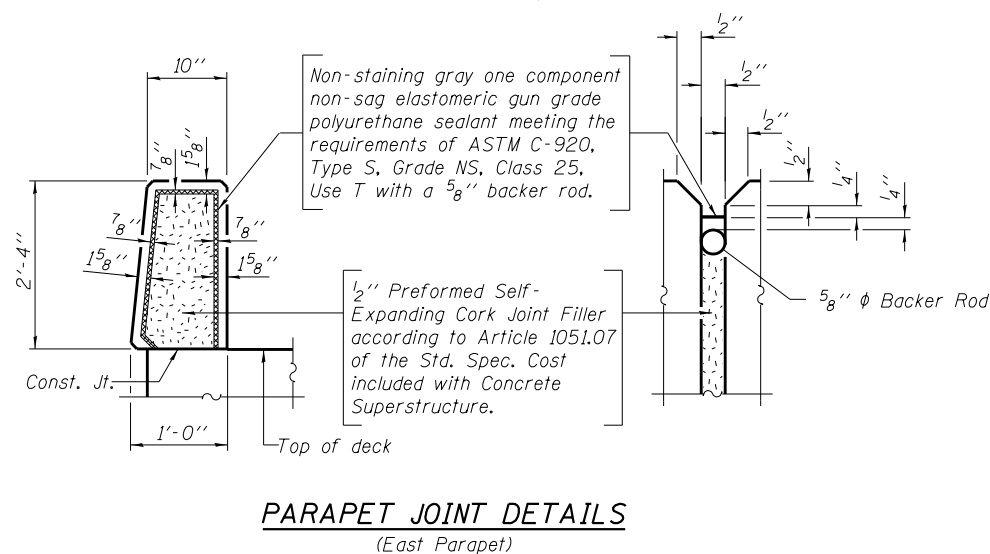
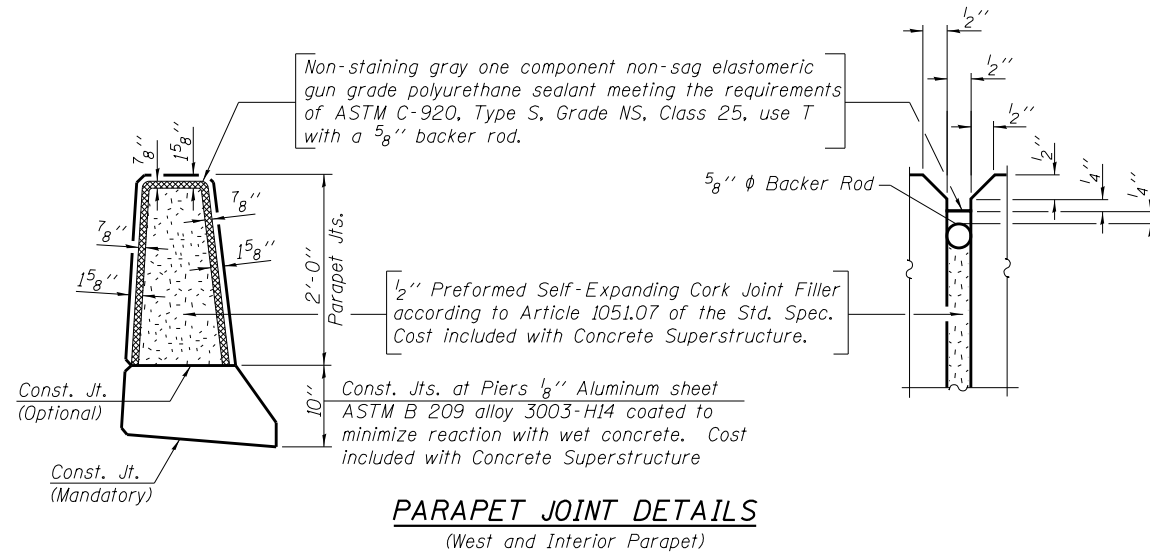

BAR d3(E)

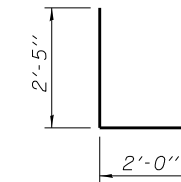

BAR d6(E)

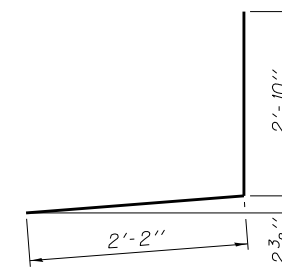

BAR d4(E)

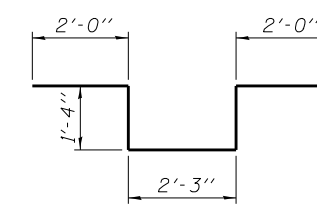

BAR d7(E)

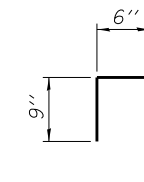

BAR d5(E)

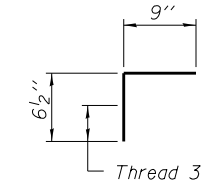

BAR c1(E)

(Sheet 3 of 3)

FILE NAME = 0720146-68683-014-Superstructure Details.dgn	USER NAME = baswanson	DESIGNED - BAS	REVISED
MAURER-STUTZ ENGINEERS SURVEYORS	PLOT SCALE =	CHECKED - JAE	REVISED
PLOT DATE = 1/24/2014		DRAWN - BAS	REVISED
		CHECKED - RAL	REVISED

STATE OF ILLINOIS DEPARTMENT OF TRANSPORTATION

SUPERSTRUCTURE DETAILS STRUCTURE NO. 072-0146

SHEET NO. 14 OF 36 SHEETS

F.A.P. RTE. 318	SECTION (72-7HB)BY	COUNTY PEORIA	TOTAL SHEETS 487	SHEET NO. 301
CONTRACT NO. 68683			ILLINOIS FED. AID PROJECT	