

TYPICAL FRONT ELEVATION
With lights and handrail omitted for clarity.

Walkway and truss grating dimensions are nominal and may vary (width ±½", depth ±½") based on available standard widths.

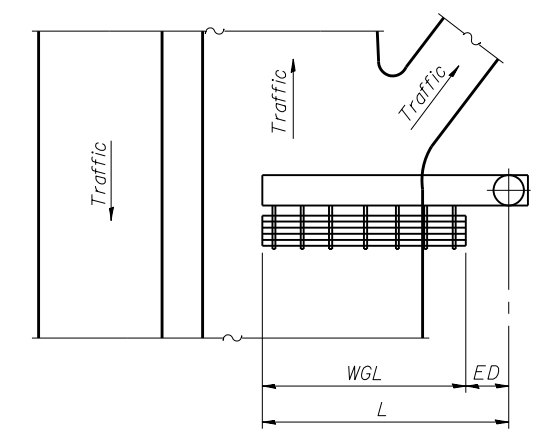

PLAN WALKWAY AND HANDRAIL SKETCH
(Road plan beneath truss varies)

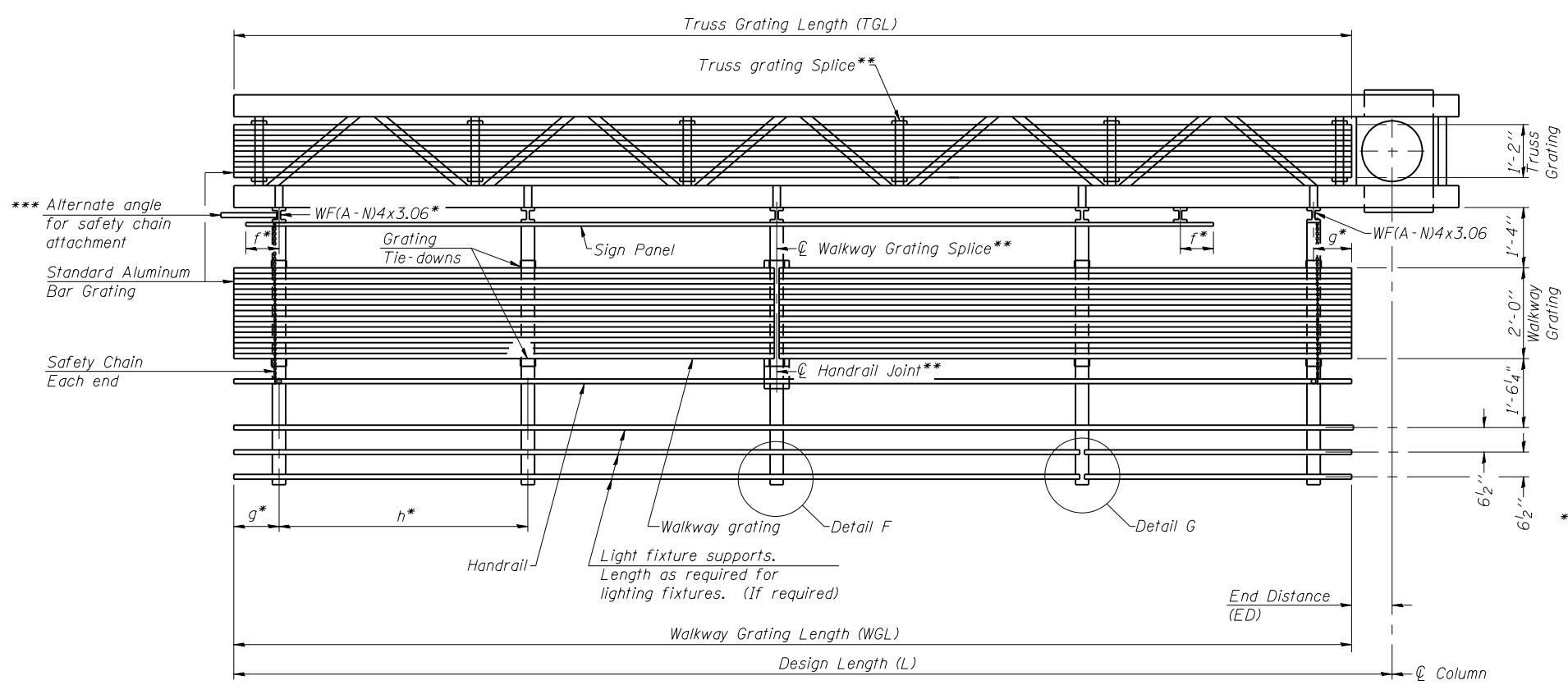

SECTION A-A

Truss grating to facilitate inspection shall run full length of cantilevers. Cost of truss grating is included in Overhead Sign Structure Cantilever.

Handrail and walkway grating shall span a minimum of three brackets between splices.
** Use and location of handrail joints or grating splices are optional, based on lengths needed and material availability.

$$TGL = L - \left(\frac{\text{Post O.D.}}{2} + 6'' \right)$$

Structure Number	Station	WGL	ED	TGL
4C072S5006L005.53	61+01.00	16'-10"	1'-2"	16'-10"

Notes:
* Space walkway brackets WF(A-N)4x3.06 and sign brackets WF(A-N)4x1.79 for efficiency and within limits shown:
 $f = 12''$ maximum, $4''$ minimum (End of sign to ϕ of nearest bracket)
 $g = 12''$ maximum, $4''$ minimum (End of walkway to ϕ of nearest bracket)
 $h = 6'-0''$ maximum (ϕ to ϕ sign and/or walkway support brackets, WF(A-N)4x1.79 or WF(A-N)4x3.06)
*** If walkway bracket at safety chain location is behind sign, add angle to bracket. See alternate safety chain attachment on base sheet OSC-A-8.
For details of sign placement, sign/walkway brackets, truss and walkway gratings, grating splices and Section B-B, see Base Sheet OSC-A-7.
For details of handrail, handrail joint, safety chain and Details F and G, see Base Sheet OSC-A-8.

BRACKET TABLE

Sign Width		Number Brackets Required
Greater Than	Less Than or Equal To	
	8'-0"	2
8'-0"	14'-0"	3
14'-0"	20'-0"	4
20'-0"	26'-0"	5
26'-0"	32'-0"	6

OSC-A-6 6-1-12

FILE NAME = 0468683-OSC-A-6.dgn	USER NAME = RALEE	DESIGNED - RAL	REVISED
		CHECKED - JAF	REVISED
		DRAWN - RAL	REVISED
		CHECKED - JAF	REVISED
	PLOT SCALE =		
	PLOT DATE = 01/24/2014		

**STATE OF ILLINOIS
DEPARTMENT OF TRANSPORTATION**

**CANTILEVER SIGN STRUCTURES - ALUMINUM WALKWAY
DETAILS - ALUMINUM TRUSS & STEEL POST**

F.A. RTE.	SECTION	COUNTY	TOTAL SHEETS	SHEET NO.
6584	105; (72-7HB)BY	PEORIA	487	337
6585			CONTRACT NO. 68683	

SHEET NO. 6 OF 9 SHEETS

ILLINOIS FED. AID PROJECT