

| | |
|-----------------|--|
| DATE | |
| BY | |
| FINISHED SURVEY | |
| PLOTTED | |
| NOTE BOOK | |
| AREAS CHECKED | |
| NO. | |

| | |
|-----------------|--|
| DATE | |
| BY | |
| ORIGINAL SURVEY | |
| PLOTTED | |
| NOTE BOOK | |
| AREAS CHECKED | |
| NO. | |

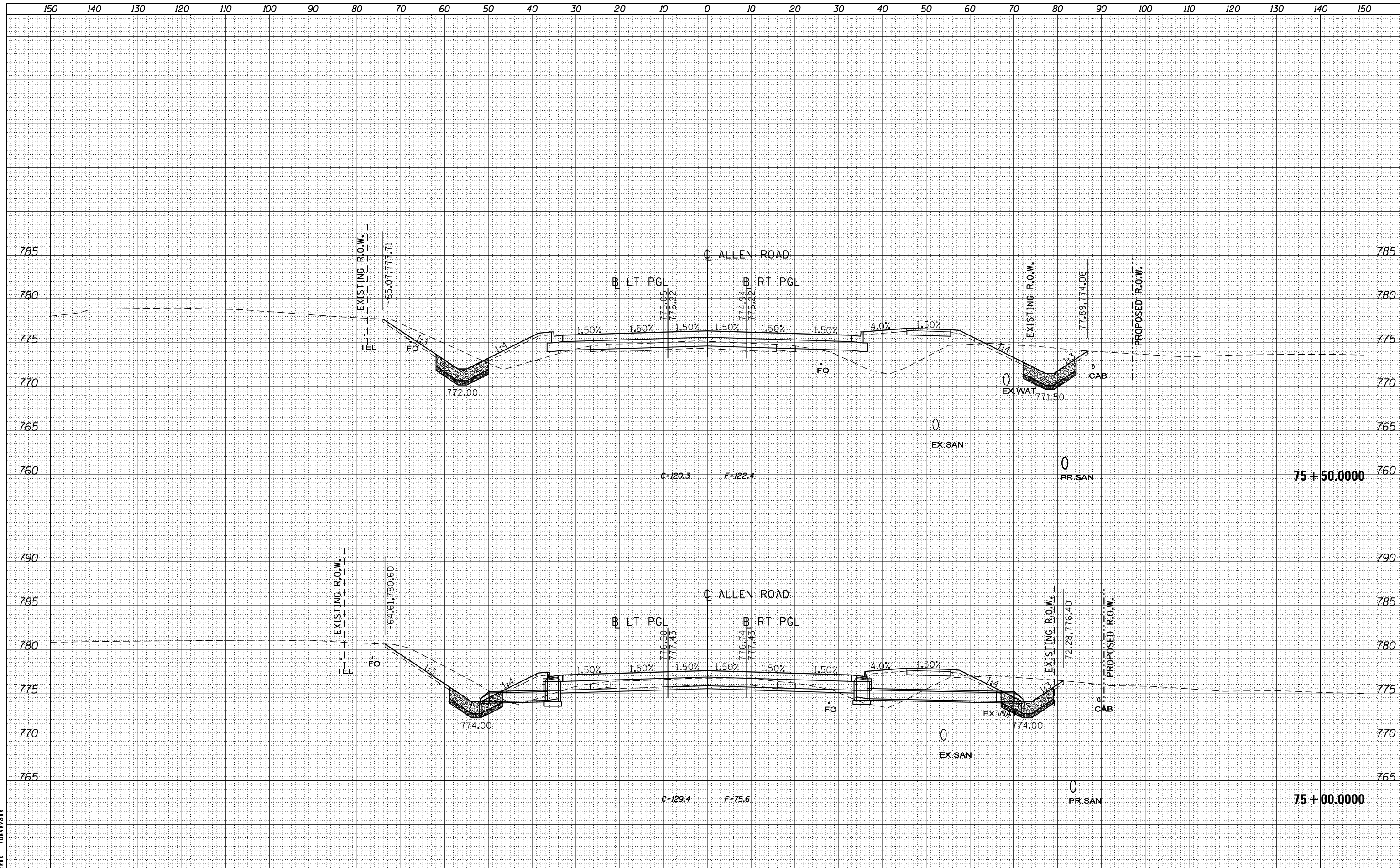

MAURER-STUTZ
ENGINEERS SURVEYORS

FILE NAME = S:\237\2013\23713009_00(AllenRdPhI)\CADD\CADD
USER NAME = baswanson
S:\237\2013\23713009_00(AllenRdPhI)\CADD\CADD Sheets\0468683-sht-xsc-Allen.dgn
PLOT SCALE = 20.0000' / in.
PLOT DATE = 1/28/2014

| | |
|------------|------------|
| DESIGNED - | REVISIED - |
| DRAWN - | REVISIED - |
| CHECKED - | REVISIED - |
| DATE - | REVISIED - |

STATE OF ILLINOIS
DEPARTMENT OF TRANSPORTATION

ALLEN ROAD IMPROVEMENTS
ALLEN ROAD CROSS SECTIONS
SCALE: SHEET OF SHEETS STA. 75+00.0000 TO STA. 75+50.0000

| F.A.U. RTE. | SECTION | COUNTY | TOTAL SHEETS | SHEET NO. |
|---------------------------|-----------------|--------|--------------|-----------|
| 6584 | 105: (72-7HB)BY | PEORIA | 487 | 434 |
| 6585 | | | | |
| CONTRACT NO. 68683 | | | | |
| ILLINOIS FED. AID PROJECT | | | | |