

ORIGINAL SURVEY	SURVEYED	BY	DATE
NOTE BOOK	PLOTTED		
	TEMPLATE		
	AREAS		
	AREAS CHECKED		

FINAL SURVEY	SURVEYED	BY	DATE
NOTE BOOK	PLOTTED		
	TEMPLATE		
	AREAS		
	AREAS CHECKED		

MAURER-STUTZ
ENGINEERS SURVEYORS

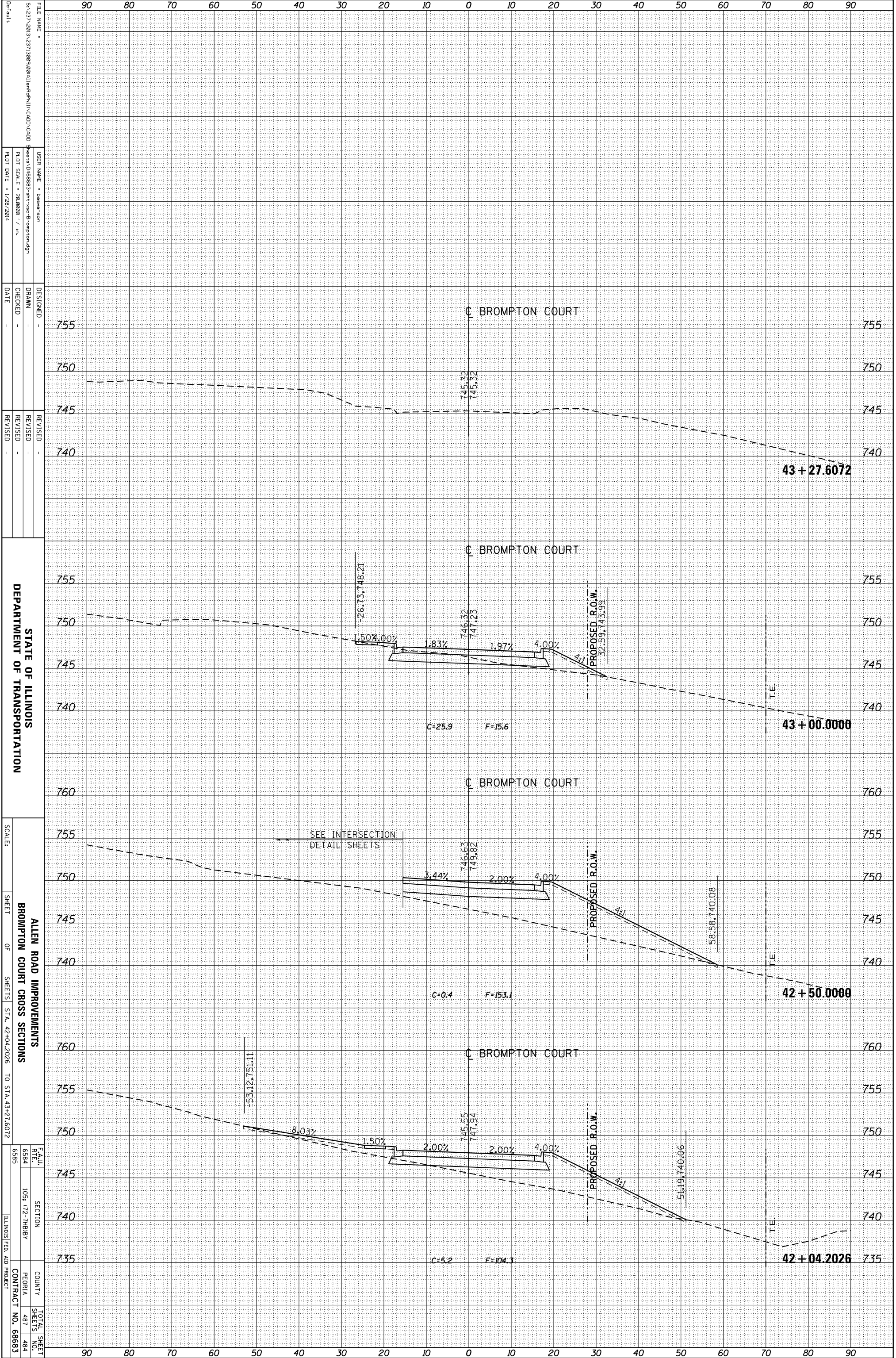

STATE OF ILLINOIS
DEPARTMENT OF TRANSPORTATION

ALLEN ROAD IMPROVEMENTS
BROMPTON COURT CROSS SECTIONS

SCALE: SHEET OF SHEETS STA. 42+04.2026 TO STA. 43+27.6072

FILE NAME	USER NAME	DESIGNED	REVISION
5:\237\2013\23713086\806\11\m\p\h\11\CAD\CD\00	basemason	-	-
Sheet\046883\st-t-ss-B-brompton.dgn		DRAWN	REVISION
		-	-
PLLOT SCALE = 28.0000 / in.		CHECKED	REVISION
		-	-
PLLOT DATE = 1/28/2014		DATE	REVISION
		-	-

F.A.U. R.T.E.	SECTION	COUNTY	TOTAL SHEET NO.
6584	105 (72-74)BY	PEORIA	487
6585			484

ILLINOIS FED. AID PROJECT CONTRACT NO. 68683