

NOTES:

1. PROPOSED UNDERPASS LUMINAIRES SHALL BE CENTER PIER MOUNTED, OFFSET 30 FEET FROM EDGE OF PAVEMENT OF ROADWAY. SEE SHEET 11 FOR WALL UNDERPASS LIGHTING WITH CENTER PIER DETAILS.
2. CONDUIT AND WIRING FROM JUNCTION BOX AT BRIDGE PIER TO THE UNDERPASS LUMINAIRE(S) SHALL BE INCIDENTAL TO THE COST OF THE UNDERPASS LUMINAIRE(S). THIS INCLUDES ALL APPURTENANCES INCLUDING BUT NOT LIMITED TO: STRAPS, CLAMPS, HANGERS, FITTING, ATTACHMENTS, HARDWARE, JUNCTION BOXES, ETC.
3. CONDUIT ATTACHED TO STRUCTURE SHALL BE RIGID GALVANIZED STEEL UNLESS NOTED OTHERWISE. ALL HARDWARE AND CONDUIT APPURTENANCES, AS NOTED ABOVE, SHALL BE STAINLESS STEEL. ANY CONDUIT THAT PENETRATES THE GROUND SHALL BE STAINLESS STEEL.
4. SEE LIGHTING SHEET 9 FOR BILL OF MATERIALS FOR THIS SHEET.

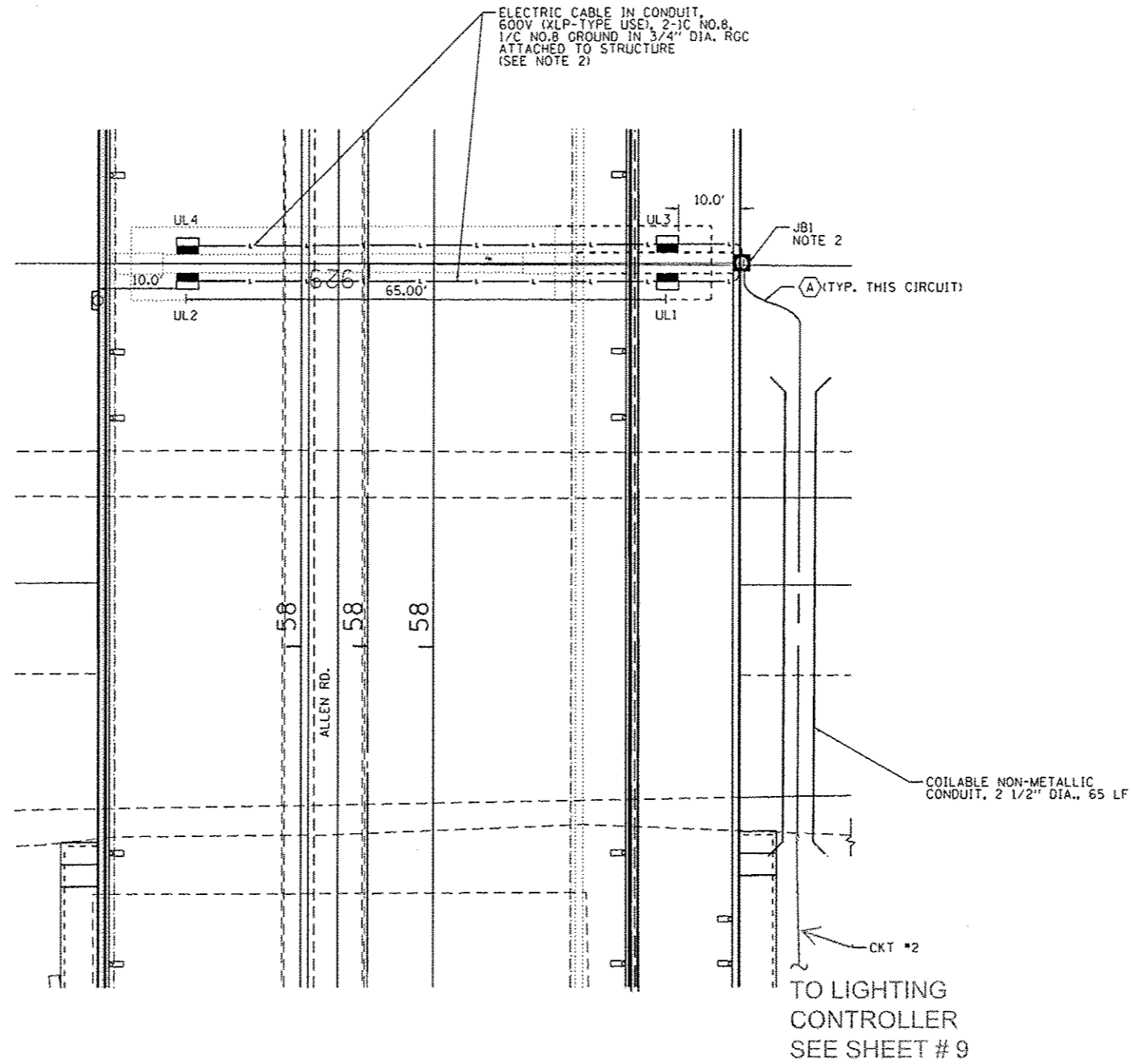

MAURER-STUTZ
ENGINEERS

FILE NAME: S:\237\2013\23713809\00\AllenRd\PHD\CADD	USER NAME: baswenson	DESIGNED: -	REVISED: -	STATE OF ILLINOIS DEPARTMENT OF TRANSPORTATION	ALLEN ROAD IMPROVEMENTS LIGHTING - ILLINOIS ROUTE 6		F.A.U. RTE.	SECTION	COUNTY	TOTAL SHEETS	SHEET NO.
CADD Sheets\0468683-shr-lighting 10.dgn	PLLOT SCALE: 40.0000' / 1" =	DRAWN: -	REVISED: -				6584	105 (72-7HB)BY	PEORIA	487	278
Default	PLLOT DATE: 1/29/2014 12:12:17 PM	CHECKED: -	REVISED: -		6585	CONTRACT NO. 68683		ILLINOIS FED. AID PROJECT			
					SCALE:	SHEET 10	OF 19 SHEETS	STA.	TO STA.		