

**FIBER OPTIC CONNECTION**

**I-57  
0.5 NORTH  
OF  
MARKET ST.**

**LEVERETTE STORAGE**

(NOT TO SCALE)

**CONDUIT /CABLE LAYOUT**

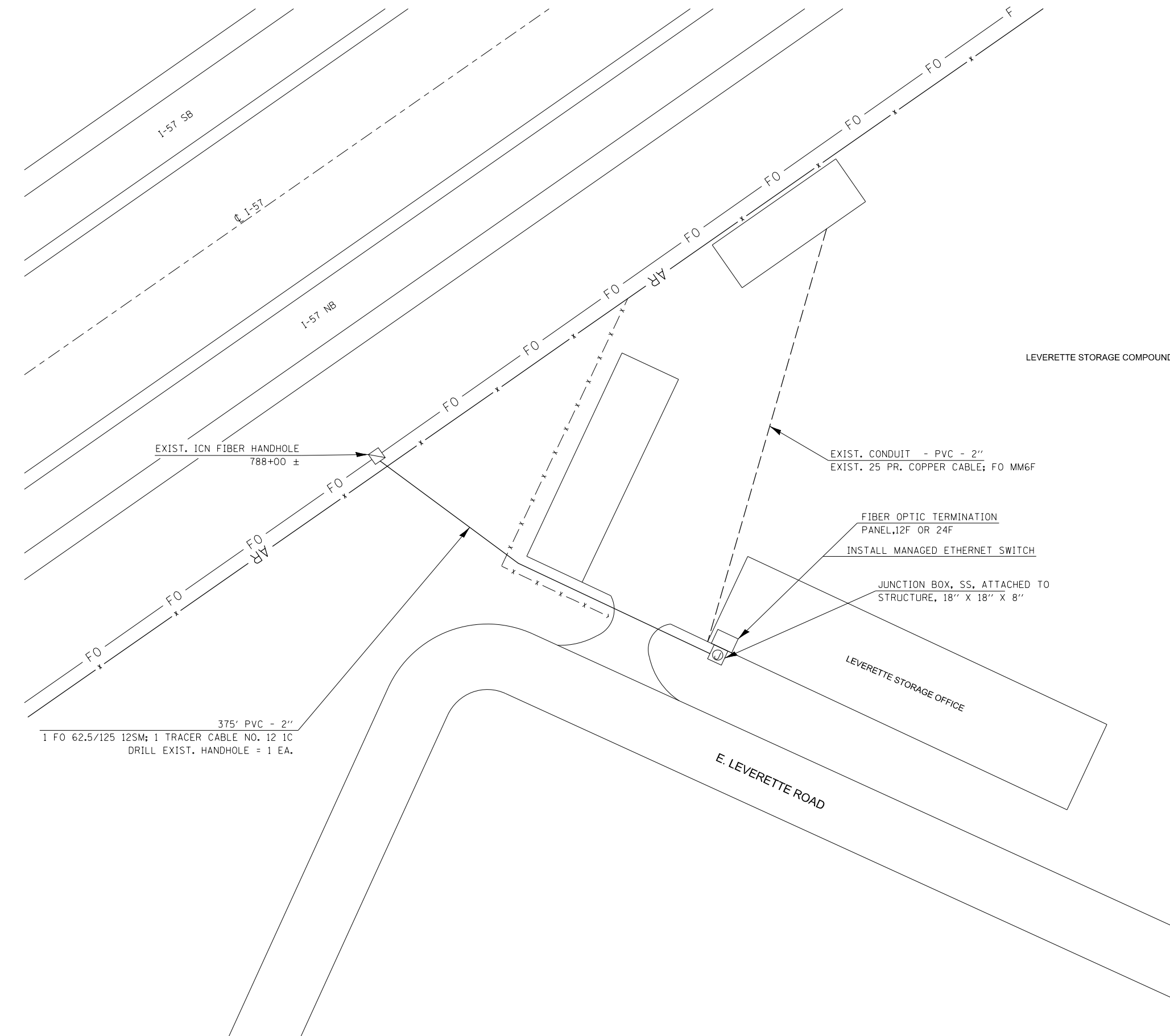

**BILL OF MATERIALS**

**I-57 AT LEVERETTE STORAGE**

ITEM	UNIT	QUANTITY
UNDERGROUND CONDUIT, PVC, 2" DIA.	FOOT	375
JUNCTION BOX, STAINLESS STEEL, ATTACHED TO STRUCTURE	EACH	1
DRILL EXISTING HANDHOLE	EACH	1
FIBER OPTIC CABLE 6 FIBERS, SINGLE MODE	FOOT	397
FIBER OPTIC CABLE 12 FIBERS, SINGLE MODE	FOOT	375
FIBER OPTIC TERMINATION PANEL, 12 F OR 24F	EACH	1
ETHERNET SWITCH	EACH	1

FILE NAME =	USER NAME = biggsrd	DESIGNED -	REVISED -
et:\pw\work\p\idot\biggsrd\d0340463\PTZ	camera plans.dgn	DRAWN -	REVISED -
\$MODELNAME\$	PLOT SCALE = 100.0000' / in.	CHECKED -	REVISED -
	PLOT DATE = 2/7/2014	DATE -	REVISED -

**STATE OF ILLINOIS  
DEPARTMENT OF TRANSPORTATION**

SCALE: SHEET OF SHEETS STA. TO STA.

F.A.P. RTE.	SECTION	COUNTY	TOTAL SHEETS	SHEET NO.
VAR.	FY2014 ITS-1	CHAMPAIGN	74	52
ILLINOIS FED. AID PROJECT			CONTRACT NO. 70A26	