

# PTZ CAMERA INSTALLATION

I-57  
&  
I-74

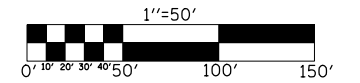

## CAMERA & CONDUIT /CABLE LAYOUT



### BILL OF MATERIALS

I-57 & I-74

| ITEM  | UNIT | QUANTITY |
|---|------|----------|
| UNDERGROUND CONDUIT, PVC, 2" DIA.           | FOOT | 2673     |
| HANDHOLE                                    | EACH | 2        |
| ELECTRIC CABLE IN CONDUIT, SIGNAL NO. 12 3C | FOOT | 2349     |
| DRILL EXISTING HANDHOLE                     | EACH | 1        |
| CLOSED CIRCUIT TELEVISION CABINET           | EACH | 1        |
| WIRELESS ETHERNET RADIO                     | EACH | 1        |
| ETHERNET SWITCH                             | EACH | 1        |
| TRANSFORMER 480-208/120V, 15KVA             | EACH | 1        |
| CLOSED CIRCUIT TELEVISION CAMERA            | EACH | 1        |
| CAMERA MOUNTING ASSEMBLY                    | EACH | 1        |

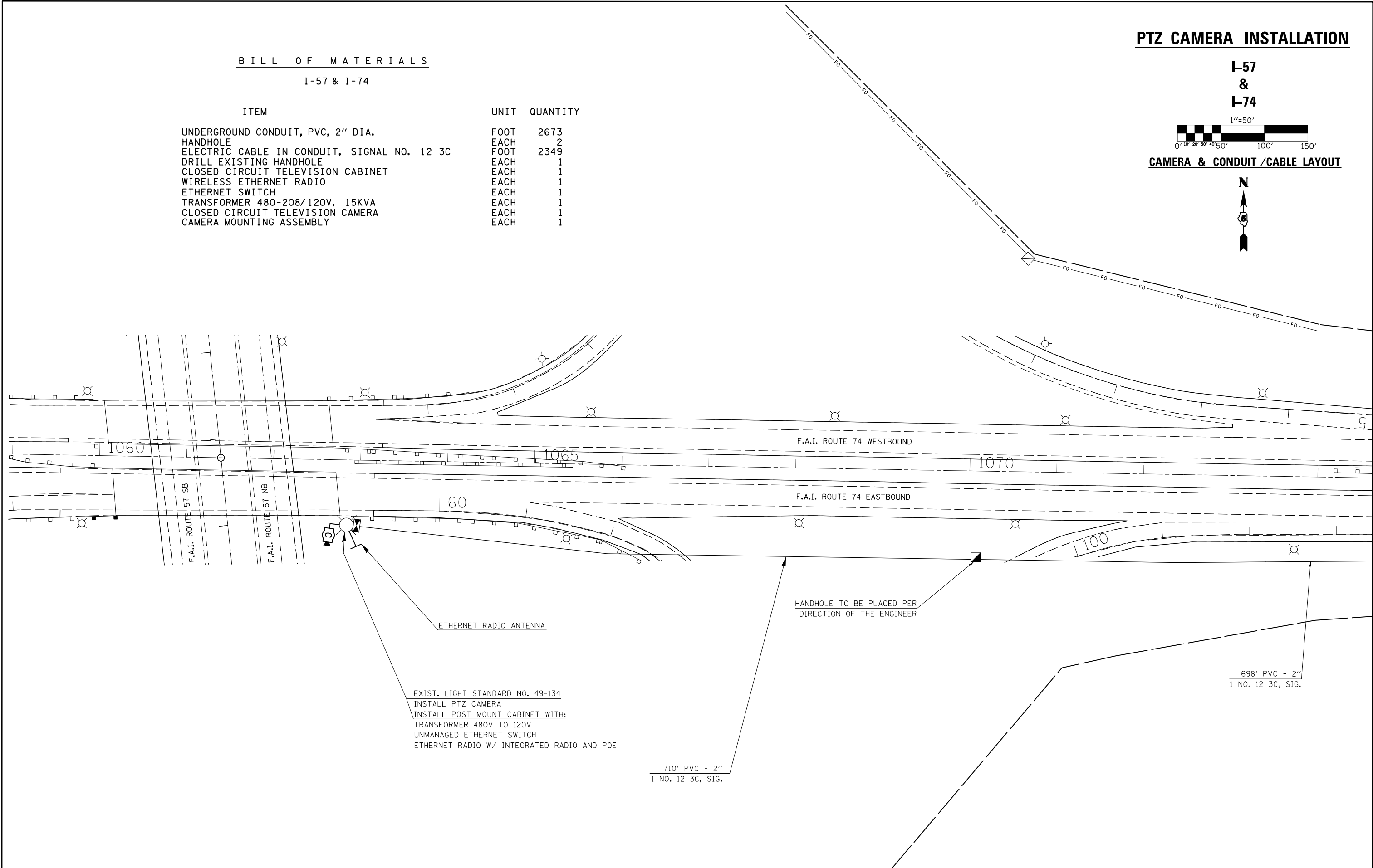

EXIST. LIGHT STANDARD NO. 49-134  
INSTALL PTZ CAMERA  
INSTALL POST MOUNT CABINET WITH:  
TRANSFORMER 480V TO 120V  
UNMANAGED ETHERNET SWITCH  
ETHERNET RADIO W/ INTEGRATED RADIO AND POE

HANDHOLE TO BE PLACED PER  
DIRECTION OF THE ENGINEER

710' PVC - 2"  
1 NO. 12 3C, SIG.

698' PVC - 2"  
1 NO. 12 3C, SIG.

|                                     |                             |            |           |   |        |       |    |        |      |         |                           |              |           |              |           |
|-------------------------------------|-----------------------------|------------|-----------|---|--------|-------|----|--------|------|---------|---------------------------|--------------|-----------|--------------|-----------|
| FILE NAME =                         | USER NAME = biggsrd         | DESIGNED - | REVISED - | <b>STATE OF ILLINOIS<br/>DEPARTMENT OF TRANSPORTATION</b> | SCALE: | SHEET | OF | SHEETS | STA. | TO STA. | F.A.P. RTE.               | SECTION      | COUNTY    | TOTAL SHEETS | SHEET NO. |
| es:\pwork\pwork\biggsrd\0340463\PTZ | camera plans.dgn            | DRAWN -    | REVISED - |   |        |       |    |        |      |         | VAR.                      | FY2014 ITS-1 | CHAMPAIGN | 74           | 53        |
| \$MODELNAME\$                       | PLOT SCALE = 100.0054' / 1" | CHECKED -  | REVISED - |   |        |       |    |        |      |         | CONTRACT NO. 70A26        |              |           |              |           |
|                                     | PLOT DATE = 2/7/2014        | DATE -     | REVISED - |   |        |       |    |        |      |         | ILLINOIS FED. AID PROJECT |              |           |              |           |