

PTZ CAMERA INSTALLATION & FIBER OPTIC CONNECTION

I-74 & CUNNINGHAM AVE. (U.S. 45)



(NOT TO SCALE)

CAMERA & CONDUIT /CABLE LAYOUT

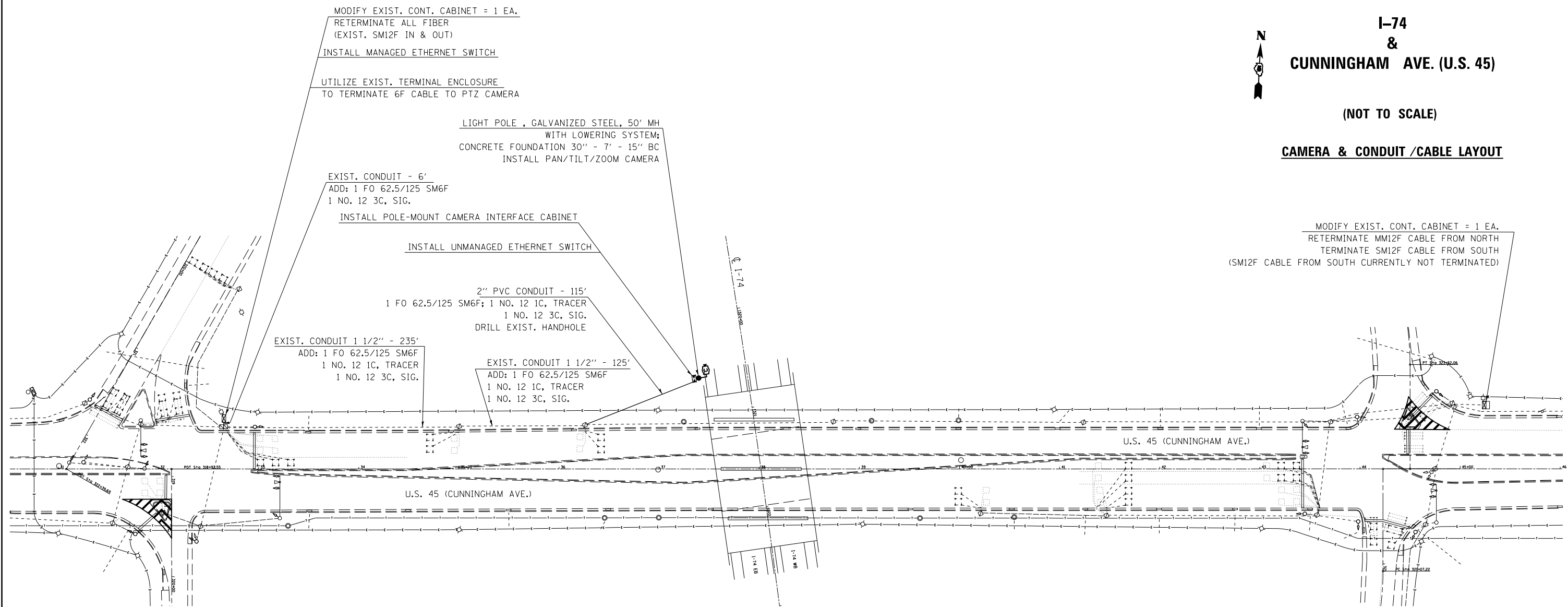

MODIFY EXIST. CONT. CABINET = 1 EA.
 RETERMINATE MM12F CABLE FROM NORTH
 TERMINATE SM12F CABLE FROM SOUTH
 (SM12F CABLE FROM SOUTH CURRENTLY NOT TERMINATED)

BILL OF MATERIALS

U. S. 45 & I-74; NORTH RAMP; SOUTH RAMP

ITEM	UNIT	QUANTITY
UNDERGROUND CONDUIT, PVC, 2" DIA.	FOOT	115
LIGHT POLE FOUNDATION, 30" DIAMETER	FOOT	7
ELECTRIC CABLE IN CONDUIT, TRACER, NO. 12 1C	FOOT	475
DRILL EXISTING HANDHOLE	EACH	1
MODIFY EXISTING CONTROLLER CABINET	EACH	2
CLOSED CIRCUIT TELEVISION CABINET	EACH	1
LIGHT POLE, STEEL 50 FT. WITH CAMERA LOWERING SYSTEM	EACH	1
ETHERNET SWITCH	EACH	2
CLOSED CIRCUIT TELEVISION CAMERA	EACH	1
FIBER OPTIC CABLE 6 FIBERS, SINGLE MODE	FOOT	525
CAMERA MOUNTING ASSEMBLY	EACH	1

FILE NAME =	USER NAME = biggsrd	DESIGNED -	REVISED -
c:\pwork\pwork\biggsrd\d0340463\PTZ	camera plans.dgn	DRAWN -	REVISED -
\$MODELNAME\$	PLOT SCALE = 100.0000' / in.	CHECKED -	REVISED -
	PLOT DATE = 2/7/2014	DATE -	REVISED -

STATE OF ILLINOIS
DEPARTMENT OF TRANSPORTATION

SCALE: SHEET OF SHEETS STA. TO STA.

F.A.P. RTE.	SECTION	COUNTY	TOTAL SHEETS	SHEET NO.
VAR.	FY2014 ITS-1	CHAMPAIGN	74	69
			CONTRACT NO. 70A26	
ILLINOIS FED. AID PROJECT				