

ADT

LOCATION 1: AVERAGE ADT = 13,900 (2011)

LOCATION MAP #1
US 136 FROM E. OF SUNVIEW RD. TO BETHANY PARK DR. IN RANTOUL
CHAMPAIGN COUNTY

OMISSION FROM SECTION
 UNDER I. C. G. RAILROAD
 S. N. 010-0233
 STA 2290+19.00 TO
 STA 2292+45.00

SECTION BEGINS
 STATION 2270+54.60

OMISSION FROM SECTION
 AT US 45 INTERSECTION
 STA 2303+23.32 TO
 STA 2305+13.70

SECTION ENDS
 STATION 105+64.00

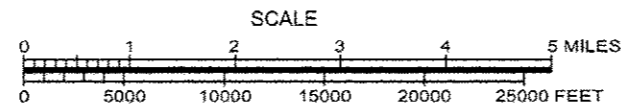
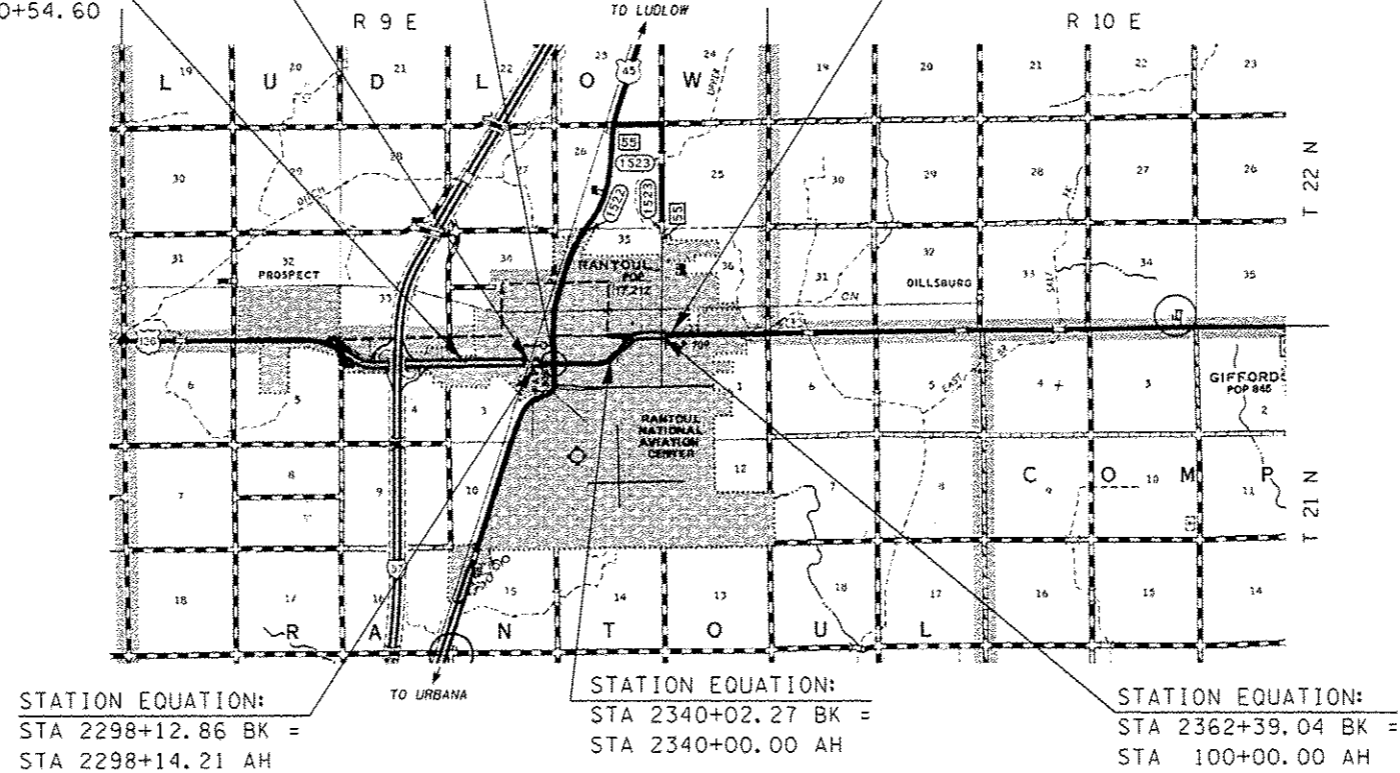

TOTAL LENGTH OF SECTION = 9749.36 FEET = 1.846 MILES
 NET LENGTH OF SECTION = 9332.98 FEET = 1.768 MILES



FILE NAME =	USER NAME = cearlock_jd	DESIGNED -	REVISED -	STATE OF ILLINOIS DEPARTMENT OF TRANSPORTATION	LOCATION MAP #1	P.A. RTE.	SECTION	COUNTY	TOTAL SHEETS	SHEET NO.	
c:\pwork\pwork\cearlock_jd\0301332\1	78432\sh-t-100.mep.dgn	DRAWN -	REVISED -			VAR.	*	VARIOUS	41	3	
	PLOT SCALE = 1/8" = 1' / in.	CHECKED -	REVISED -			*DS CRACK & JOINT SEAL 2014-1 CONTRACT NO. 70A32					
MODELNAME*	PLOT DATE = 2/14/2014	DATE -	REVISED -			SCALE: N/A	SHEET 1 OF 1 SHEETS	STA.	TO STA.	ILLINOIS FED. AID PROJECT	