

ADT

LOCATION 2: AVERAGE ADT = 19,400

LOCATION MAP #2 I 57 FROM 0.3 MI N. OF US 36 TO SADORUS RD. DOUGLAS COUNTY

SECTION (21-28, 21-10-29, 10-30)RS-1
ENDS STA. 350+00.00

CHAMPAIGN COUNTY
DOUGLAS COUNTY STA. 848+62.49

SECTION (21-28, 21-10-29, 10-30)RS-1
BEGINS STA. 547+00.00

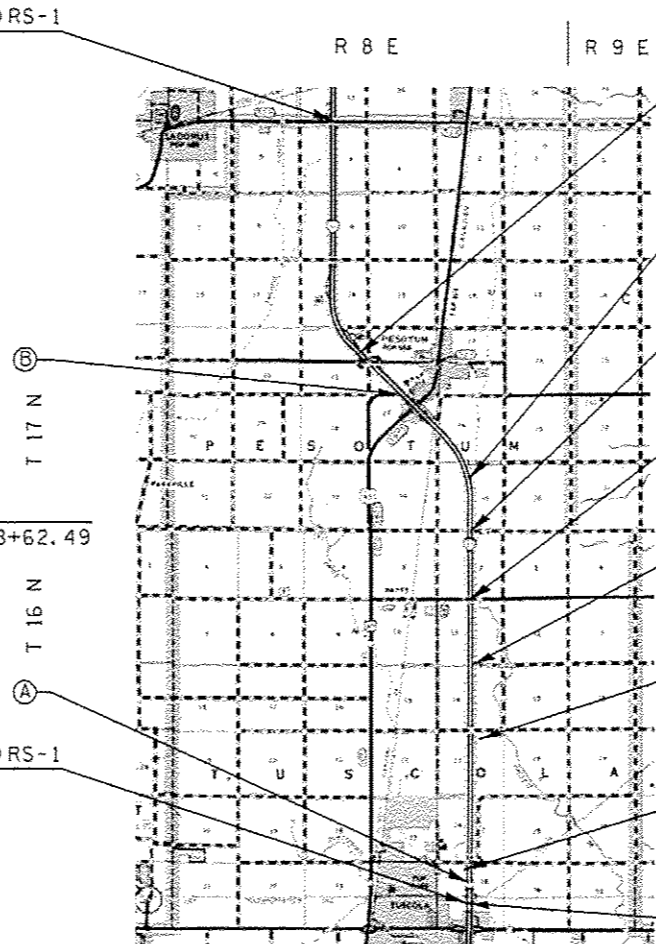

STATION EQUATION
STA. 945+52.78 (BK) =
STA. 104+50.00 (AH)

STATION EQUATION
STA. 881+68.05 (BK) =
STA. 881+68.75 (AH)

STATION EQUATION
STA. 843+84.01 (BK) =
STA. 843+85.95 (AH)

STATION EQUATION
STA. 791+00.00 (BK) =
STA. 791+02.19 (AH)

STATION EQUATION
STA. 736+24.61 (BK) =
STA. 736+26.44 (AH)

STATION EQUATION
STA. 687+00.00 (BK) =
STA. 687+03.30 (AH)

STATION EQUATION
STA. 575+43.68 (BK) =
STA. 575+43.98 (AH)

STATION EQUATION
STA. 547+00.00 (BK) =
STA. 547+01.25 (AH)



TOTAL LENGTH OF SECTION & PROJECT = 66,761.27 FEET = 12.644 MILES
NET LENGTH OF SECTION & PROJECT = 64,392.68 FEET = 12.196 MILES

FILE NAME :	USER NAME : oearlock_jd	DESIGNED -	REVISED -	STATE OF ILLINOIS DEPARTMENT OF TRANSPORTATION	LOCATION MAP #2	F.A. RTE.	SECTION	COUNTY	TOTAL SHEETS	SHEET NO.
ct:\pwork\pwidth\oearlock_jd\8081332\0799A32-sht-100.maps.dgn	799A32-sht-100.maps.dgn	DRAWN -	REVISED -			VAR.	*	VARIOUS	41	4
#MODELNAME#	PLOT SCALE = 40,0000 1/ in.	CHECKED -	REVISED -		SCALE: N/A	*05 CRACK & JOINT SEAL 2014-1		CONTRACT NO. 70A32		
	PLOT DATE = 2/14/2014	DATE -	REVISED -		SHEET 1 OF 1 SHEETS	ILLINOIS FED. AID PROJECT				