

LOCATION MAP #4

**IL 133 FROM MOULTRIE CO. LINE TO ECL OF ARTHUR
DOUGLAS COUNTY**

ADT

LOCATION 4: AVERAGE ADT (2011)
 LEG A: 6250
 MOULTRIE COUNTY LINE TO CEDAR LANE
 LEG B: 4260
 CEDAR LANE TO ECL OF ARTHUR

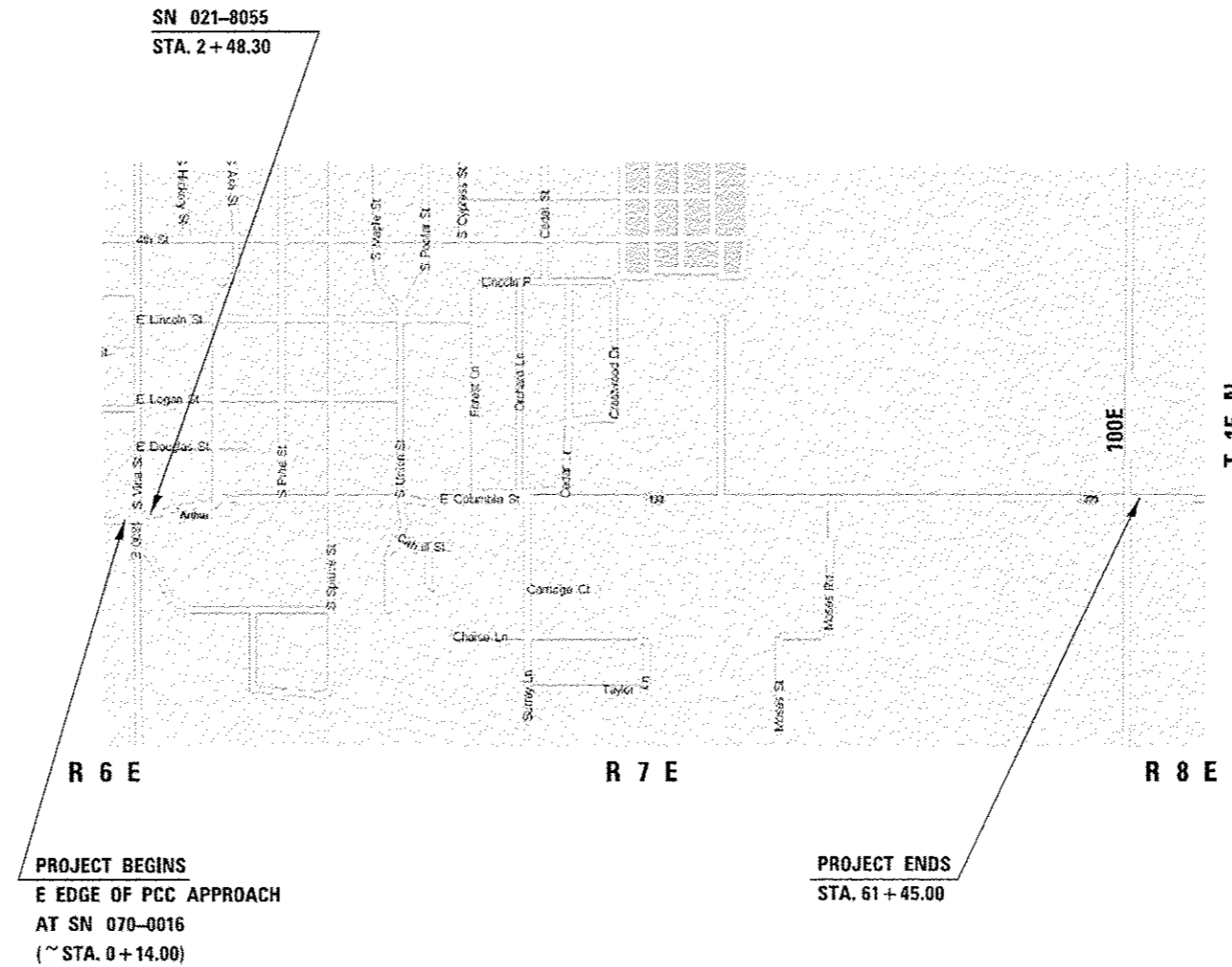

GROSS LENGTH = 6131.00 FT. = 1.161 MILE
 NET LENGTH = 6131.00 FT. = 1.161 MILE

FILE NAME =	USER NAME = eearlockjd	DESIGNED -	REVISED -	STATE OF ILLINOIS DEPARTMENT OF TRANSPORTATION	LOCATION MAP #4			F.A. RTE.	SECTION	COUNTY	TOTAL SHEETS	SHEET NO.	
c:\pwwork\pwwork\adot\eeearlockjd\0301332\0301332\70A32-shr-loc.mxd.dgn		DRAWN -	REVISED -		SCALE: N/A	SHEET 1	OF 1	SHEETS	STA.	TO STA.	VARIOUS	41	6
		CHECKED -	REVISED -										
		DATE -	REVISED -										
#MODELNAME#	PLOT DATE = 2/14/2014												

CONTRACT NO. 70A32
 ILLINOIS FED. AID PROJECT