

**ADT**

LOCATION 5: AVERAGE ADT = 3150 (2011)

**LOCATION MAP #5**  
**IL 16 FROM COLES CO. LINE TO IL 133 AT PARIS**  
**EDGAR CO.**

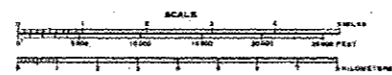
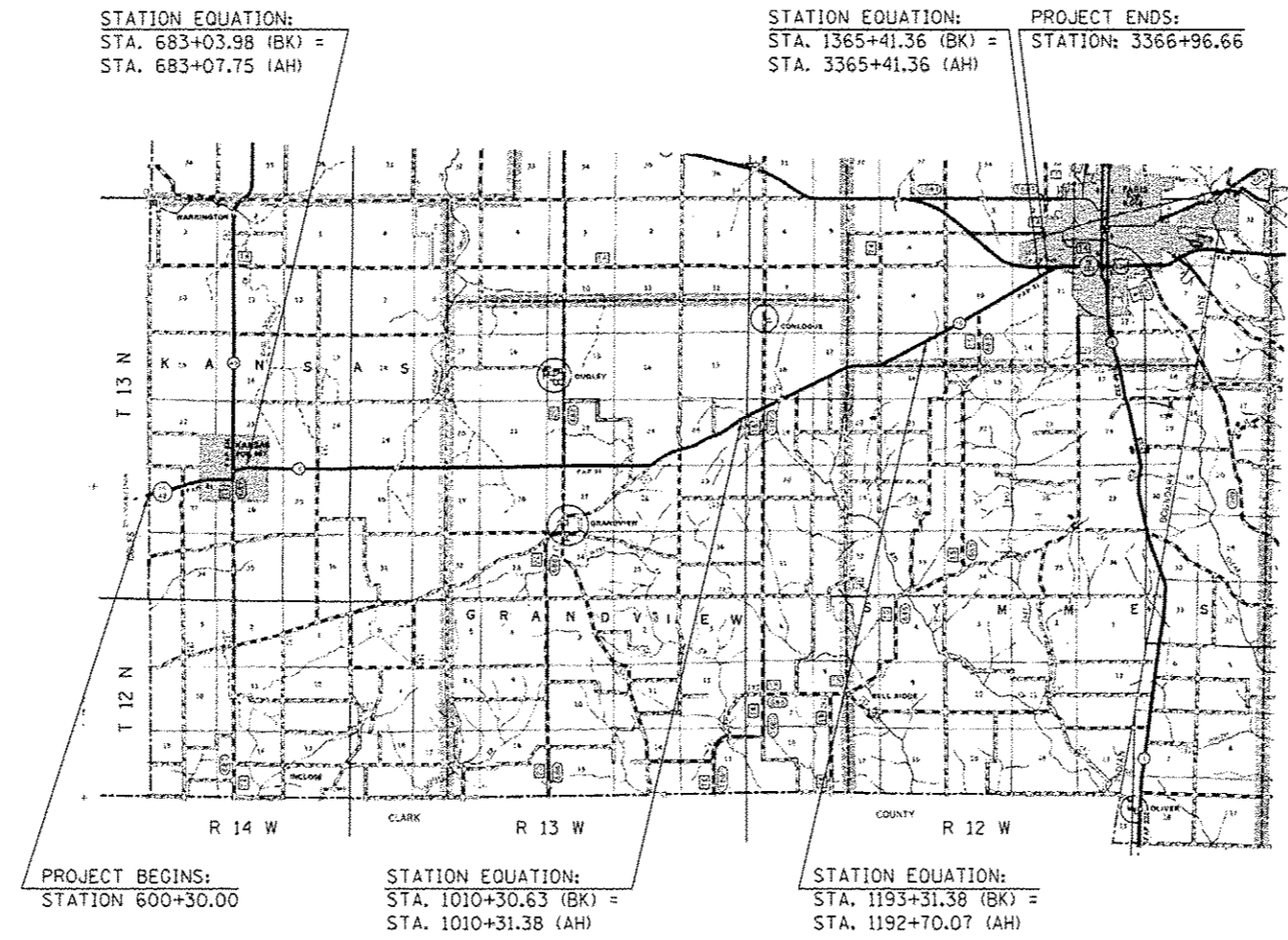

GROSS LENGTH = 76,723.45 FT. = 14.531 MILES  
 NET LENGTH = 76,723.45 FT. = 14.531 MILES

FILE NAME *	USER NAME = ceerlock_jd	DESIGNED -	REVISED -	<b>STATE OF ILLINOIS DEPARTMENT OF TRANSPORTATION</b>	<b>LOCATION MAP #5</b>		F.A. RTE.	SECTION	COUNTY	TOTAL SHEETS	SHEET NO.
78432-shr-loc maps.dgn	DRAWN -	REVISED -	VAR.				*	VARIOUS	41	7	
PLOT SCALE = 48.2880' / in.	CHECKED -	REVISED -	-D5 CRACK & JOINT SEAL 2014-1				CONTRACT NO. 70A32				
PLOT DATE = 2/14/2014	DATE -	REVISED -	ILLINOIS FED. AID PROJECT								
				SCALE: N/A		SHEET 1 OF 1 SHEETS		STA.	TO STA.		