

# ADT

## US 150 MITSUBISHI AVENUE FROM IL 9 NORTH TO I-74 MCLEAN COUNTY

LOCATION #4 FAP 676 (US 150)  
FROM IL -9 NORTH TO I-74  
LEG A LEG B  
AVERAGE ADT 6300 4350

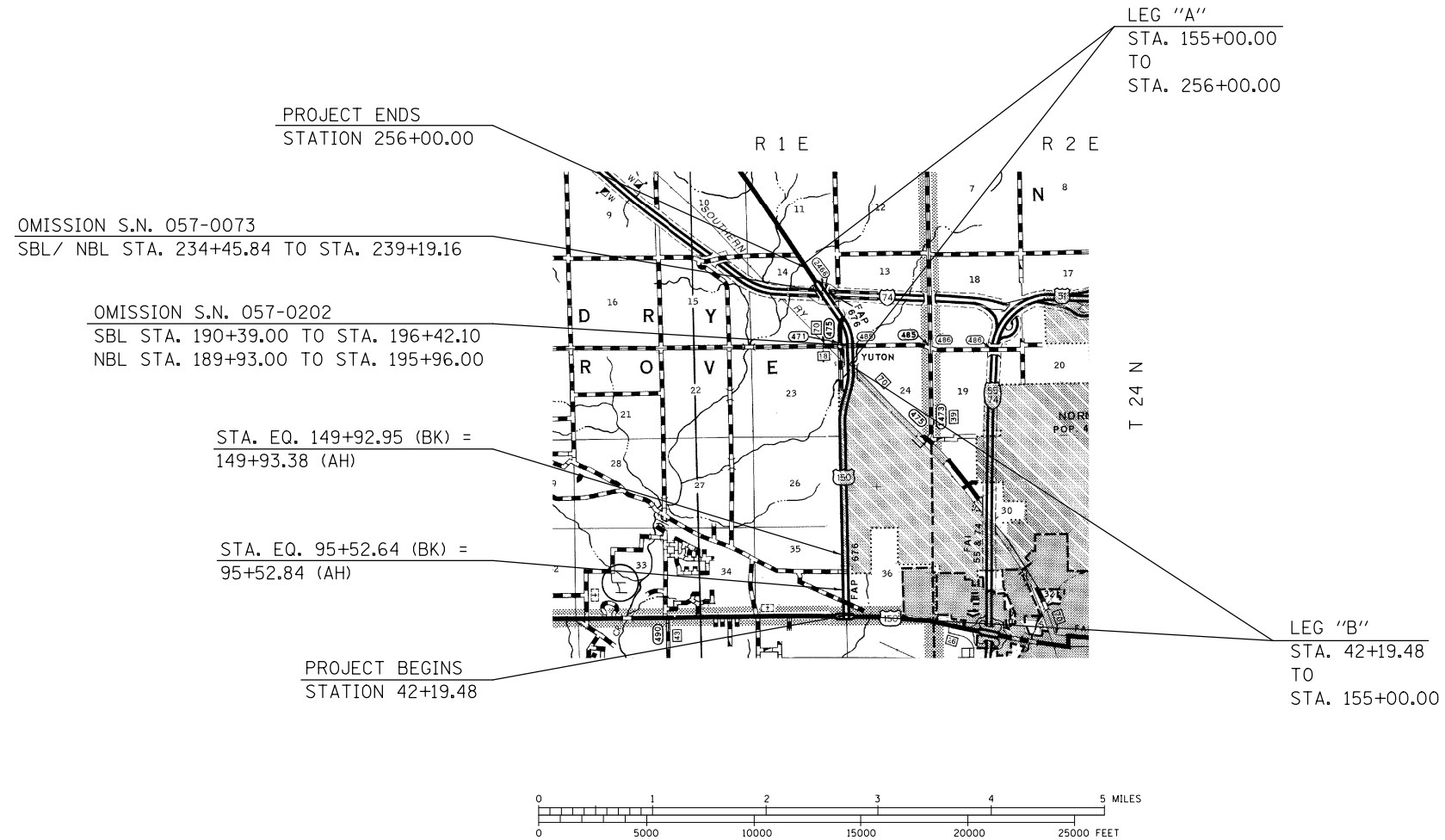

GROSS LENGTH = 21,379.89 FEET = 4.049 MILES  
NET LENGTH = 20,303.57 FEET = 3.845 MILES

FILE NAME =				USER NAME = ceorlockjd				DESIGNED -				REVISED -				STATE OF ILLINOIS DEPARTMENT OF TRANSPORTATION				LOCATION MAP #4				F.A. RTE.		SECTION		COUNTY		TOTAL SHEETS		SHEET NO.	
e:\pwork\pwork\ceorlockjd\0380704\0570A33-sht-loc maps.dgn				DRAWN -				REVISED -				VAR.		•										••		38		6					
PLOT SCALE = 40.0000' / in.				CHECKED -				REVISED -				•D5 CRACK & JOINT SEAL 2014-2		CONTRACT NO. 70A33																			
PLOT DATE = 2/14/2014				DATE -				REVISED -				SCALE: N/A		SHEET NO. 1 OF 1 SHEETS										STA. TO STA.		ILLINOIS FED. AID PROJECT							

\*\*MCLEAN & PIATT COUNTIES