

PLAN	SURVEYED	DATE
	PLOTTED	BY
	ALIGNMENT CHECKED	
	NOTE BOOK NO.	
	CARD FILE NAME	

PROFILE	SURVEYED	DATE
	PLOTTED	BY
	GRADES CHECKED	
	STRUCTURE NOTATIONS CHECKED	
	NOTE BOOK NO.	

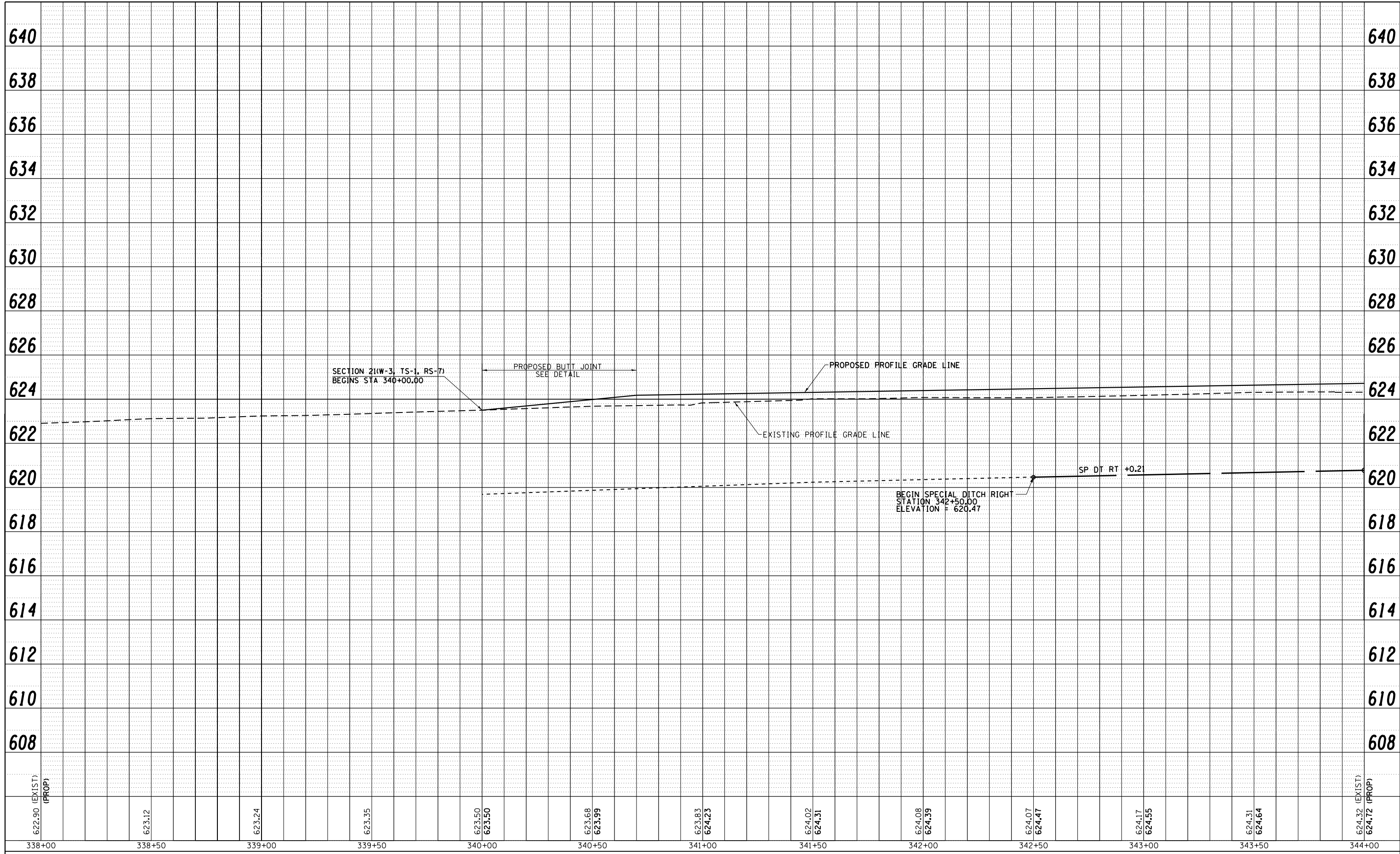

622.90 (EXIST) (PROP)	623.12	623.24	623.35	623.50 623.50	623.68 623.99	623.83 624.23	624.02 624.31	624.08 624.39	624.07 624.47	624.17 624.55	624.31 624.64	624.32 (EXIST) (PROP)	624.72 (PROP)
338+00	338+50	339+00	339+50	340+00	340+50	341+00	341+50	342+00	342+50	343+00	343+50	344+00	

FILE NAME = c:\pwork\pwork\sparks\0373645\0672890-sh:profile-Wabash03.dgn	USER NAME = sparks	DESIGNED -	REVISED -
PLOT SCALE = 40.0001' / in.	CHECKED -	REVISIED -	REVISIED -
PLOT DATE = Feb-04-2014 01:31:09PM	DATE - 12/04/2013	REVISIED -	REVISIED -

**STATE OF ILLINOIS
DEPARTMENT OF TRANSPORTATION**

**WABASH AVENUE
PROFILE SHEET**

SCALE: SHEET NO. OF SHEETS STA. 338+00.00 TO STA. 344+00.00

F.A.U. RTE.	SECTION	COUNTY	TOTAL SHEETS	SHEET NO.
8012	21(W-3, TS-1, RS-7)	SANGAMON	679	110
CONTRACT NO. 72890			ILLINOIS FED. AID PROJECT	