

QUANTITY	UNIT	ITEM
140	SQ FT	CONCRETE MEDIAN SURFACE, 4-INCH
1	EACH	SERVICE INSTALLATION, TYPE A
1277	FOOT	UNDERGROUND CONDUIT, PVC, 1 1/2" DIA.
44	FOOT	UNDERGROUND CONDUIT, PVC, 2" DIA.
180	FOOT	UNDERGROUND CONDUIT, PVC, 2 1/2" DIA.
228	FOOT	UNDERGROUND CONDUIT, PVC, 3"
8	FOOT	UNDERGROUND CONDUIT, PVC, 4"
5	EACH	HANDHOLE
1	EACH	DOUBLE HANDHOLE
3	EACH	GULFBOX JUNCTION, COMPOSITE CONCRETE
1	EACH	FULL-ACTUATED CONTROLLER AND TYPE V CABINET
1	EACH	UNINTERRUPTIBLE POWER SUPPLY, STANDARD
1	EACH	TRANSCIEVER - FIBER OPTIC
1284	FOOT	FIBER OPTIC CABLE IN CONDUIT, NO. 62.5/125, MM12F SM12F
1261	FOOT	ELECTRIC CABLE IN CONDUIT, SIGNAL, NO. 145C
695	FOOT	ELECTRIC CABLE IN CONDUIT, SIGNAL, NO. 147C
92	FOOT	ELECTRIC CABLE IN CONDUIT, SIGNAL, NO. 149C
593	FOOT	ELECTRIC CABLE IN CONDUIT, SIGNAL, NO. 18, 3C
270	FOOT	ELECTRIC CABLE IN CONDUIT, 600V (XLP-TYPE USE) 3-1/CNO. 10
2	EACH	LUMINAIRE, SODIUM VAPOR, HORIZONTAL MOUNT, PHOTO CELL CONTROL, 400 WA

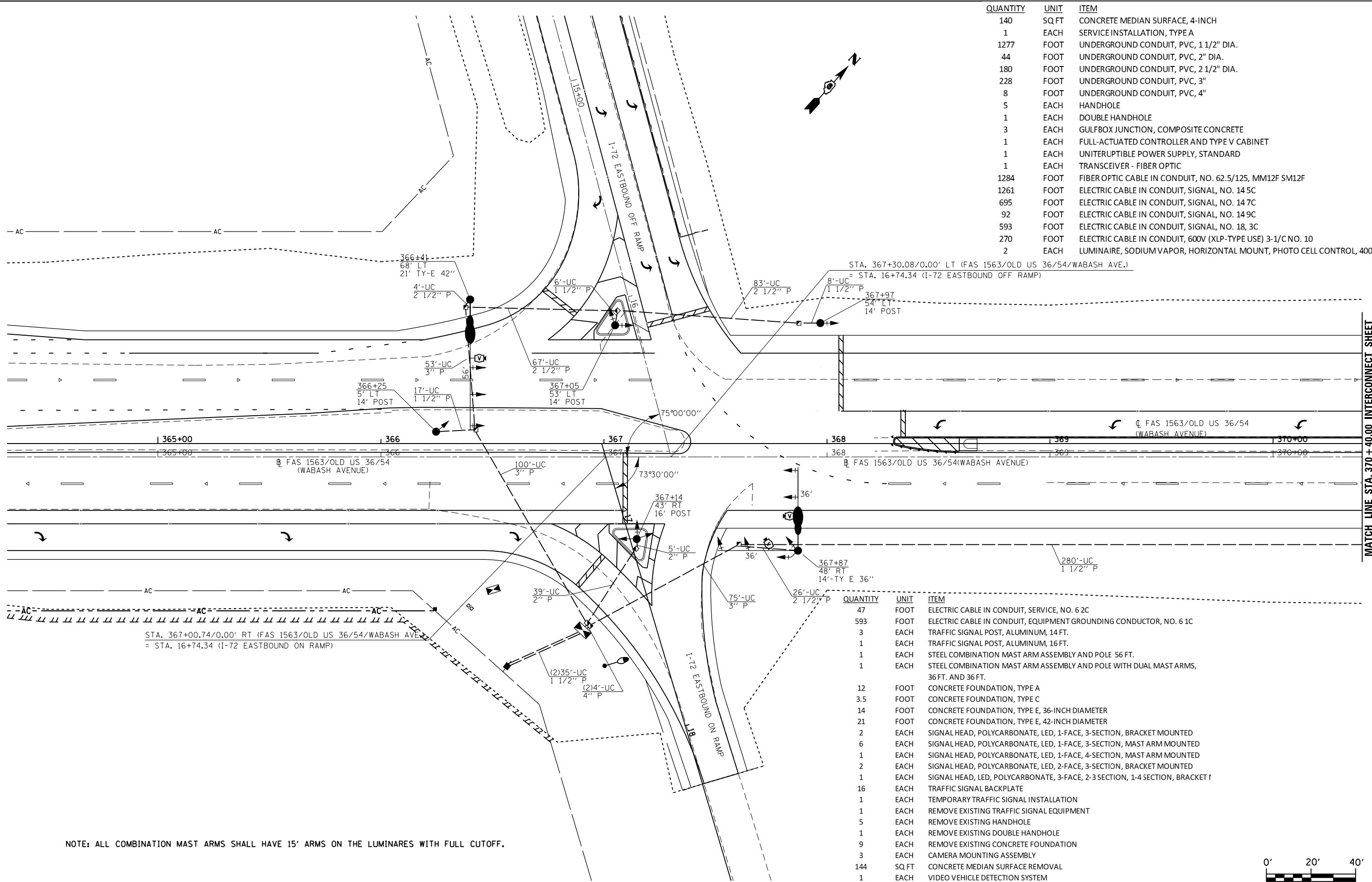

QUANTITY	UNIT	ITEM
47	FOOT	ELECTRIC CABLE IN CONDUIT, SERVICE, NO. 6 2C
593	FOOT	ELECTRIC CABLE IN CONDUIT, EQUIPMENT GROUNDING CONDUCTOR, NO. 6 1C
3	EACH	TRAFFIC SIGNAL POST, ALUMINUM, 14 FT.
1	EACH	TRAFFIC SIGNAL POST, ALUMINUM, 16 FT.
1	EACH	STEEL COMBINATION MAST ARM ASSEMBLY AND POLE 56 FT.
1	EACH	STEEL COMBINATION MAST ARM ASSEMBLY AND POLE WITH DUAL MAST ARMS, 36 FT. AND 36 FT.
12	FOOT	CONCRETE FOUNDATION, TYPE A
3.5	FOOT	CONCRETE FOUNDATION, TYPE C
14	FOOT	CONCRETE FOUNDATION, TYPE E, 36-INCH DIAMETER
21	FOOT	CONCRETE FOUNDATION, TYPE E, 42-INCH DIAMETER
2	EACH	SIGNAL HEAD, POLYCARBONATE, LED, 1-FACE, 3-SECTION, BRACKET MOUNTED
6	EACH	SIGNAL HEAD, POLYCARBONATE, LED, 1-FACE, 3-SECTION, MAST ARM MOUNTED
1	EACH	SIGNAL HEAD, POLYCARBONATE, LED, 1-FACE, 4-SECTION, MAST ARM MOUNTED
2	EACH	SIGNAL HEAD, POLYCARBONATE, LED, 2-FACE, 3-SECTION, BRACKET MOUNTED
1	EACH	SIGNAL HEAD, LED, POLYCARBONATE, 3-FACE, 2-3 SECTION, 1-4 SECTION, BRACKET
16	EACH	TRAFFIC SIGNAL BACKPLATE
1	EACH	TEMPORARY TRAFFIC SIGNAL INSTALLATION
1	EACH	REMOVE EXISTING TRAFFIC SIGNAL EQUIPMENT
5	EACH	REMOVE EXISTING HANDHOLE
1	EACH	REMOVE EXISTING DOUBLE HANDHOLE
9	EACH	REMOVE EXISTING CONCRETE FOUNDATION
3	EACH	CAMERA MOUNTING ASSEMBLY
144	SQ FT	CONCRETE MEDIAN SURFACE REMOVAL
1	EACH	VIDEO VEHICLE DETECTION SYSTEM
1	EACH	RELOCATE EXISTING MASTER CONTROLLER

NOTE: ALL COMBINATION MAST ARMS SHALL HAVE 15' ARMS ON THE LUMINAIRES WITH FULL CUTOFF.

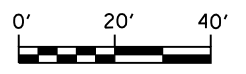

USER NAME = sparksgw	DESIGNED -	REVISED - WCD 10/17/2013
	DRAWN - BDM	REVISED -
PLOT SCALE = 40.0000' / in.	CHECKED - JSA	REVISED -
PLOT DATE = Feb-04-2014 01:44:34PM	DATE - 7/15/09	REVISED -

**STATE OF ILLINOIS
DEPARTMENT OF TRANSPORTATION**

**PROPOSED TRAFFIC SIGNAL PLAN
WABASH AVE. & I-72 WEST INTERSECTION**

SCALE: SHEET NO. 4 OF 37 SHEETS STA. TO STA.

F.A.U. RTE.	SECTION	COUNTY	TOTAL SHEETS	SHEET NO.
8012	21(W-3, TS-1, RS-7)	SANGAMON	679	339
CONTRACT NO. 72890				
ILLINOIS FED. AID PROJECT				