

**GENERAL NOTES**

All reinforcement bars shall be epoxy coated.

Minimum clearance to reinforcing steel shall be 1 1/2" unless otherwise shown.

Plan dimensions and details relative to existing plans are subject to nominal construction variations. The Contractor shall field verify existing dimensions and details affecting new construction and make necessary approved adjustments prior to construction or ordering of materials. Such variations shall not be cause for additional compensation for a change in scope of the work, however, the Contractor will be paid for the quantity actually furnished at the unit price bid for the work.

All construction joints shall be bonded.

All soldier piles shall be HP10X42 and shall be 13'-0" long.

All exposed edges of CIP concrete facing shall be chamfered 3/4".

**TOTAL BILL OF MATERIAL**

ITEM	UNIT	TOTAL
Slope Wall Removal	Sq. Yd.	1,270
Structure Excavation	Cu. Yd.	505
Concrete Structures	Cu. Yd.	166.9
Stud Shear Connectors	Each	850
Reinforcement Bars, Epoxy Coated	Pound	27,250
Slope Wall 4"	Sq. Yd.	217
Geocomposite Wall Drain	Sq. Yd.	275
Drilling & Setting Soldier Piles (in Soil)	Cu. Ft.	3,872.0
Untreated Timber Lagging	Sq. Ft.	3,225
Furnishing Soldier Piles (HP Section)	Foot	1,105
Pipe Underdrains for Structures, 4"	Foot	760

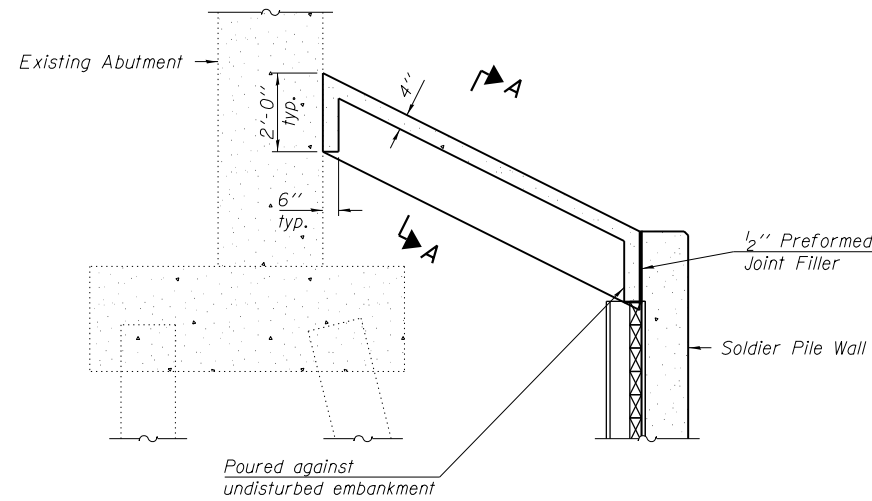

**SECTION THRU CONCRETE SLOPEWALL**

Notes:  
Match slope of existing slope wall.  
Form toewall of slope wall around soldier pile or timber lagging as necessary.

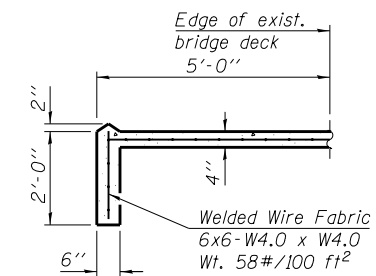

**SECTION A - A**

DESIGNED	NJM
CHECKED	KPH
DRAWN	NJM
CHECKED	KPH

**GENERAL NOTES AND  
TOTAL BILL OF MATERIAL  
EAST AND WEST RETAINING WALLS  
WABASH AVE. AT I-72  
F.A.P. ROUTE 8012 -  
SECTION 21W-3, TS-1, RS-7)  
SANGAMON COUNTY**