

DATE	
BY	
FINAL SURVEY	SURVEYED
NOTE BOOK	PLOTTED
NO.	TEMPLATE
	AREAS CHECKED

DATE	
BY	
ORIGINAL SURVEY	SURVEYED
NOTE BOOK	PLOTTED
NO.	TEMPLATE
	AREAS CHECKED

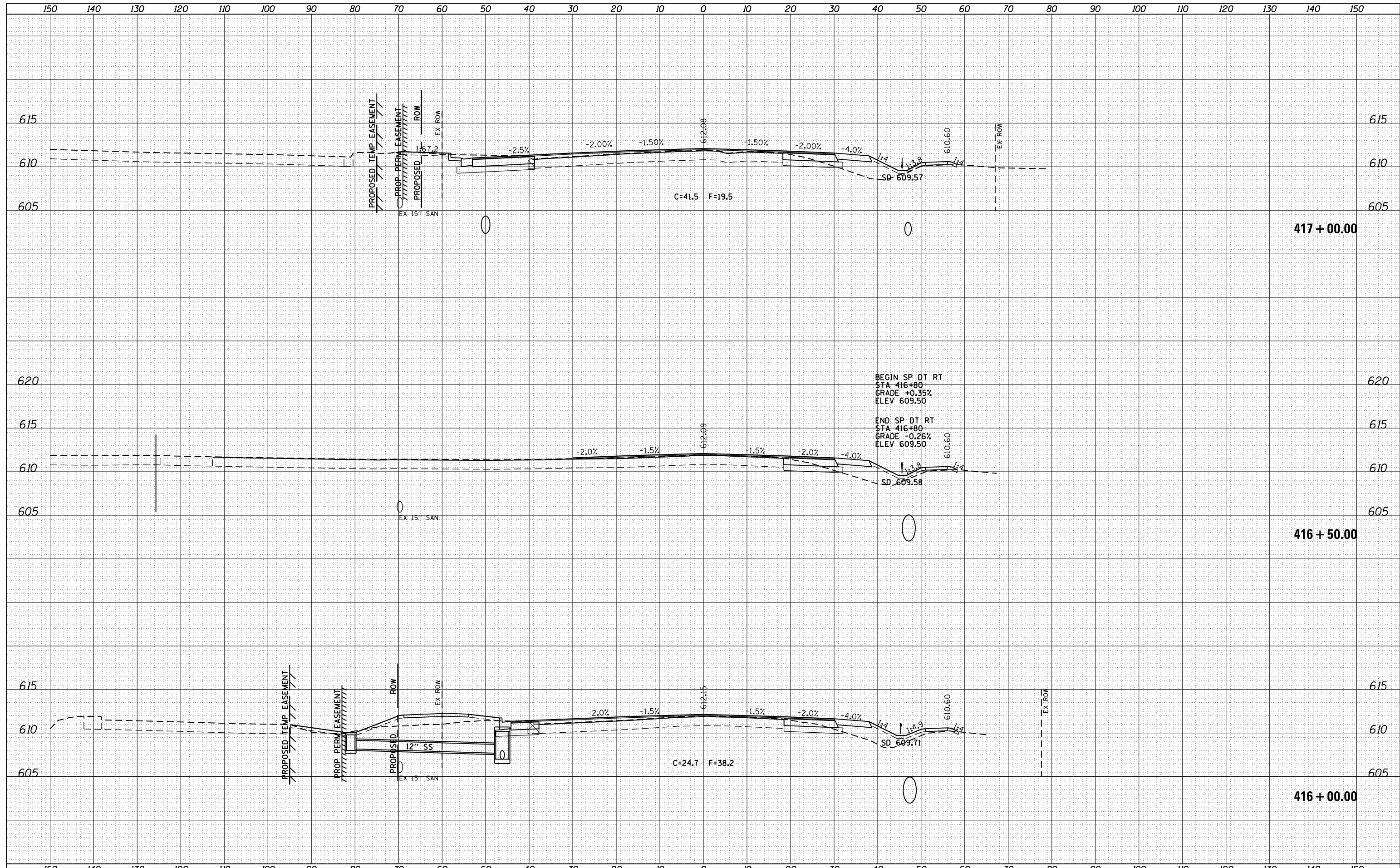

FILE NAME =	USER NAME = sparksgw	DESIGNED - AWM	REVISED -	STATE OF ILLINOIS DEPARTMENT OF TRANSPORTATION	WABASH AVENUE CROSS SECTIONS	F.A.U. RTE.	SECTION	COUNTY	TOTAL SHEETS	SHEET NO.
c:\pw\work\p1dot\sparksgw\0373645\0672890-sh	DESIGNED - TJD	REVISED -	8012			21(W-3, TS-1, RS-7)	SANGAMON	679	527	
Default	CHECKED - AWM	REVISED -	CONTRACT NO. 72890							
	DATE - 12/04/2013	REVISED -	ILLINOIS FED. AID PROJECT							

SCALE: 1"=10'H, 5'V SHEET 57 OF 124 SHEETS STA. 416+00.00 TO STA. 417+00.00