

DATE	
BY	
FINAL SURVEY	SURVEYED
NOTE BOOK	PLOTTED
NO.	TEMPLATE
	AREAS CHECKED

DATE	
BY	
ORIGINAL SURVEY	SURVEYED
NOTE BOOK	PLOTTED
NO.	TEMPLATE
	AREAS CHECKED

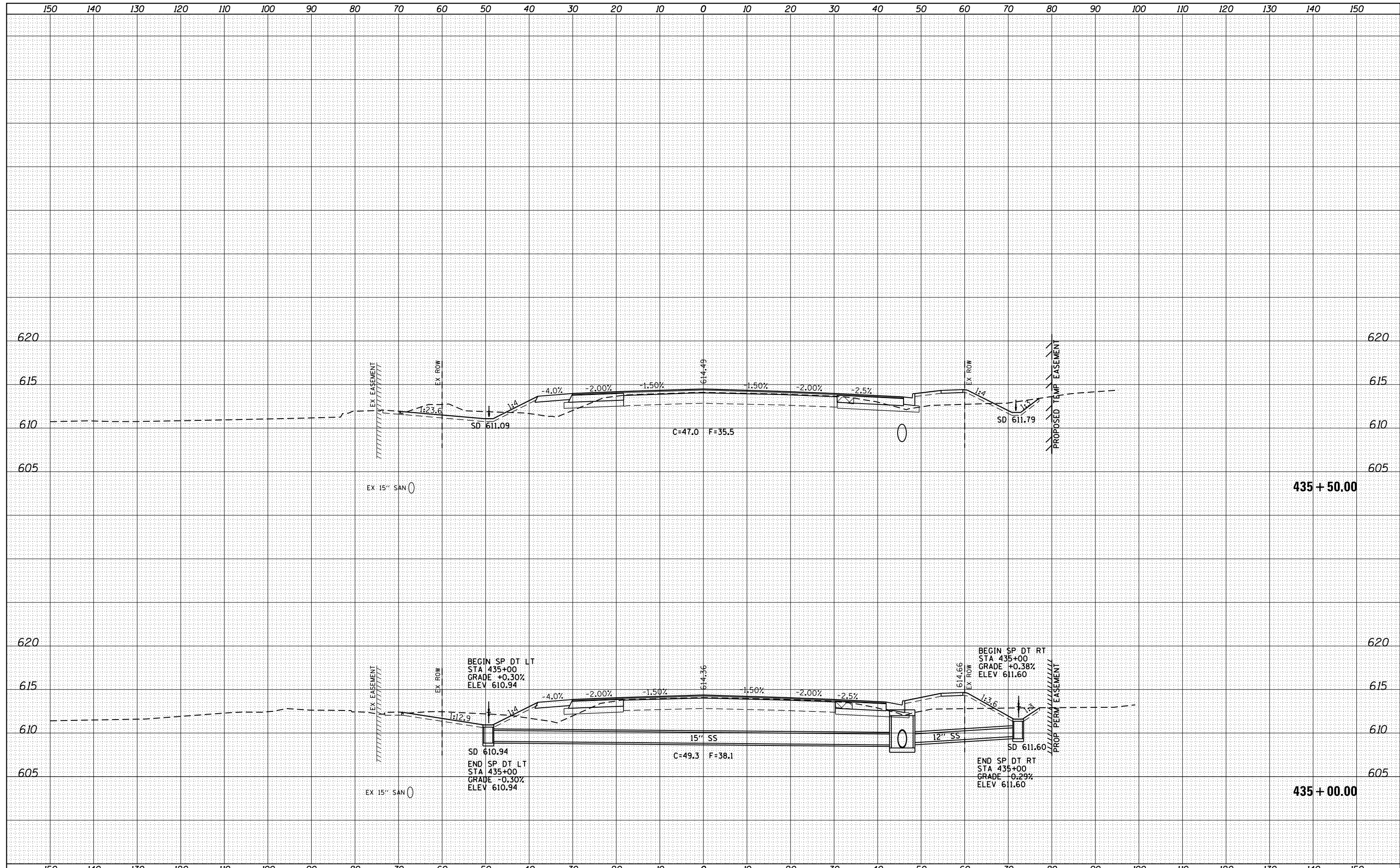

FILE NAME =	USER NAME = sparksgw	DESIGNED - AWM	REVISED -	STATE OF ILLINOIS DEPARTMENT OF TRANSPORTATION	WABASH AVENUE CROSS SECTIONS	F.A.U. RTE.	SECTION	COUNTY	TOTAL SHEETS	SHEET NO.	
Default	es:\pw\work\p\dot\sparksgw\ad0373645\0672890-shd-xssht-Wabash.dgn	DRAWN - TJD	REVISED -			8012	21(W-3, TS-1, RS-7)	SANGAMON	679	542	
	PLOT SCALE = 20.0000' / in.	CHECKED - AWM	REVISED -			CONTRACT NO. 72890					
	PLOT DATE = Feb-04-2014 01:52:18PM	DATE - 12/04/2013	REVISED -			ILLINOIS FED. AID PROJECT					

SCALE: 1"=10'H, 5'V SHEET 72 OF 124 SHEETS STA. 435+00.00 TO STA. 435+50.00