

CROSSWALK LOCATION

LOCATION	MARKED ROUTE(S)	COMMON NAME(S)	ORIENTATION	CROSS ROAD(S)	COMMON NAME(S)	CROSSWALK(S)
084-05	FAP 75	IL 29/ILLINOIS ST.	E-W	MUN 4999	TAFT DR.	BIKE PATH

SIGNING SCHEDULE PER LOCATION

LOCATION	SIGN PANEL - TYPE 1						
	S1-1	W11-1	W11-2	W16-7P(L)	W16-7P(R)	W16-9P	RS PANEL
084-05		8		2	2	4	8

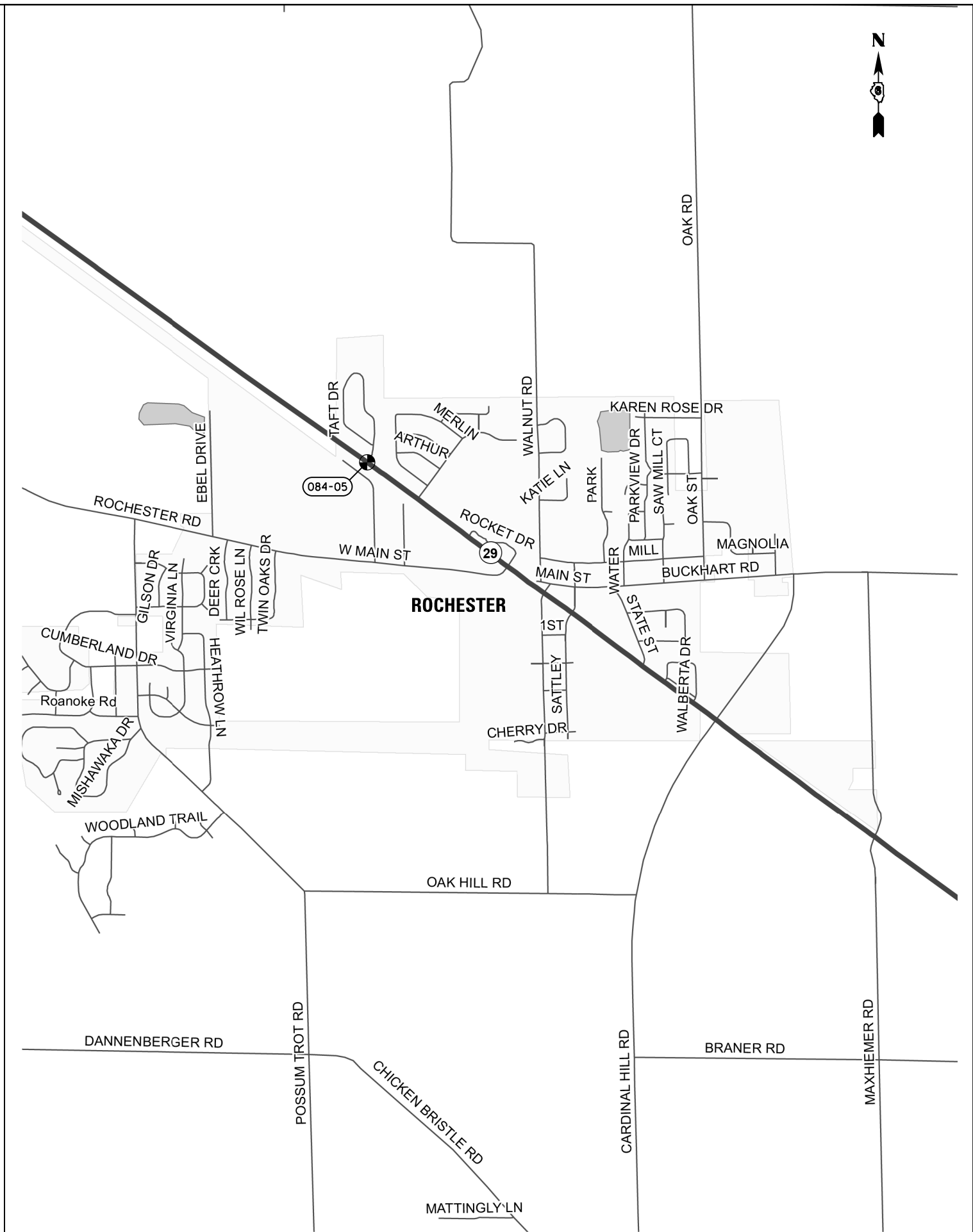

FILE NAME =	USER NAME = sparksgw	DESIGNED -	REVISED -
c:\pwork\pwork\sparksgw\0360886\0672076-sht-Location Maps-Sangamon.dgn		DRAWN -	REVISED -
Default	PLOT SCALE = 100.0000' / in.	CHECKED -	REVISED -
	PLOT DATE = Feb-04-2014 03:55:28PM	DATE -	REVISED -

**STATE OF ILLINOIS
DEPARTMENT OF TRANSPORTATION**

**LOCATION MAP
VILLAGE OF ROCHESTER - SANGAMON COUNTY**

SCALE: SHEET OF SHEETS STA. TO STA.

F.A. RTE.	SECTION	COUNTY	TOTAL SHEETS	SHEET NO.
			58	53
CONTRACT NO. 72G76			ILLINOIS FED. AID PROJECT	